

Body Accessory Trim Package Installation

Installation Instructions Part Number

23278545

Kit Contents

Qty	Description
1	Accessory Lower Fascia
1	Extension Panel
1	Splitter End – Left
1	Splitter End – Right
1	Rocker Molding – Left
1	Rocker Molding – Right
1	Rear Valance Panel
1	Valance Cap – Left
1	Valance Cap – Right
1	Hardware Bag
1	Paper Template
1	Installation Instructions

Tools Required

Drill, 13/64" (5 mm) Drill Bit, 5/16" (8 mm) Drill Bit, and Rivet tool

Note:

- Carefully read and understand instructions and components completely before beginning installation.
- Wash/clean fascias and rockers before ground effects installation.
- **CAUTION:** Ground Effects reduces the vehicle's ground clearance. Enter driveways, bumps and ramps with care.

Procedure

Front Splitter

1. Raise and suitably support the vehicle. Refer to Vehicle Service Manual.

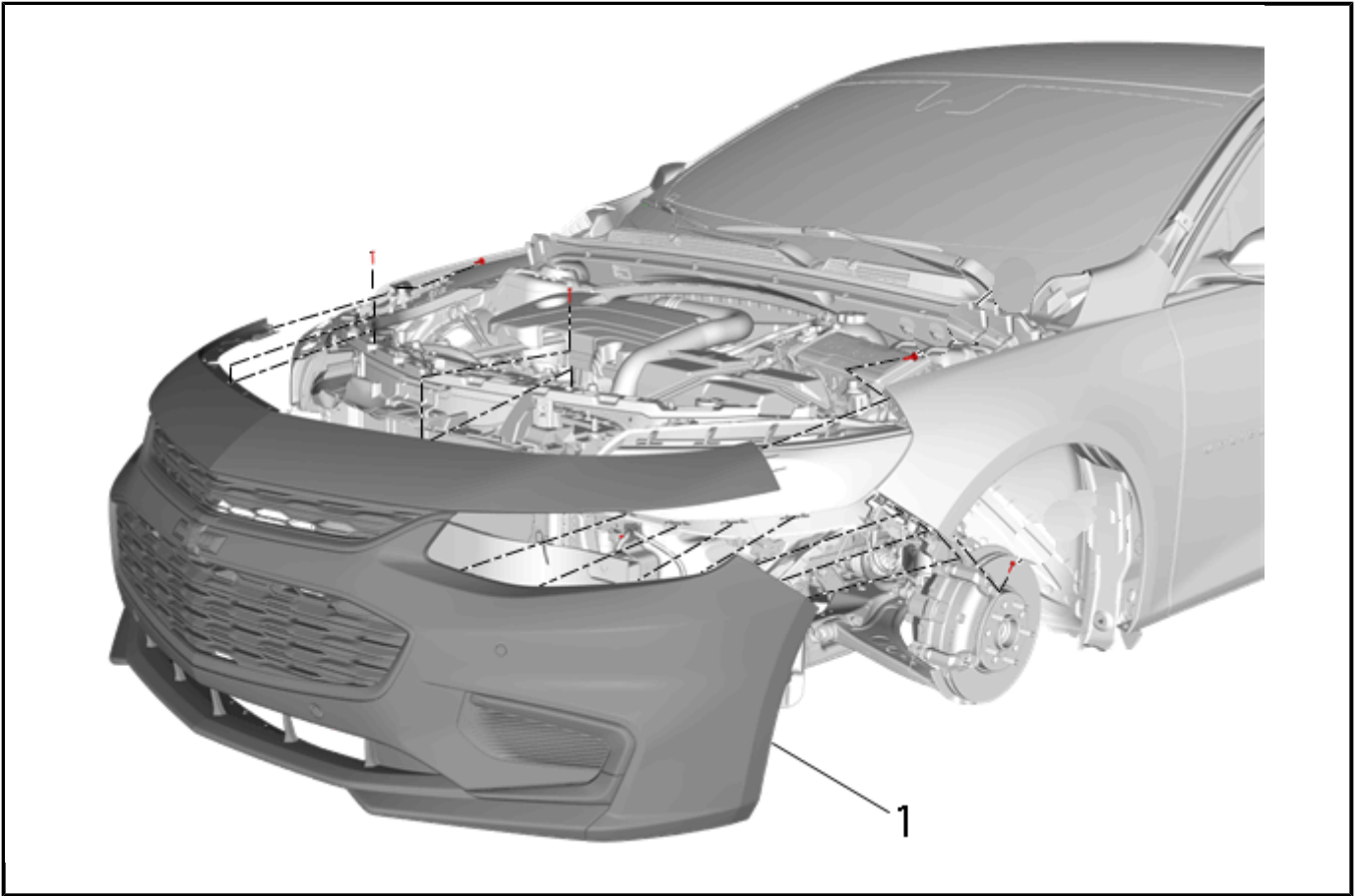

4477273

2. Remove the front bumper fascia (1) from vehicle. Refer to Vehicle Service Manual.
3. Place front bumper fascia on a protected work surface that will not scratch or damage parts.

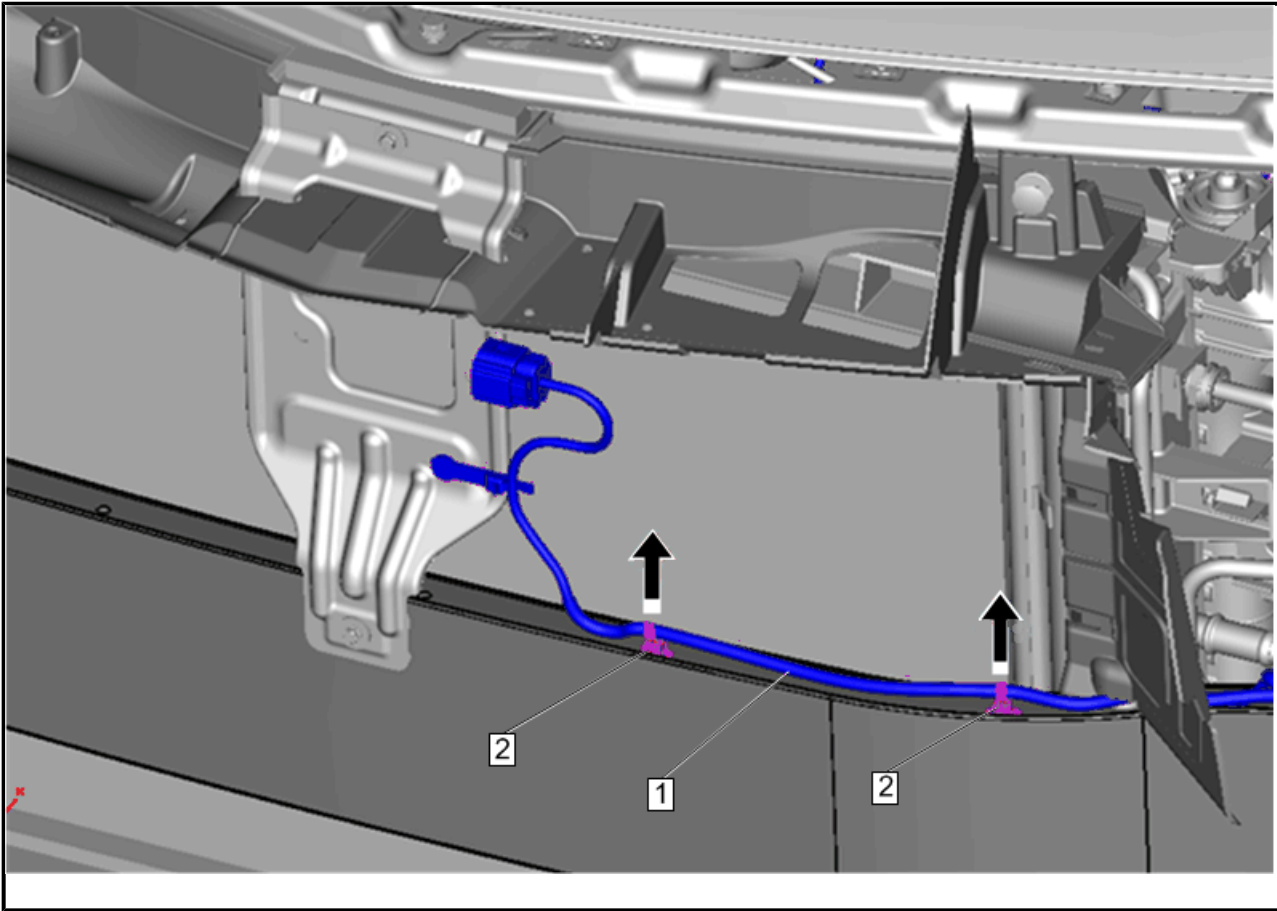

4640232

4. On the front of the vehicle, if there is a wiring harness (1) attached to the bumper beam, carefully pull the clips (2) from the front beam. Carefully remove the clips from the harness. The harness will be re-secured in a later step.

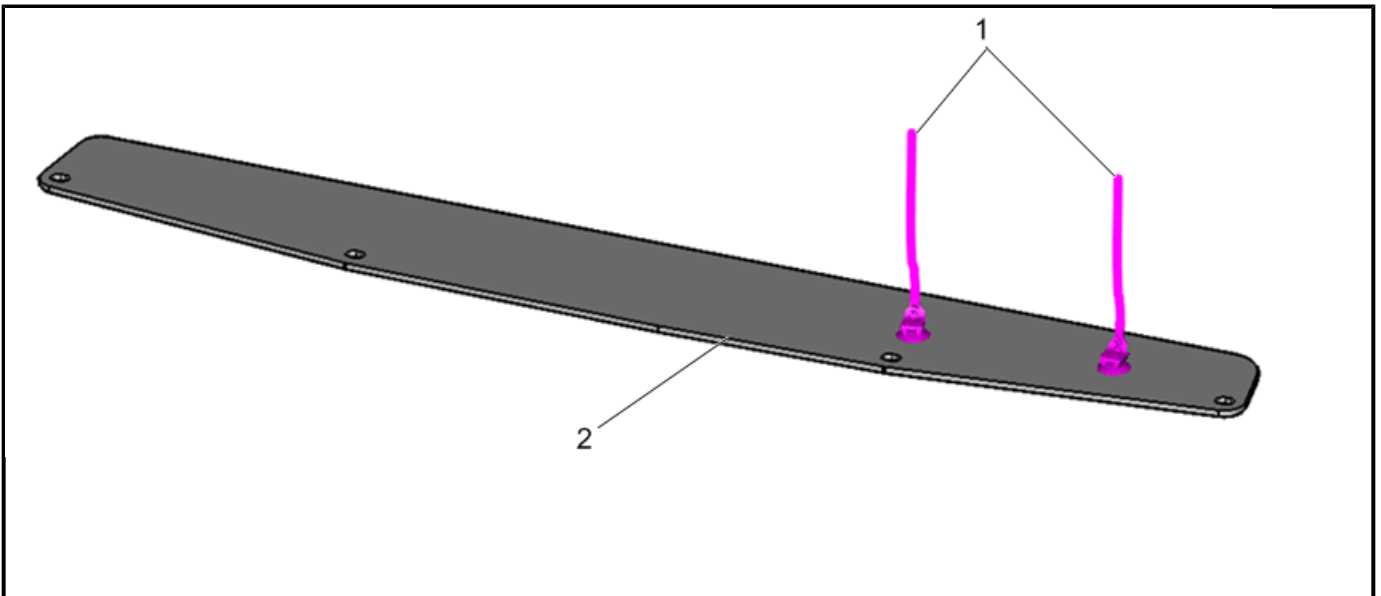

4640233

5. Install 2 included zip-ties (2) into the plastic deflector (1).

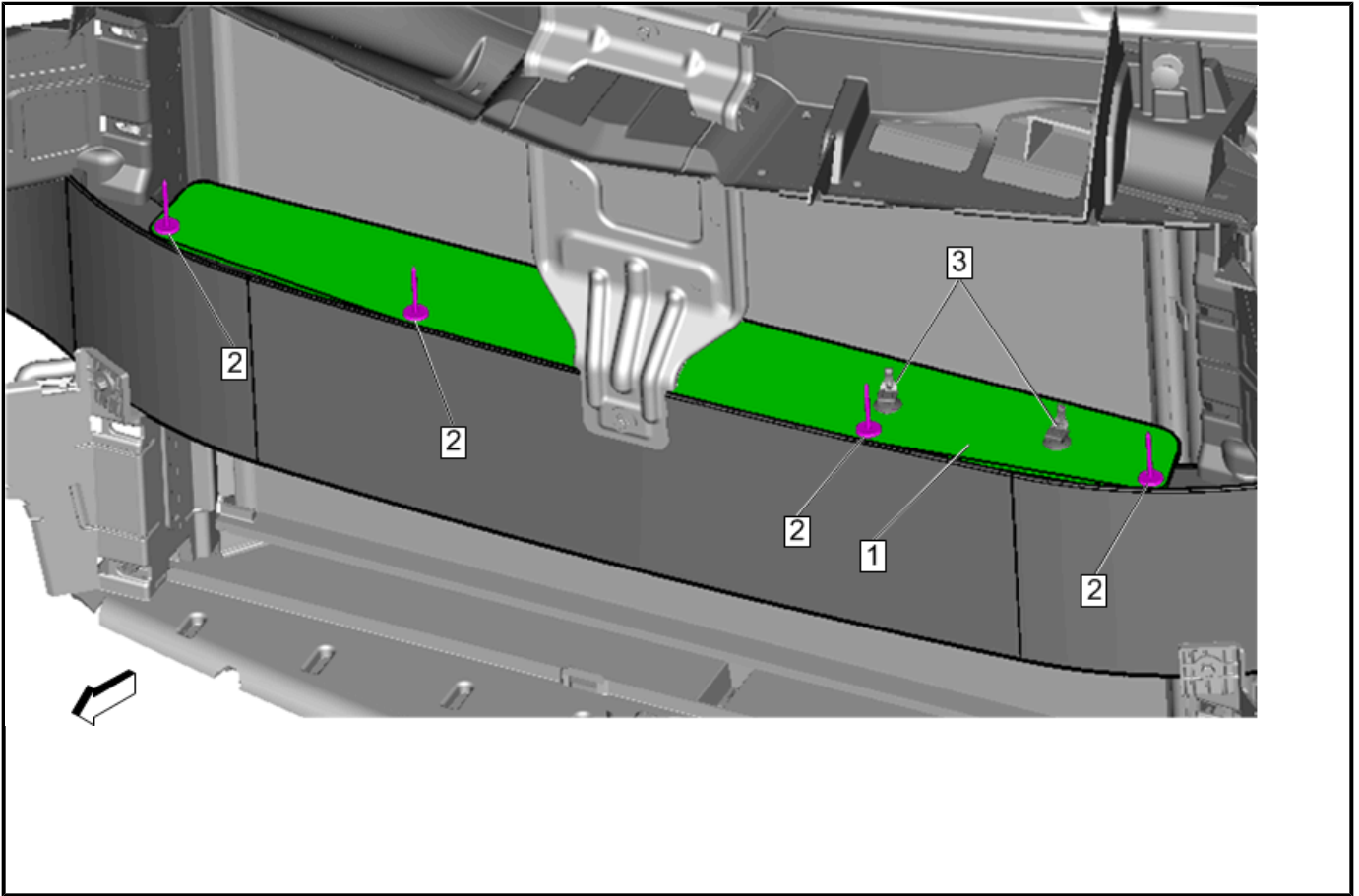

4640235

6. Install the plastic deflector (1) onto the front bumper beam by fastening 4 rivets (2) into holes in the beam. The new zip-ties (3) should be on the top of the deflector and on the driver side.
7. Fasten the new zip-ties (3) around the previous wiring harness to secure it in place. Trim off any excess length of zip-tie.
8. Make sure the front fascia is at room temperature.

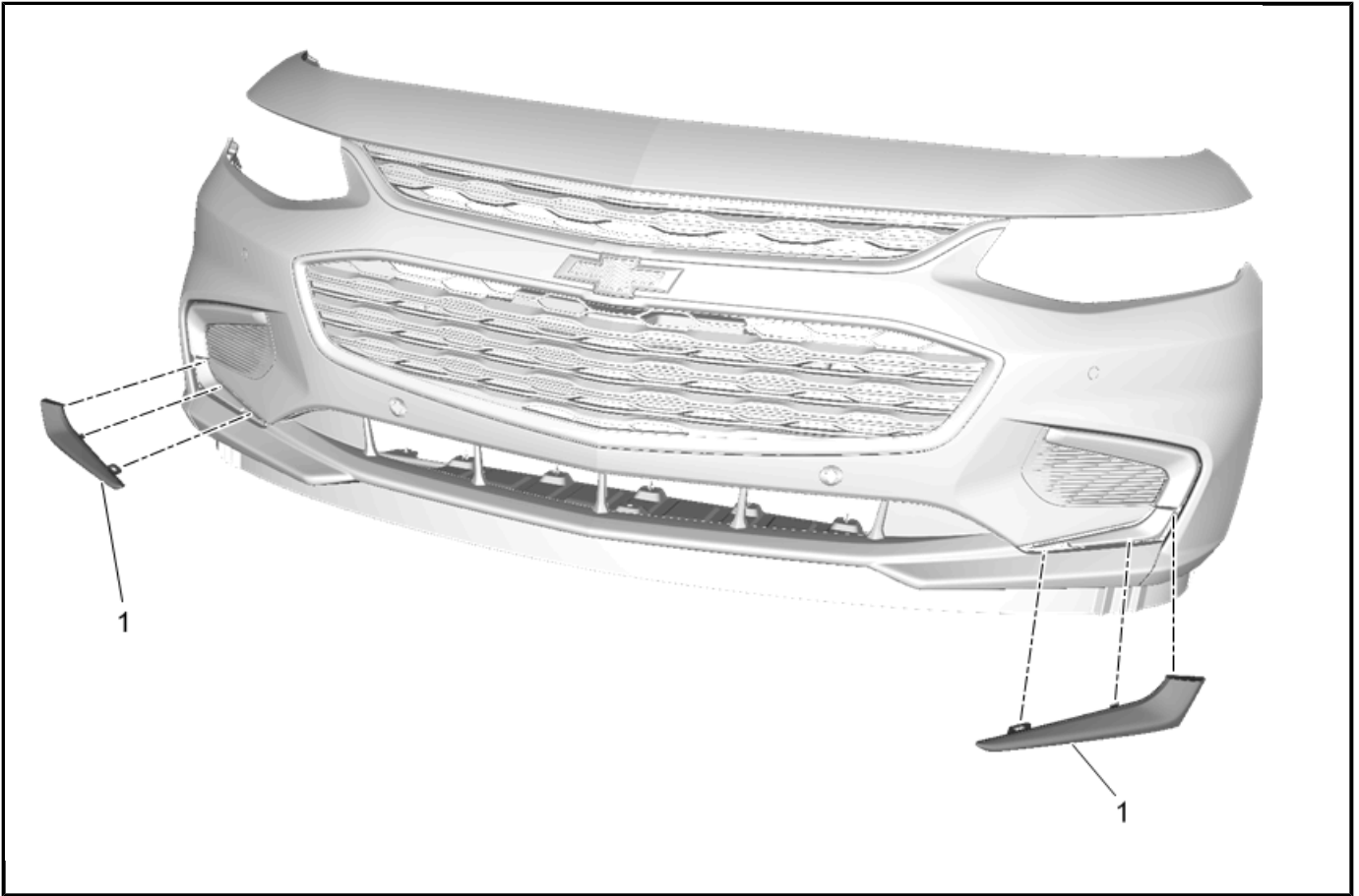

4477298

9. Using a suitable plastic flat bladed tool, disengage the tabs and the plastic clips to remove the left and right front fascia inserts (1).

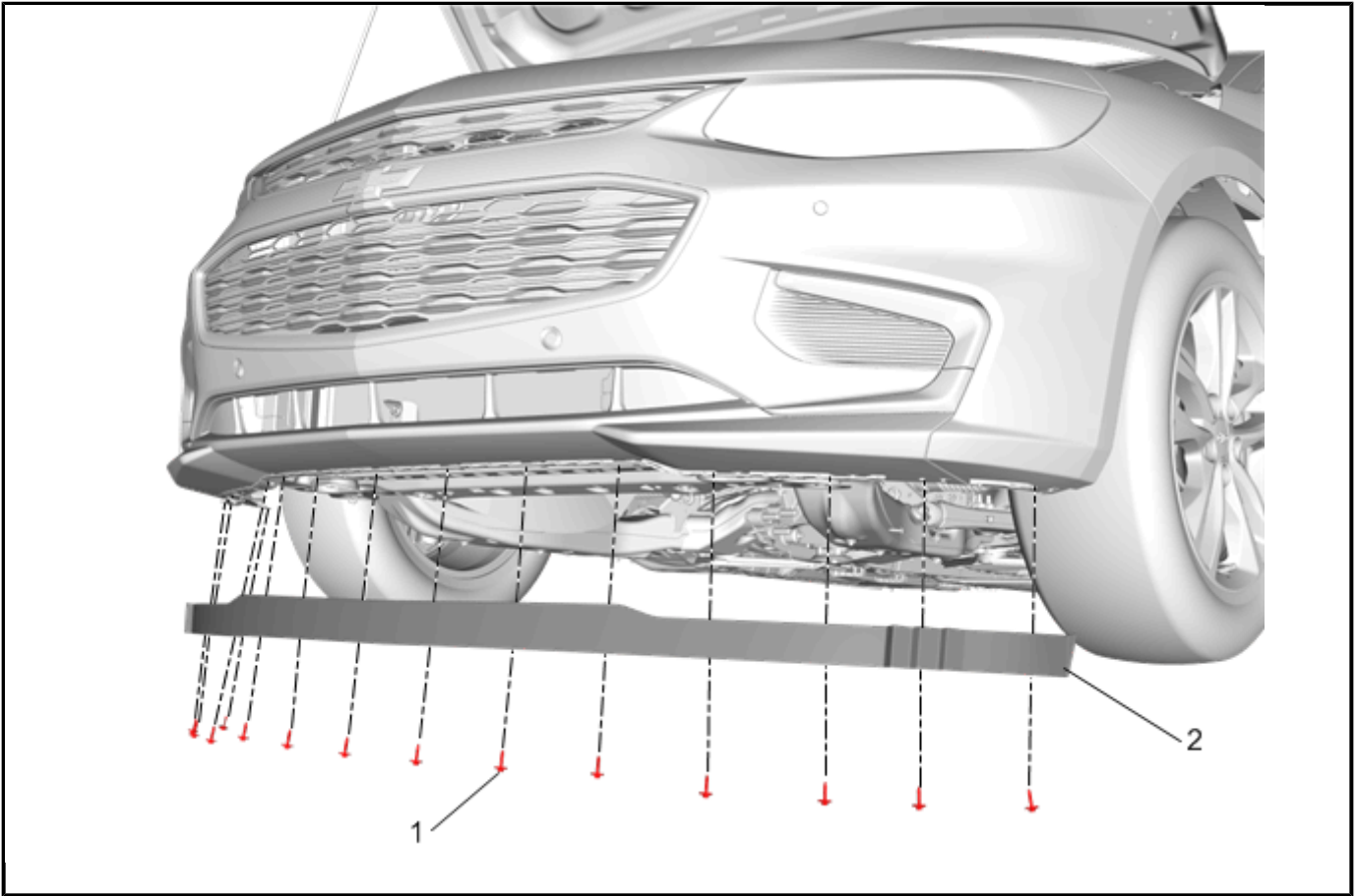

4215719

10. Remove and retain the front bumper fascia center air deflector bolts (1) Qty:14.
11. Remove the front bumper fascia center air deflector (2).

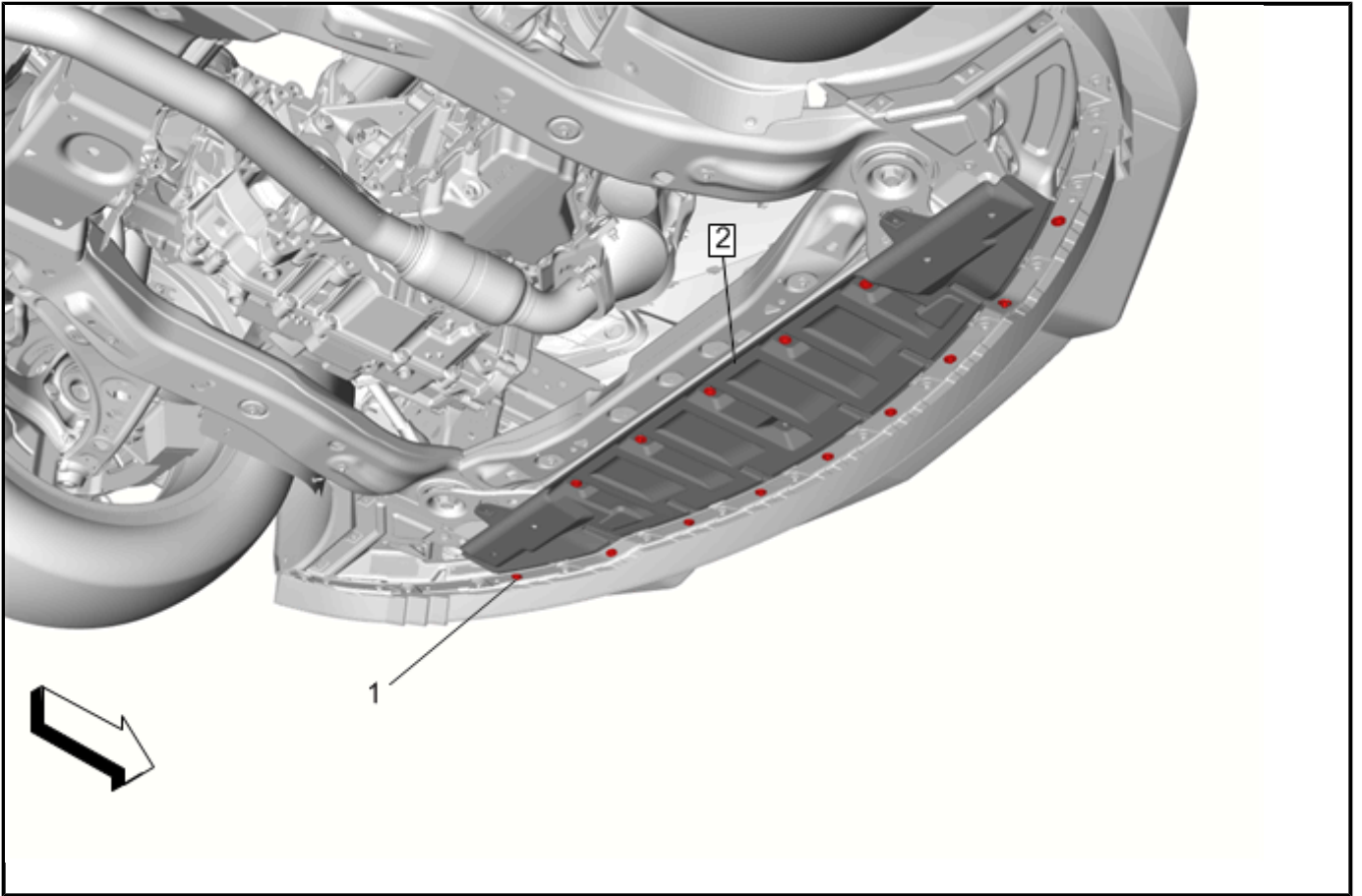

4232055

12. Remove the underbody front air deflector (2) from the lower fascia.

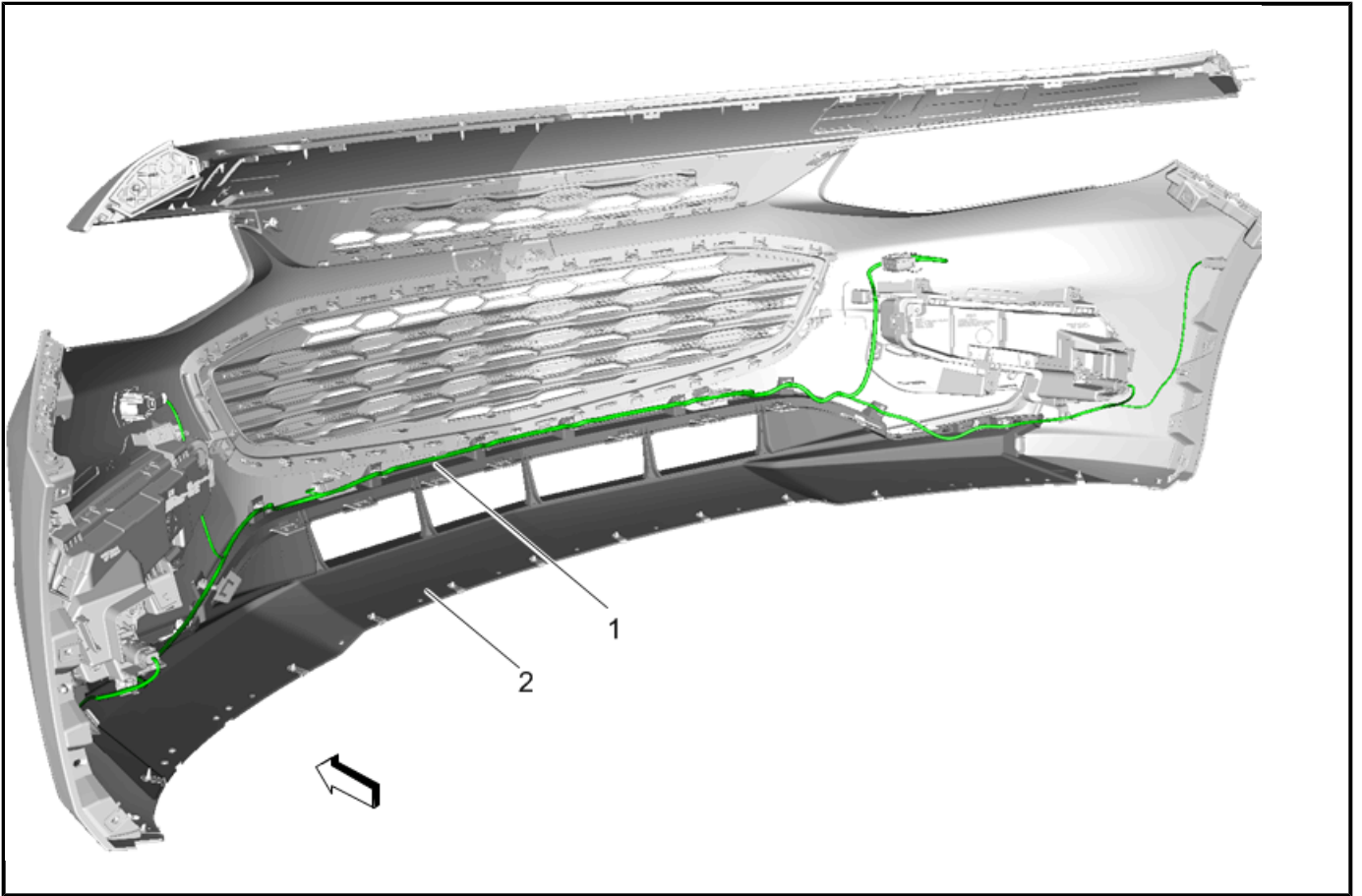

4477288

13. Disconnect the fascia harness (1) from just the lower fascia (2).

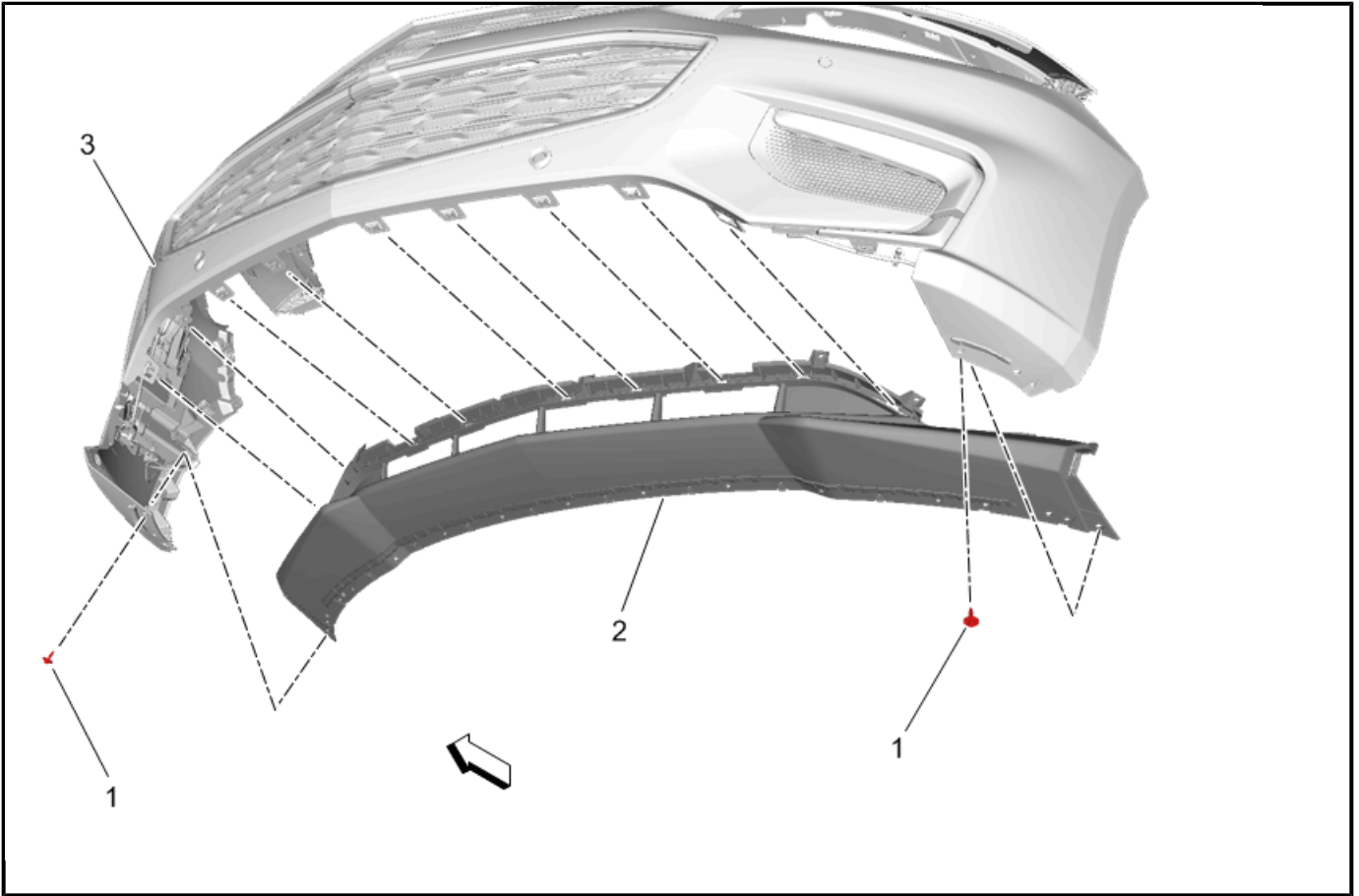

4477295

14. Remove the two screws (1), disengage the retainers and remove the lower fascia (2) from the upper fascia (3).

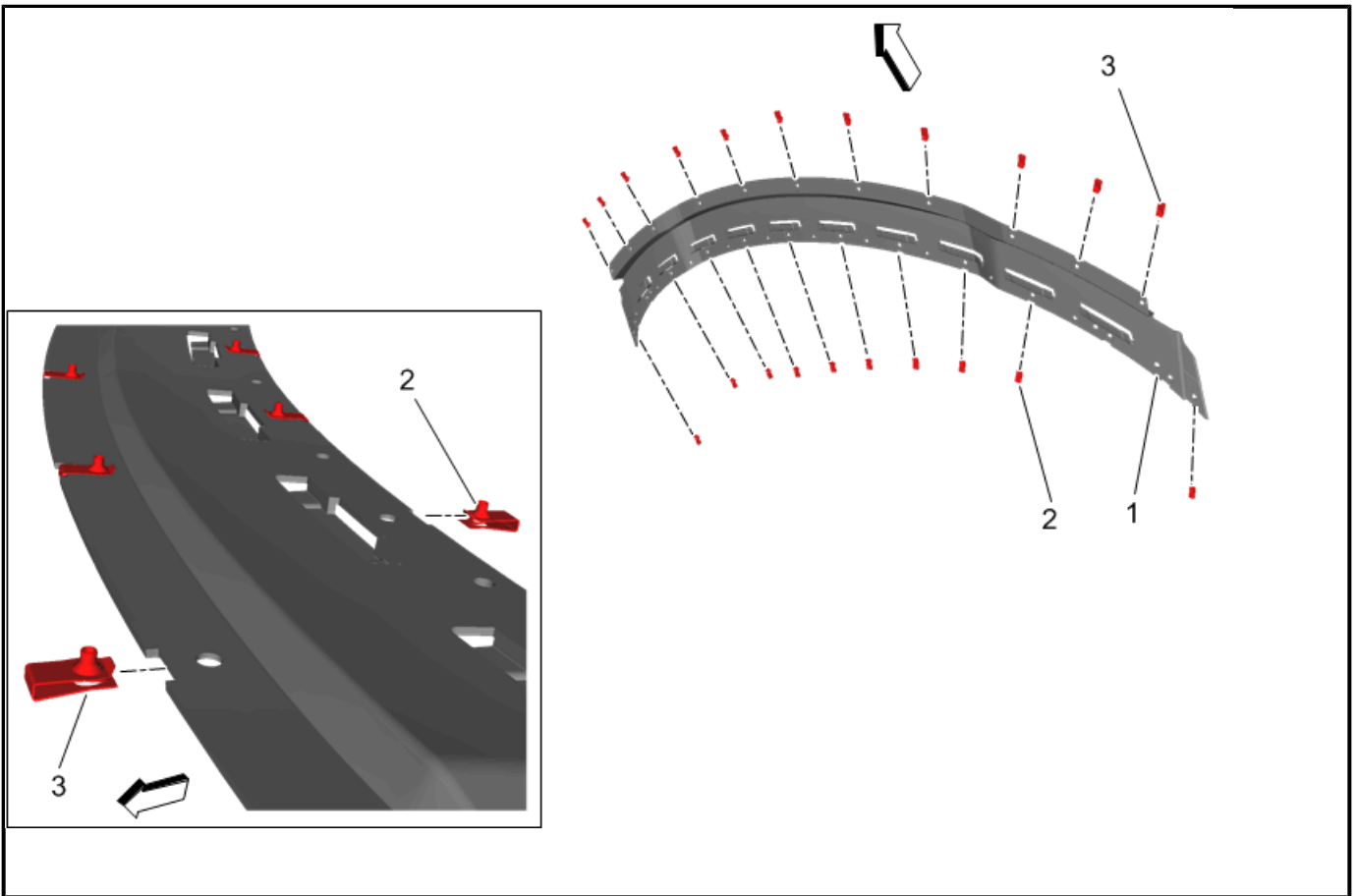

4477299

15. Transfer the 10 clips (2) from the lower fascia to the rear edge of extension panel (1), matching clip locations one part to another.
16. Attach the provided 11 clips (3) to the front edge of the extension panel (1).

Caution: Always check scale, size and position of all templates before drilling. Failing to do so may cause damage to the vehicle, misalignment of components or the inability to install the accessory.

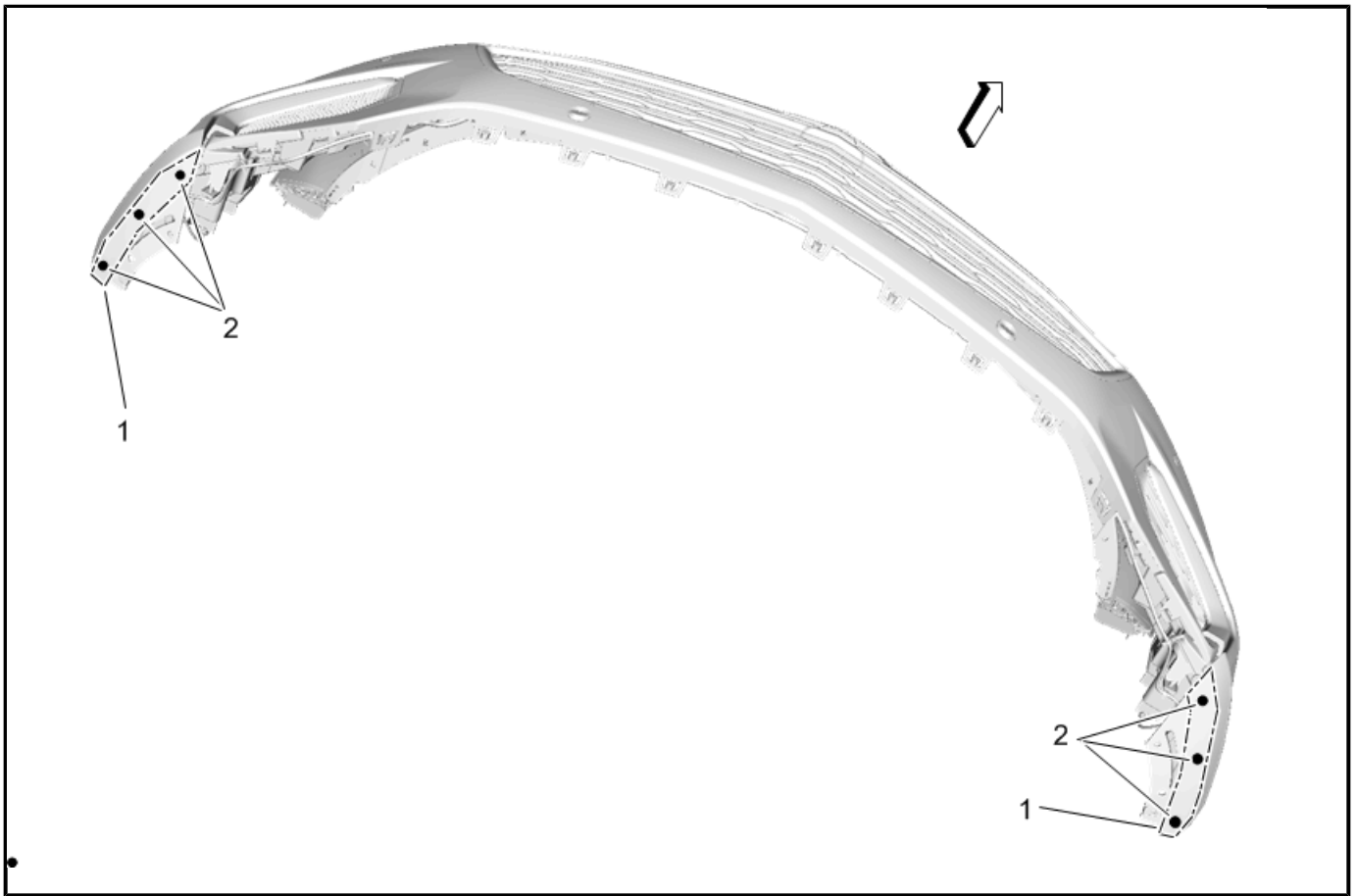

4477303

Note: Template can be used for each side.

17. Cut out and attach the provided drilling template (1) to the left and right bottom surfaces or the upper fascia. Mark and scribe hole locations and remove template. Drill 5/16" (8 mm) holes (2) into the lower flange. After drilling clean holes of debris.

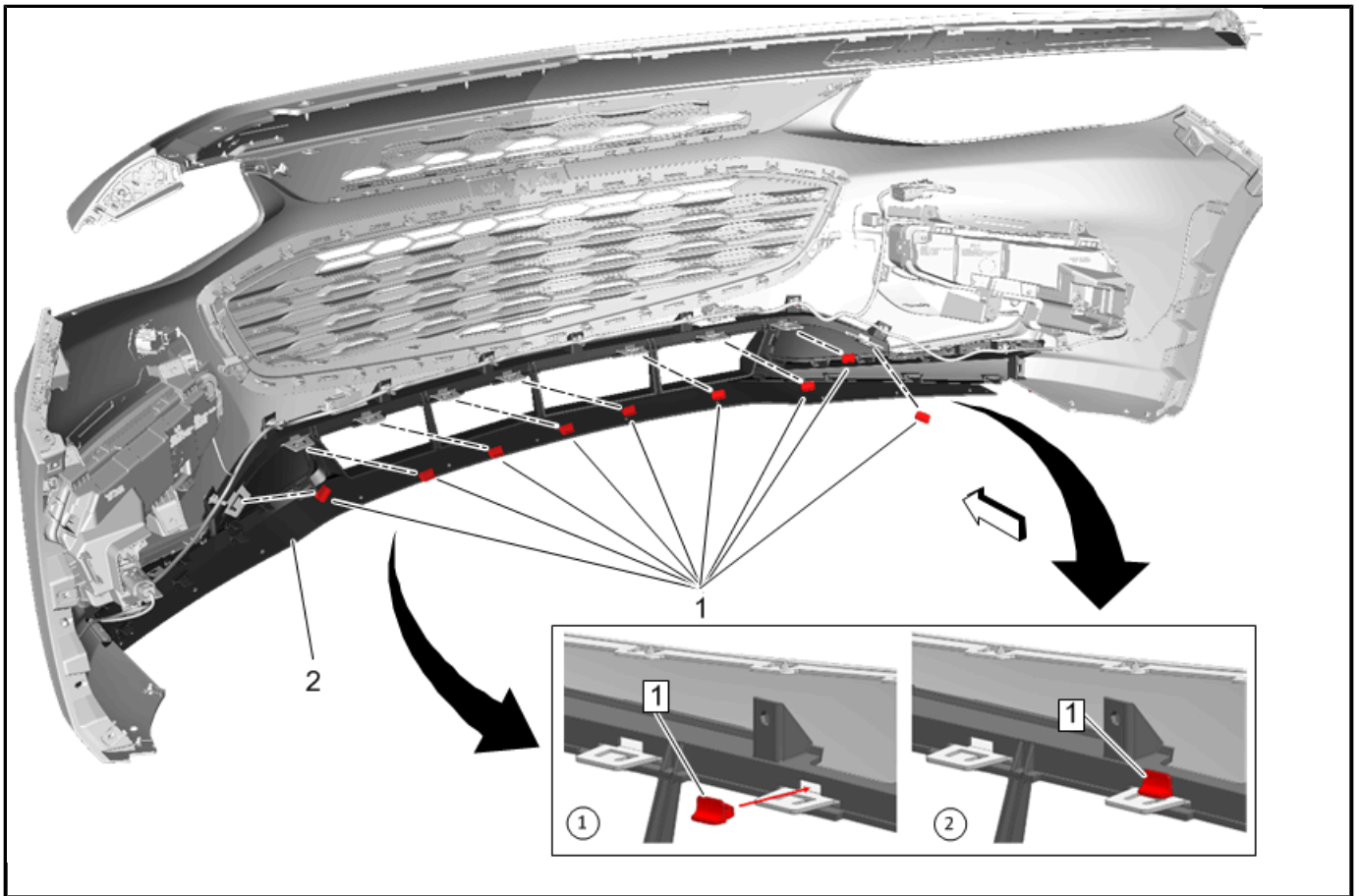

4477307

18. Install the accessory lower fascia (2) to the upper fascia engaging the retainers.
19. Reattach fascia harness to lower fascia.
20. Re-install the previously removed left and right front fascia inserts.
21. Insert the 9 provided plastic clips (1) into the rectangular openings above the fascia attachment tabs to secure the lower fascia to the upper fascia.

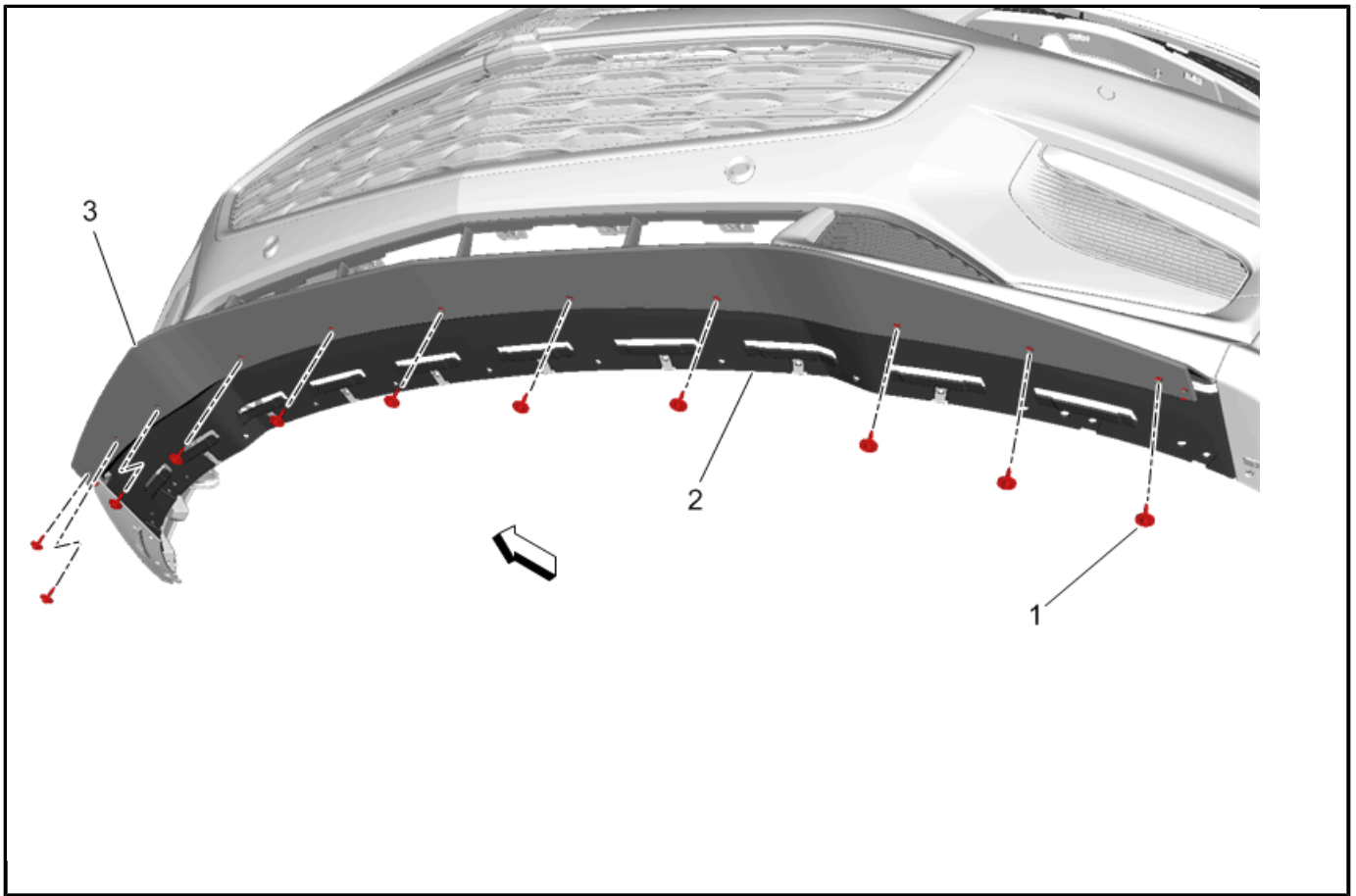

4477331

Caution: Use the correct fastener in the correct location. Replacement fasteners must be the correct part number for that application. Fasteners requiring replacement or fasteners requiring the use of thread locking compound or sealant are identified in the service procedure. Do not use paints, lubricants, or corrosion inhibitors on fasteners or fastener joint surfaces unless specified. These coatings affect fastener torque and joint clamping force and may damage the fastener. Use the correct tightening sequence and specifications when installing fasteners in order to avoid damage to parts and systems.

22. Attach the extension panel (2) to accessory lower fascia (3) with the supplied 11 screws (1). Tighten the screws to 2.5 N.m (22 lb in).

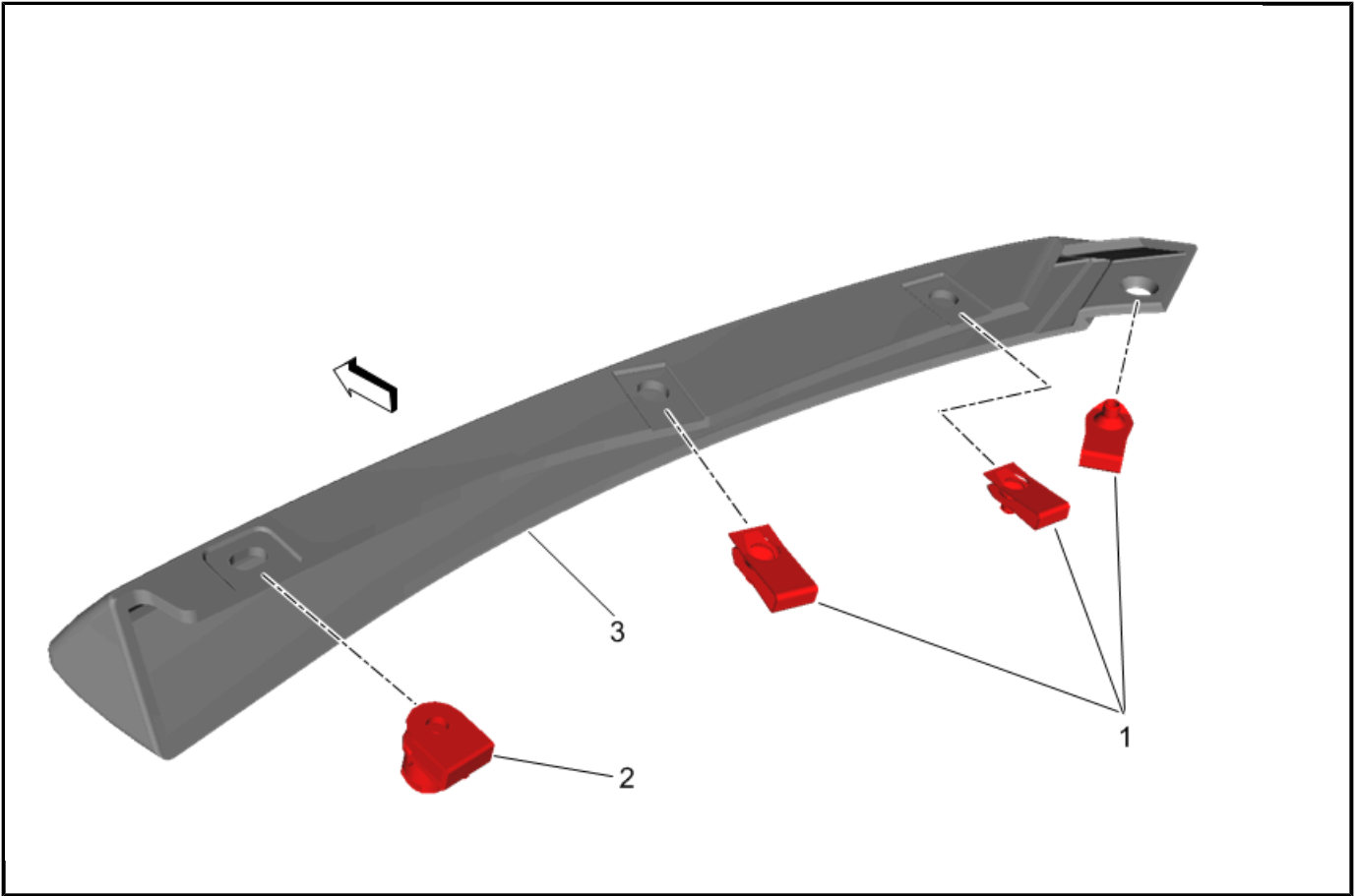

4477334

23. Attach the 3 clips (1) and plastic clip (2), to the splitter end (3).

Note: The plastic clip goes on the far outside hole.

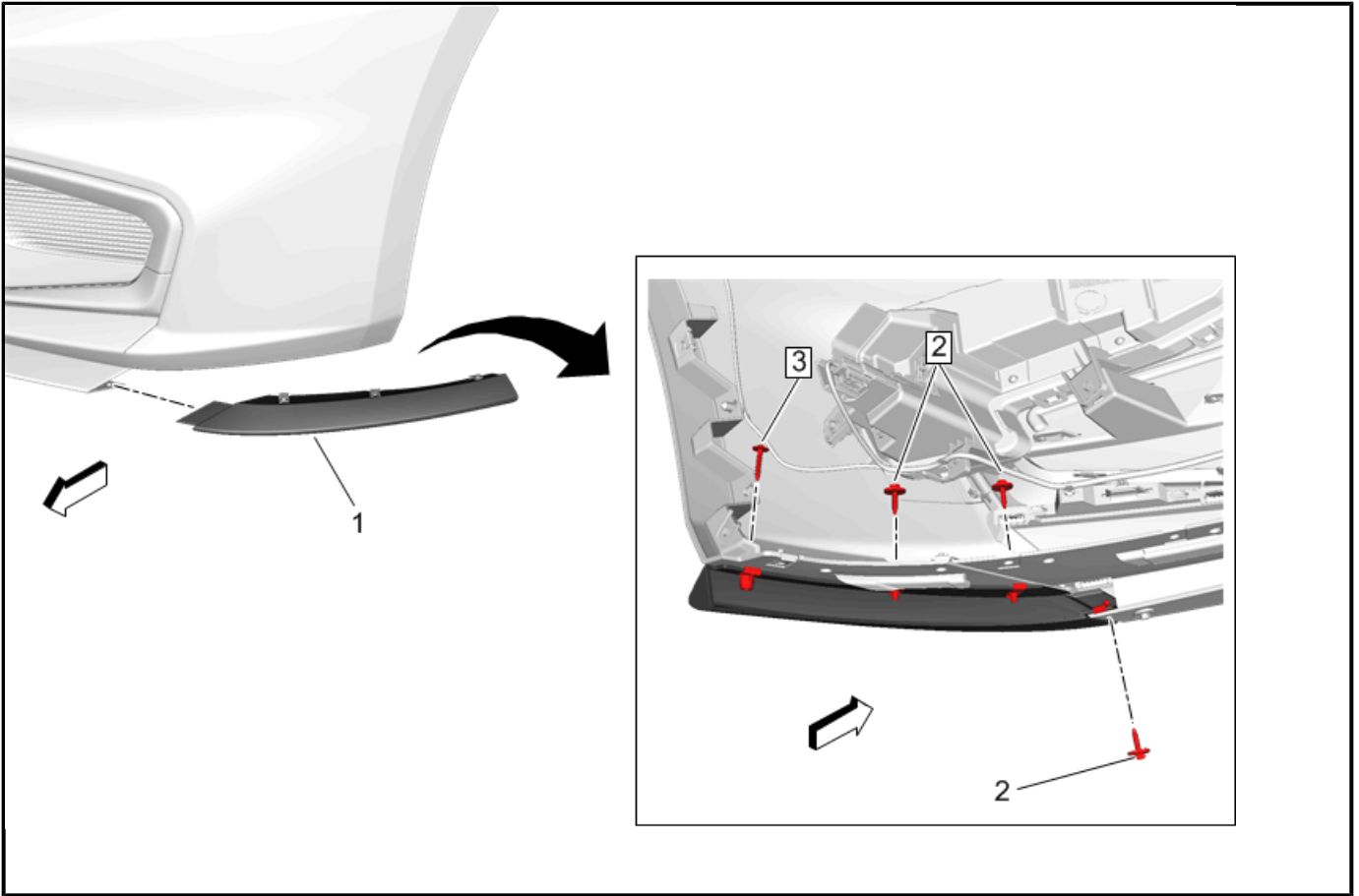

4477336

24. Attach the splitter end (1) to the vehicle with the 3 screws (2) and plastic screws (3). Tighten screws (2) to 2.5 N.m (22 lb in).

Note: Make sure the splitter end is aligned well to the rest of the fascia and that it looks acceptable before tightening screws.

25. Repeat splitter end installation for the other side.
26. Re-install the front fascia to the vehicle, including the air dam and lower closeout panel.

Note: The old lower fascia may be discarded.

Rocker Molding

1. Raise vehicle safely on hoist. Refer to Vehicle Service Manual.
Note: Make sure there is enough clearance between the hoist and the body to install the rocker moldings.
2. Make sure the rocker area of the vehicle, including underneath, is clean of dirt and debris.

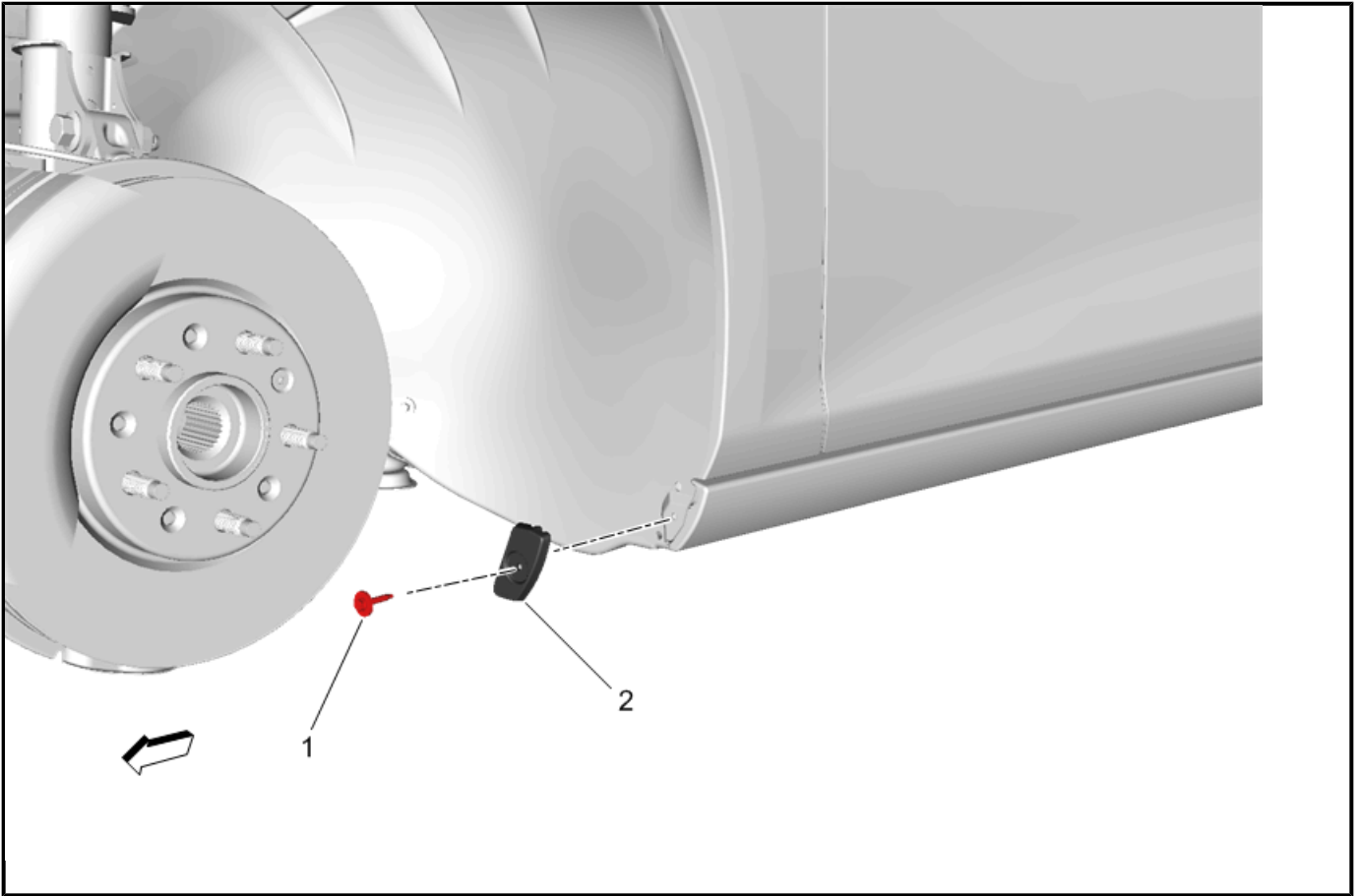

4477338

3. In the front wheel well, remove and retain the screw (1) holding the stone guard to the rocker.
4. Being careful not to damage the wheel liner, detach the stone guard (2) from the wheel liner and discard.

Note: You may need to snip the posts on the back side.

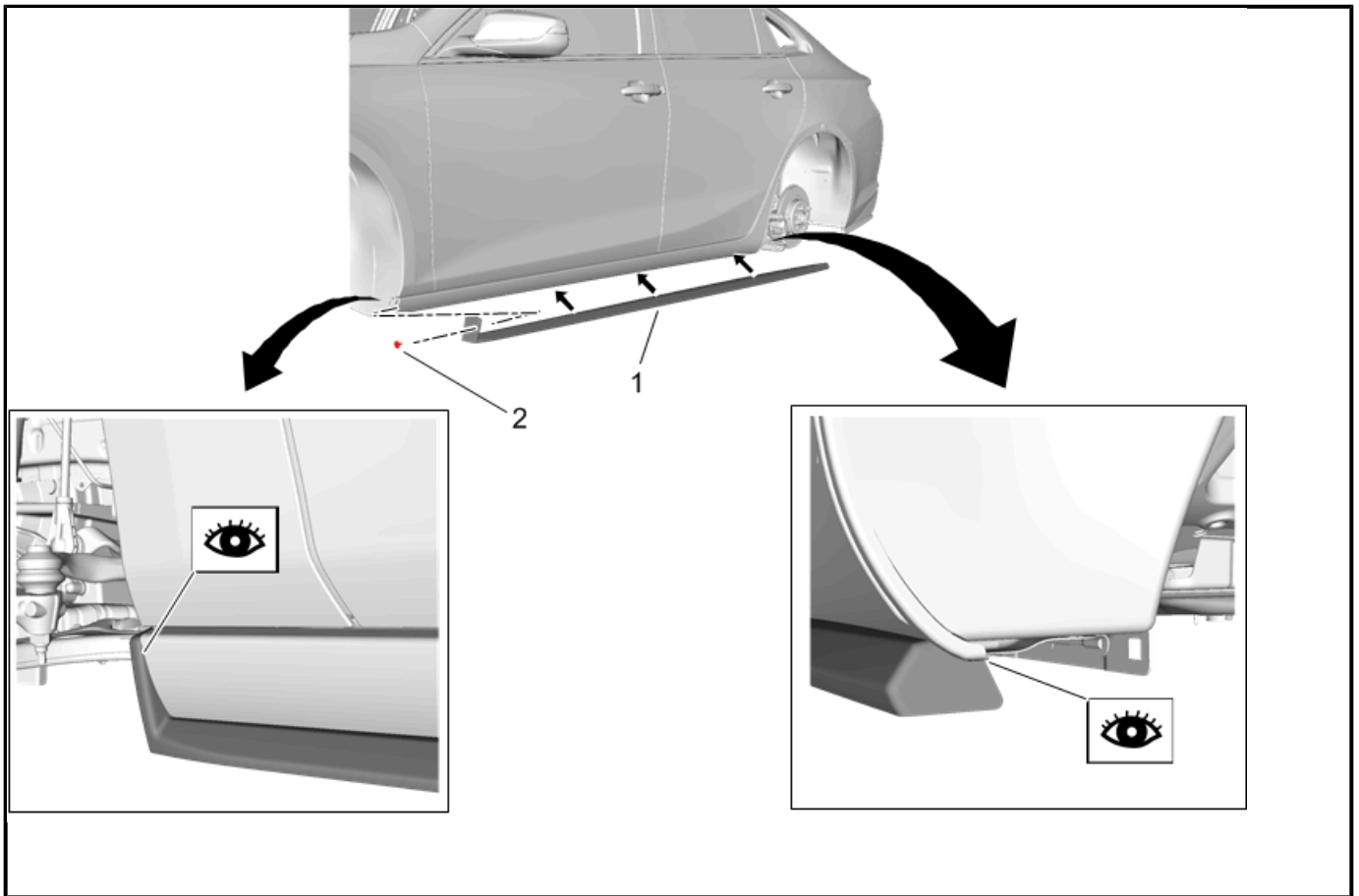

4477341

5. With the aid of an assistant, position the accessory rocker molding (1) up to the body, attach the front of the rocker molding to the body using the previously retained stone guard screw (2). Making sure the rocker is properly aligned to the body at the front and at the back of the rocker, firmly tape the rocker molding into position temporarily.

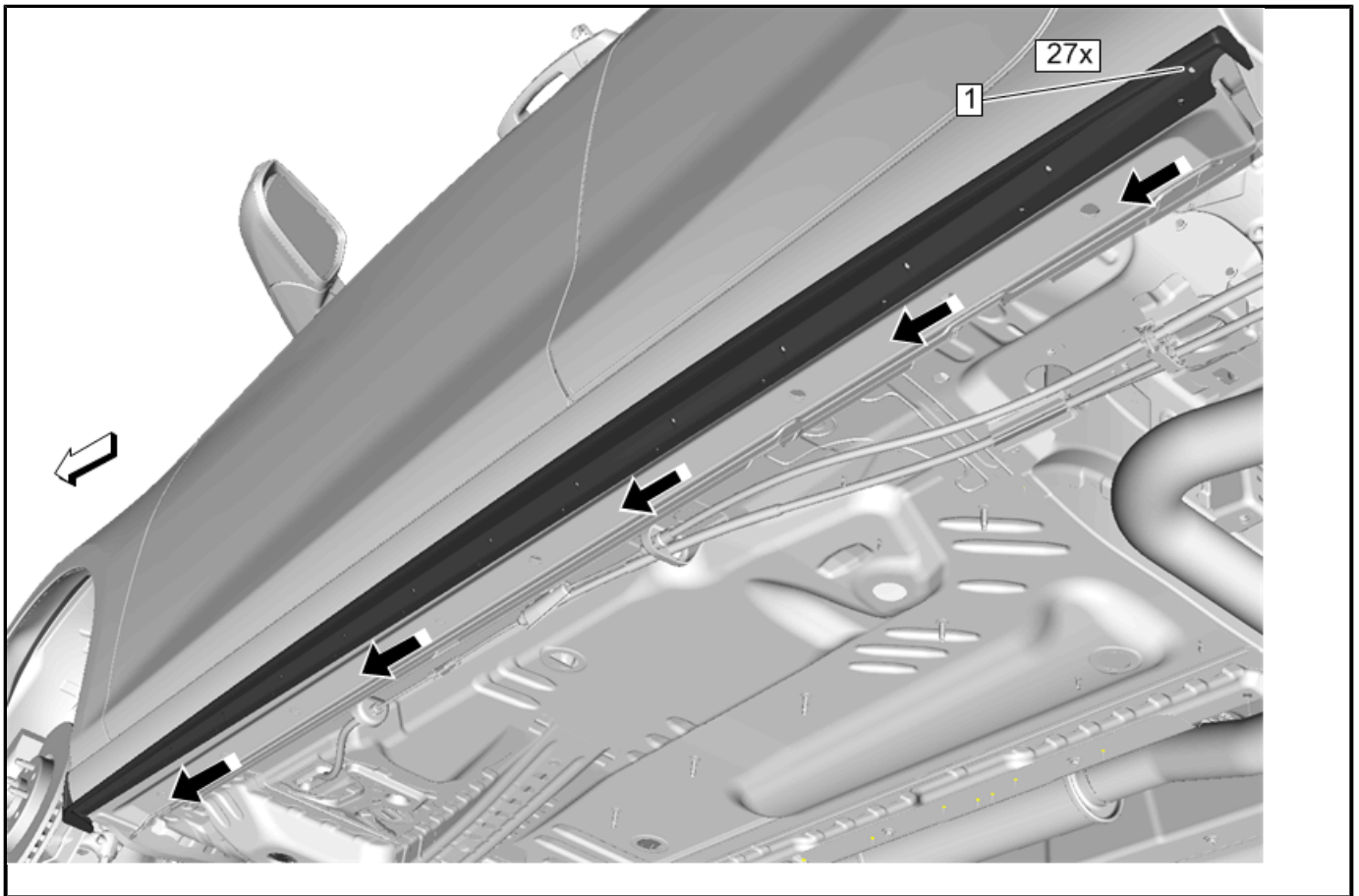

4477344

Caution: Check position of rocker molding before drilling. Failing to do so may cause damage to the vehicle, misalignment of components or the inability to install accessory.

6. Using the rocker molding as a template, drill a 13/64" (5 mm) hole at the rearmost location. Use a temporary screw at this location to hold the rocker molding in place as you drill out the rest of the holes (27 places total). **MAKE SURE THE ROCKER MOLDING DOES NOT SHIFT FROM ITS CORRECT POSITION AS YOU DRILL THE HOLES.**
7. Remove the rocker molding in preparation for the next step.
8. **IMPORTANT:** SPRAY SUPER LUBE, P/N 12346241 (in Canada, P/N 10953474), OR EQUIVALENT, ONTO THE DRILLED HOLES TO PREVENT RUST AND CORROSION.

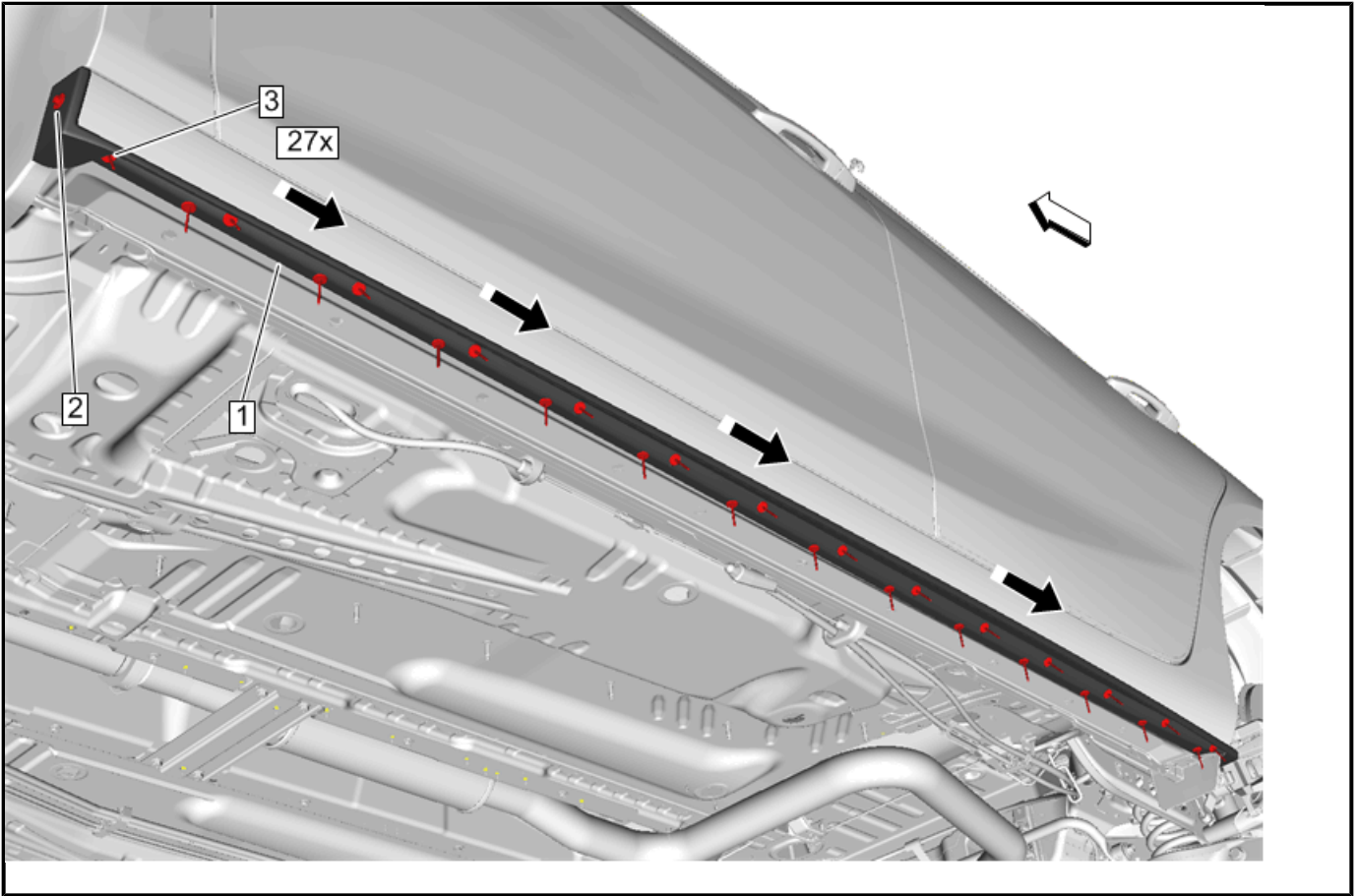

4477347

9. Reinstall the rocker molding (1) to the vehicle with the front stone guard screw (2) and then fasten it to the body with the 27 provided rivets (3) into the previously drilled holes.

Note: When installing the rivets, work your way from the front of the rocker molding to the back. The hoist arm positions may need to be adjusted to reach all rivet holes.

10. Repeat rocker installation steps for other side.

Rear Valance

Note: Steps 1-6 are only required if vehicle is only equipped with single exhaust.

1. Make sure the rear fascia is washed and cleaned of dirt and debris.
2. Raise vehicle safely on hoist. Refer to Vehicle Service Manual.

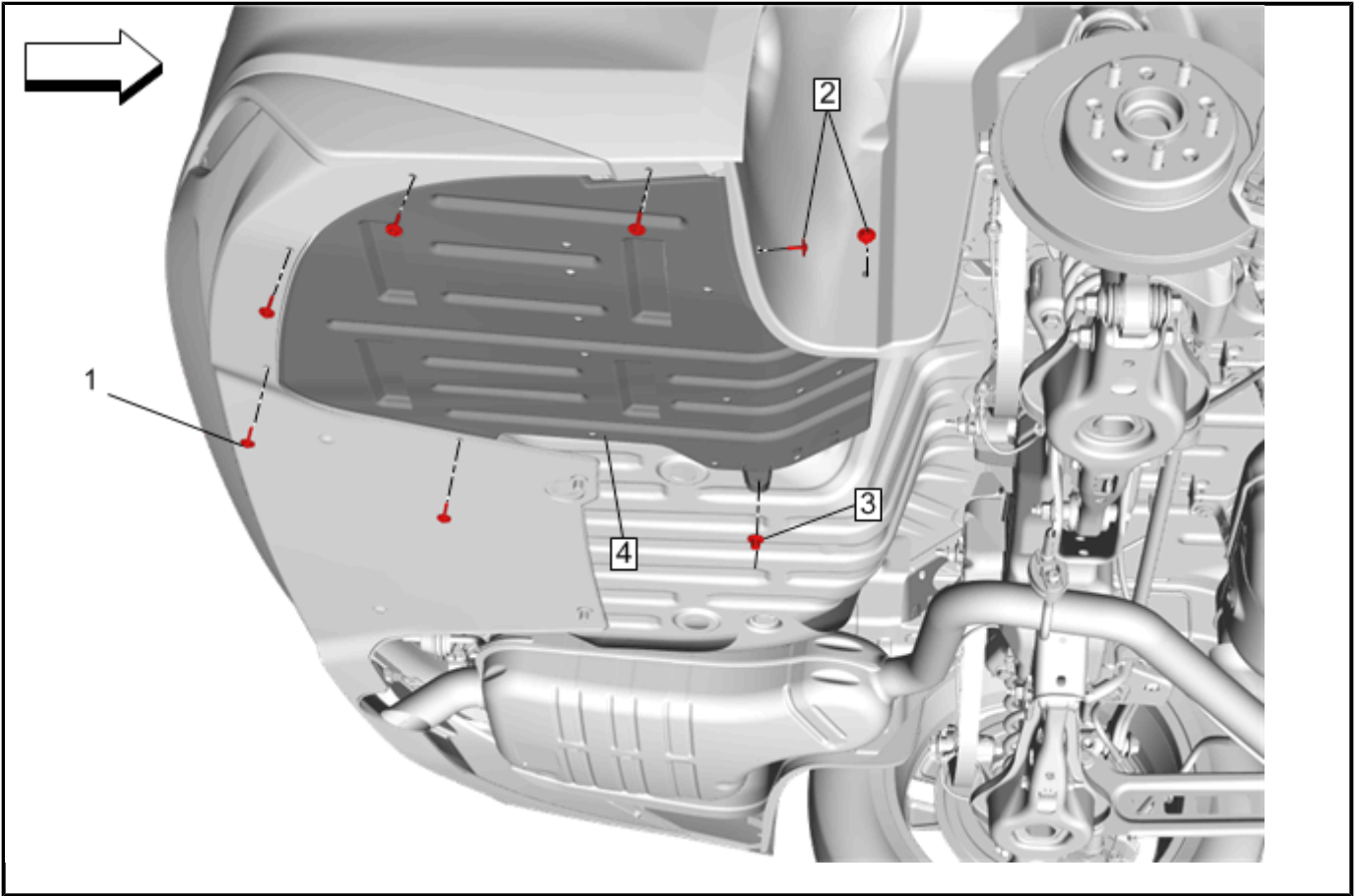

4213331

3. Remove the underbody rear air deflector bolts (1) Qty:5.
4. Remove the rear wheelhouse liner screws (2) Qty:2.
5. Remove the rear underbody rear air deflector nut (3).
6. Remove and discard the rear underbody rear air deflector.

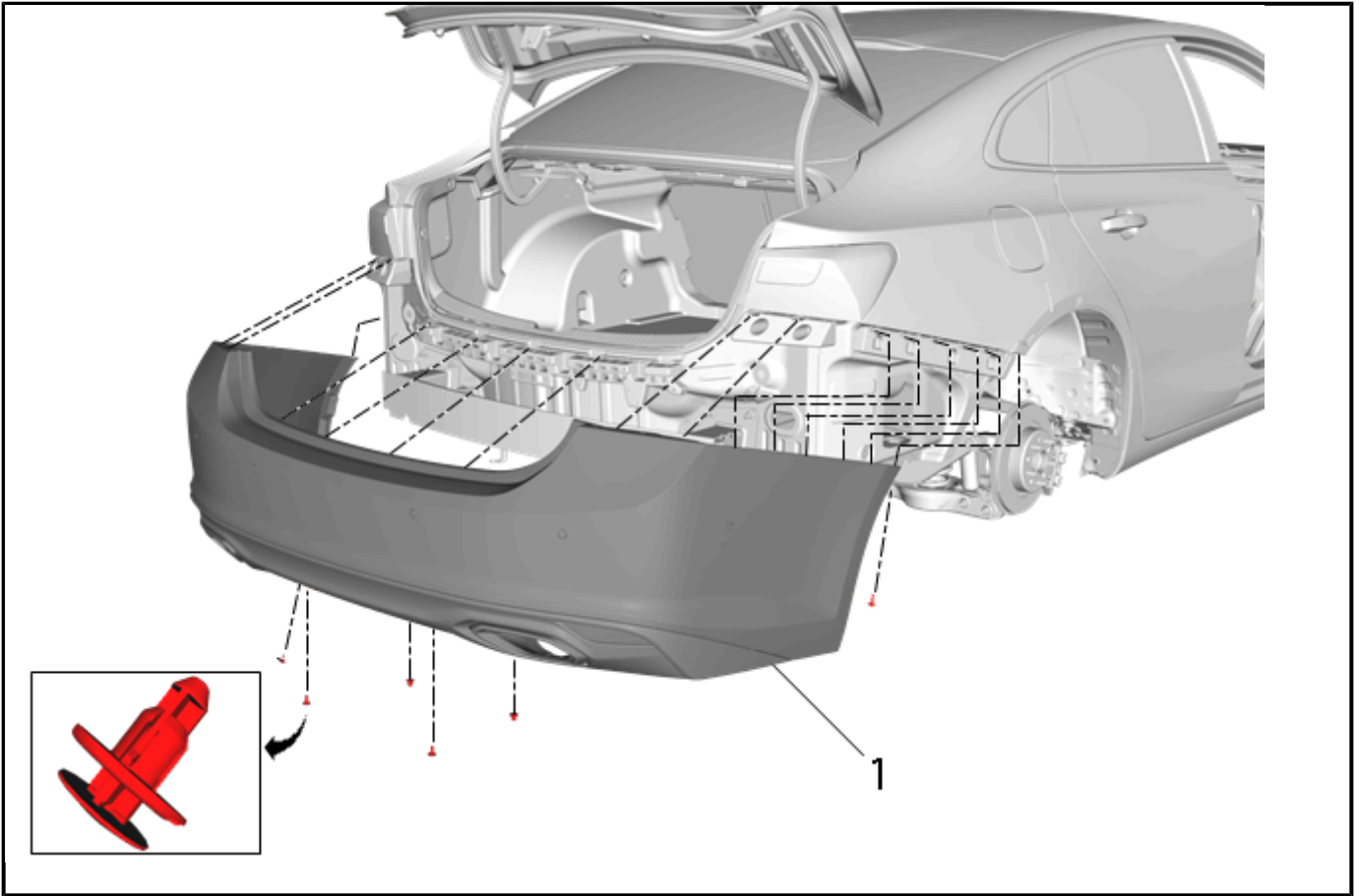

4477272

7. Remove the rear bumper fascia (1). Refer to Vehicle Service Manual.
8. Place the rear bumper fascia on a work surface that will not scratch or damage parts.

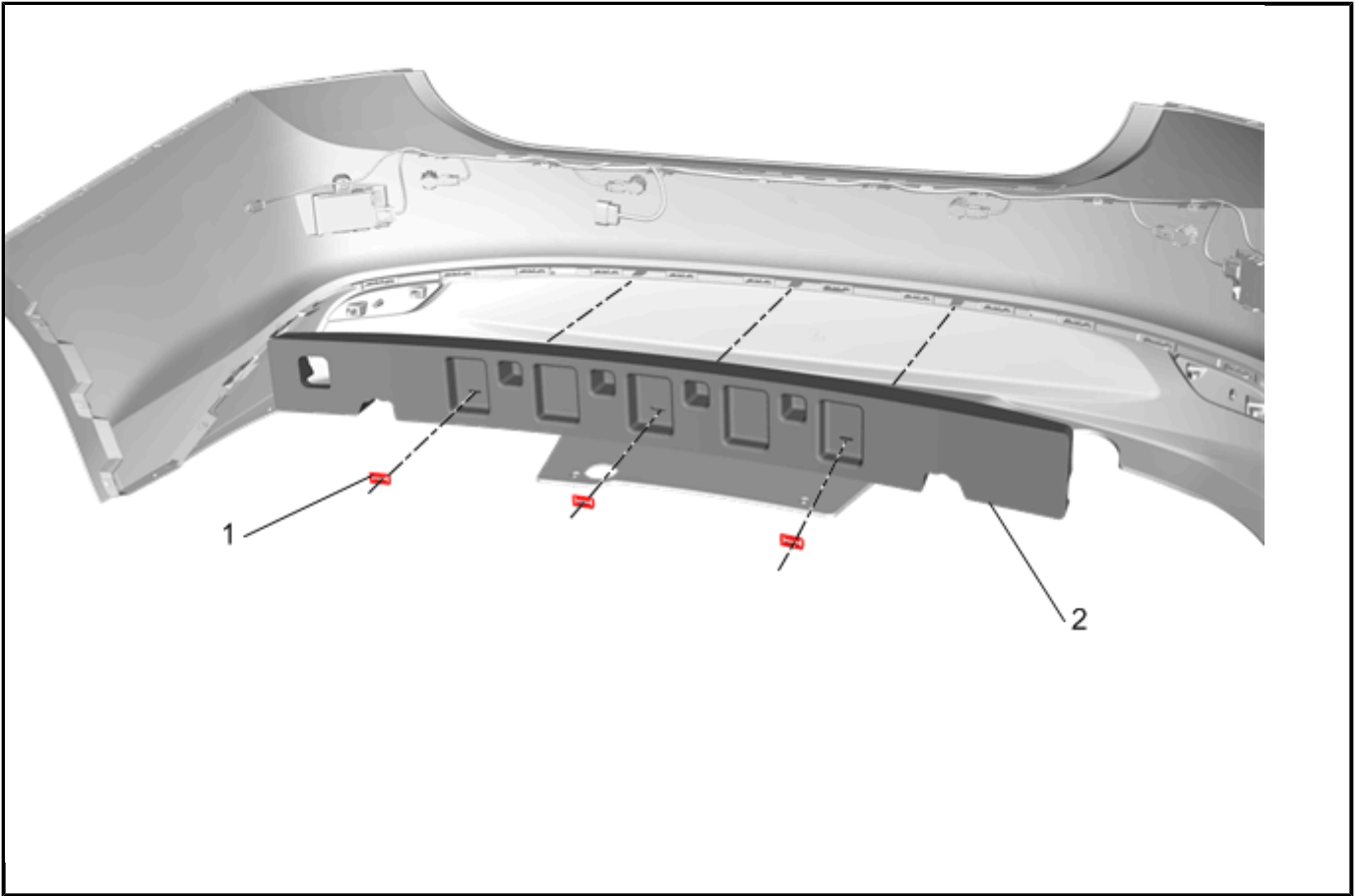

4217025

9. Remove and retain the rear bumper fascia energy absorber clips (1) Qty:3.
10. Remove the rear bumper fascia energy absorber (2) from the rear bumper fascia.
11. Remove the rear bumper valance panel bolts (1) Qty:2.

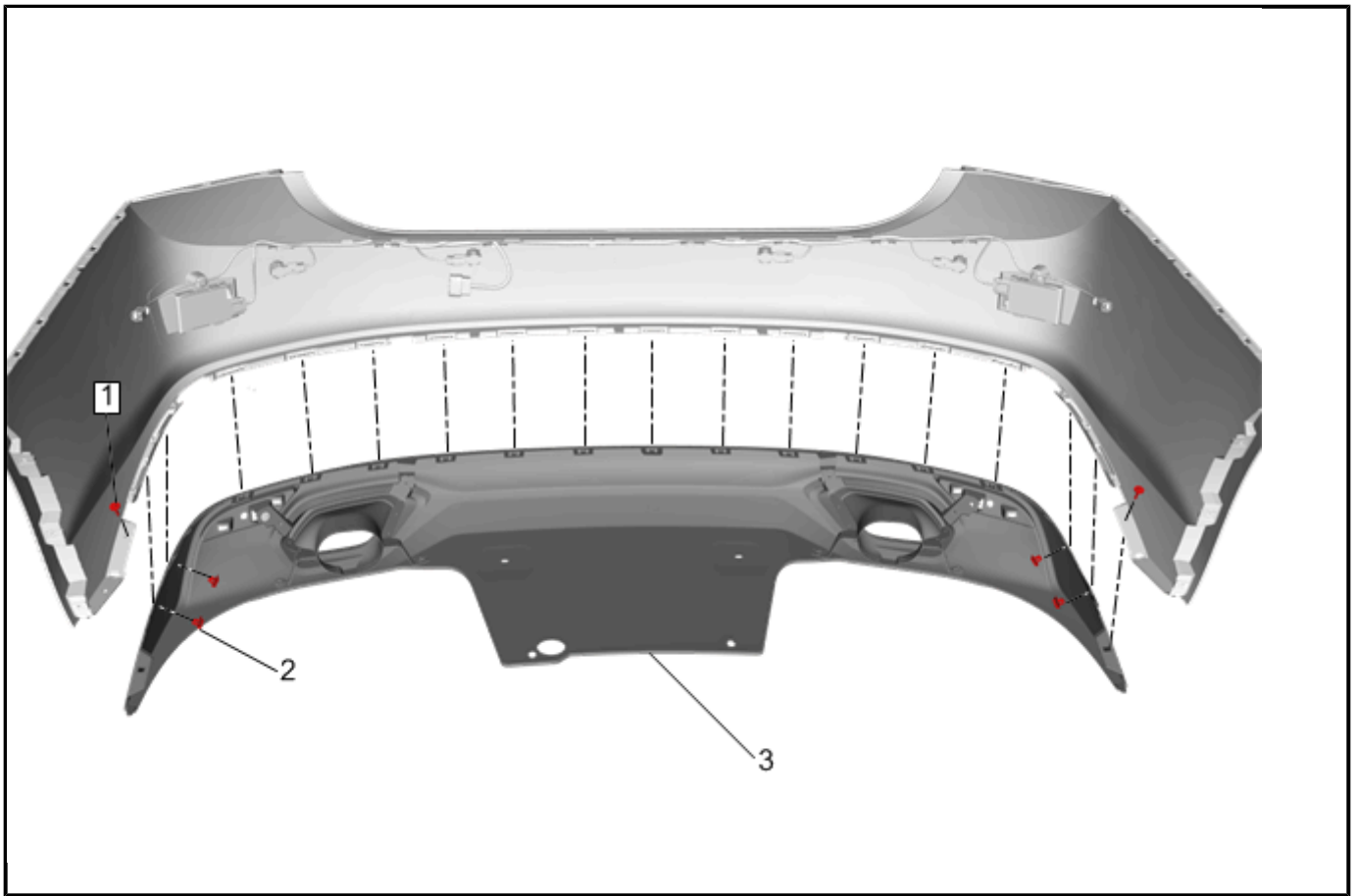

4277625

12. Remove the rear bumper valance panel clips (2) Qty:4.
13. Carefully push a small nylon wedge between the lower fascia and the rear bumper valance panel (3). Insert a small flat-bladed tool into the fascia slot and depress the snaps one at a time and pull on the fascia at the same time to gradually remove the upper fascia from the rear bumper valance panel.

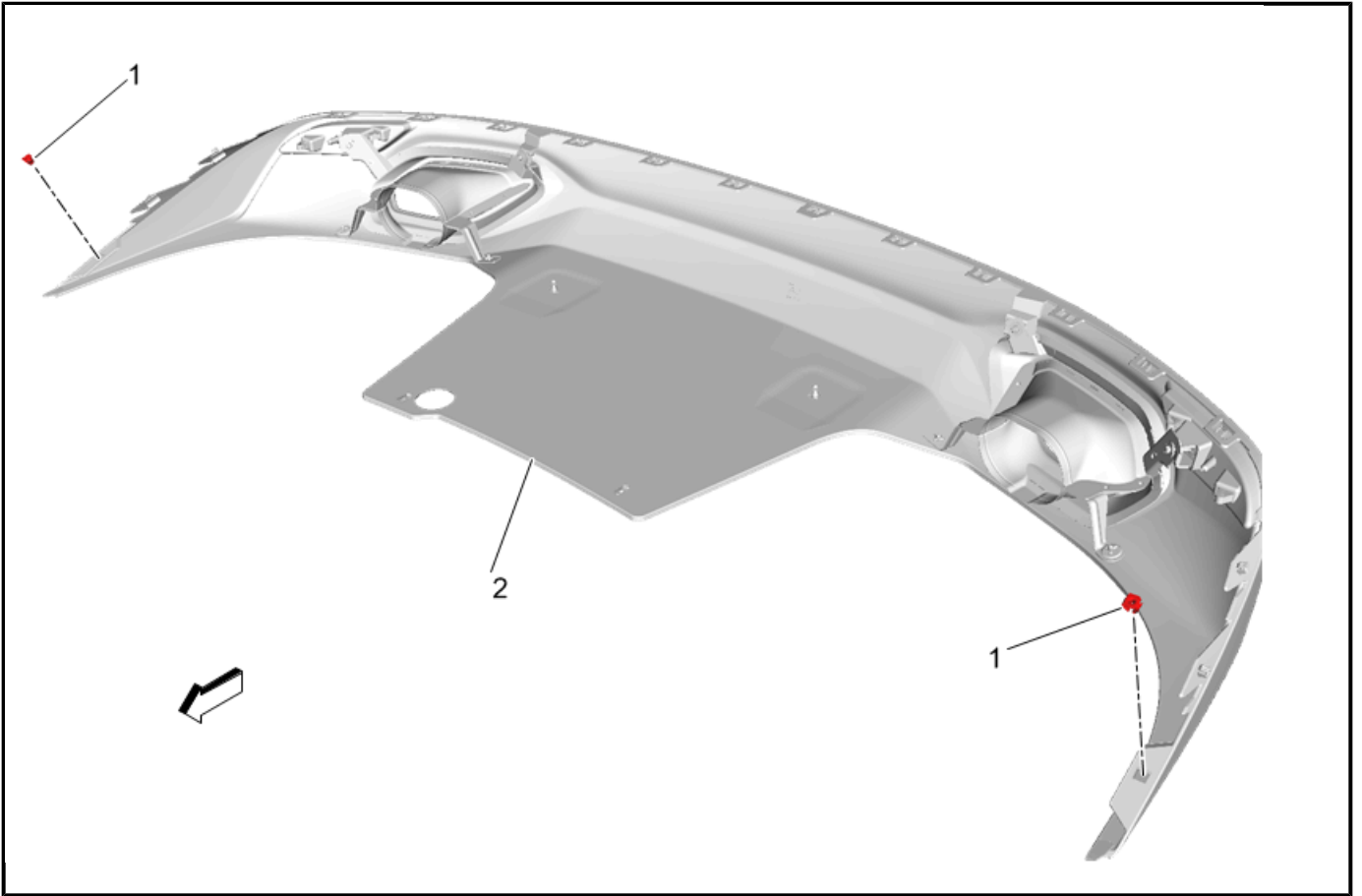

4477350

14. Remove and retain the box nuts (1) from the old lower fascia (2).

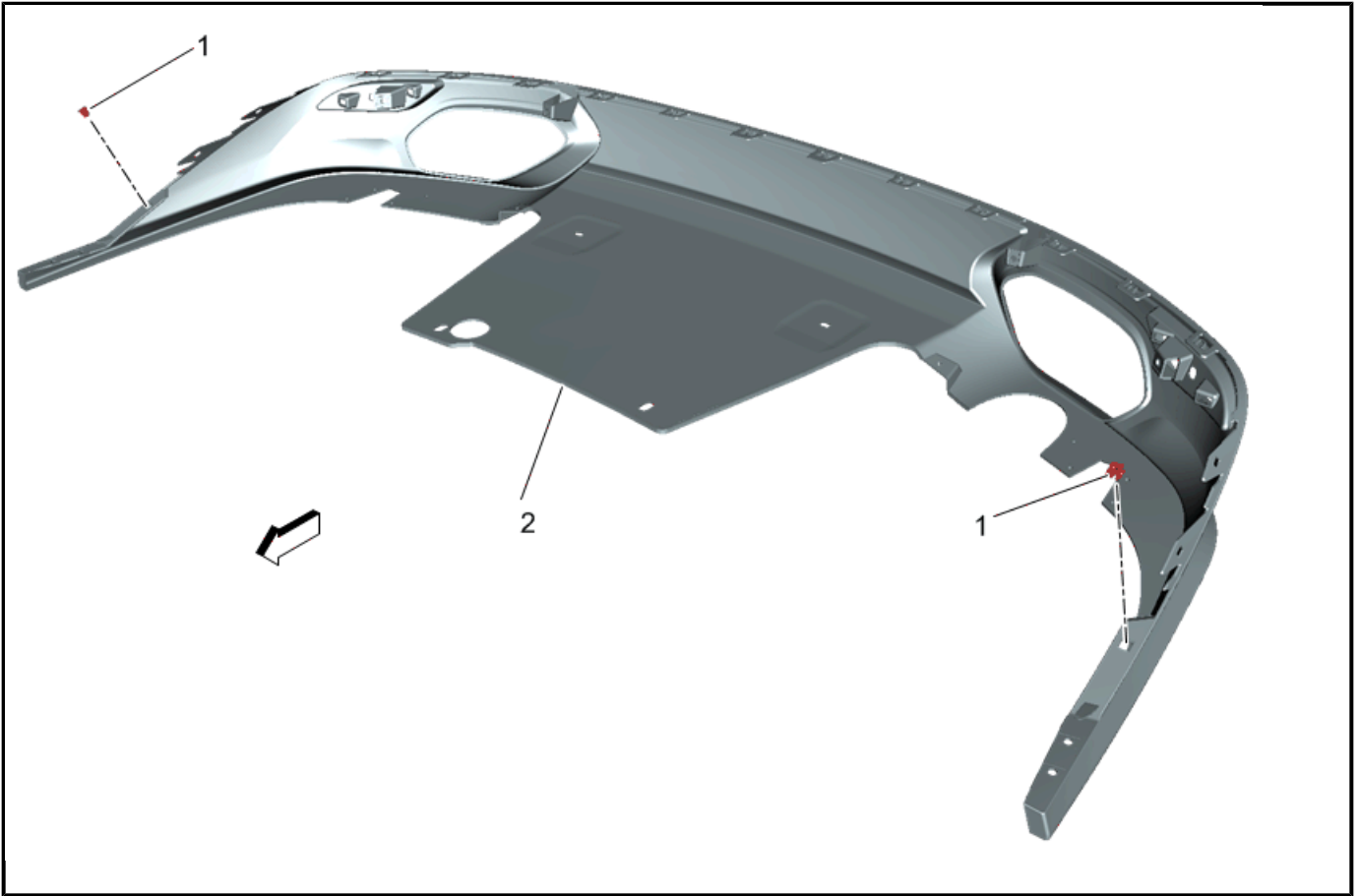

4477351

15. Install the previously removed box nuts (1) into the new valance panel (2).

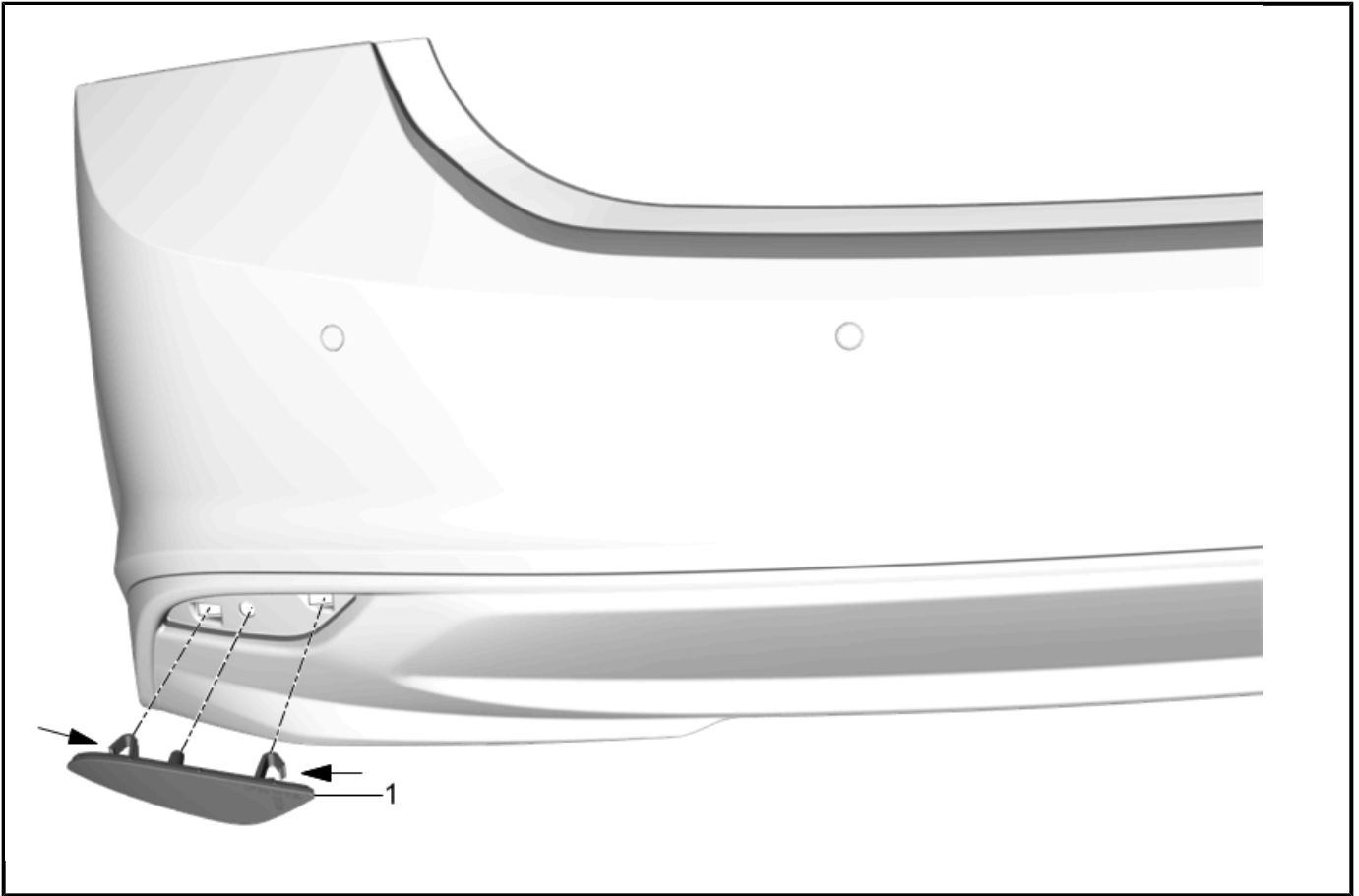

4223768

16. Remove the left and right rear fascia lower signal lamps (1) from the lower valance panel by releasing the retaining tabs.

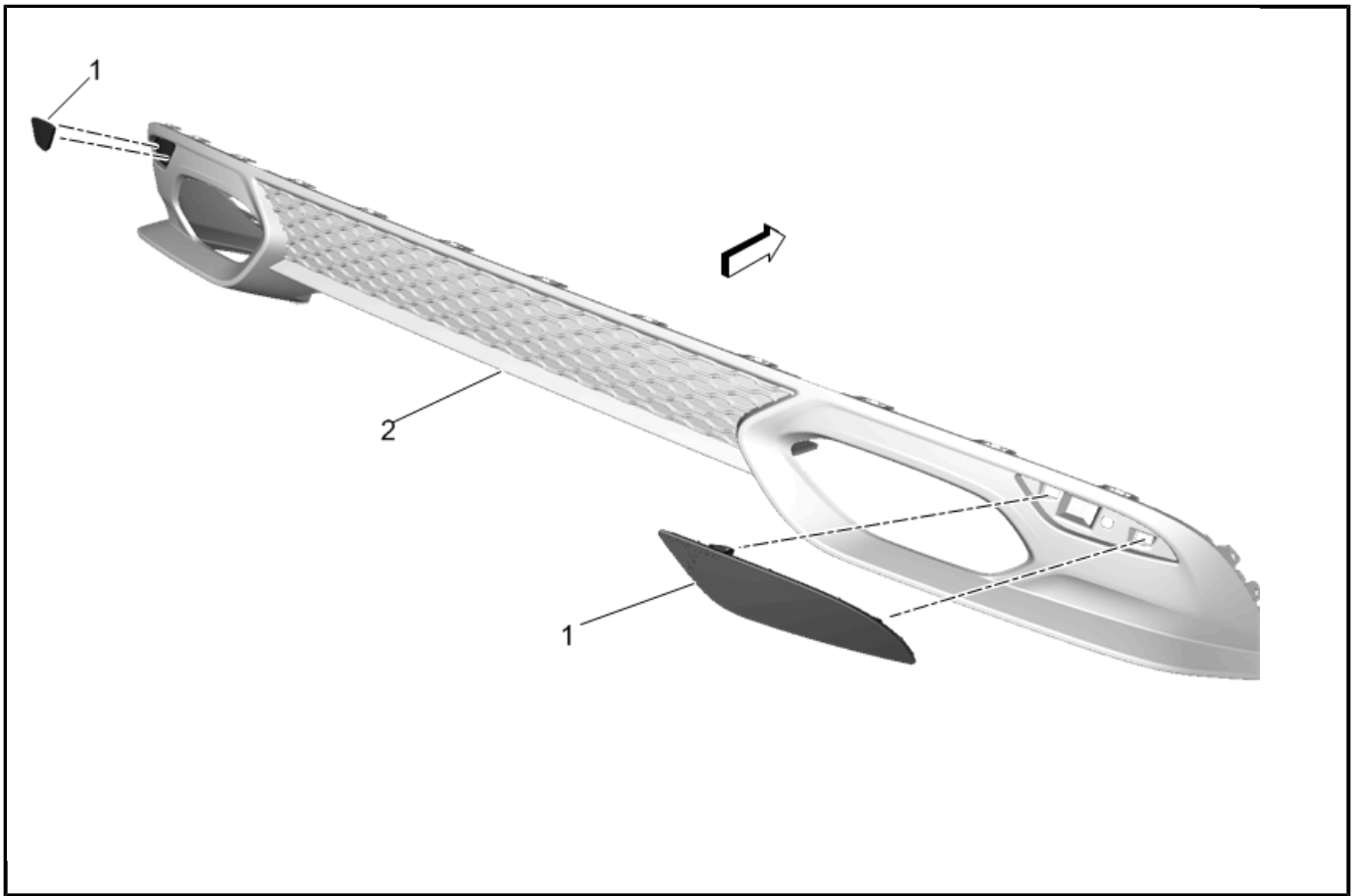

4477352

17. Install the previously removed rear fascia lower signal lamps (1) to the new lower valance panel (2) engaging the retaining tabs.

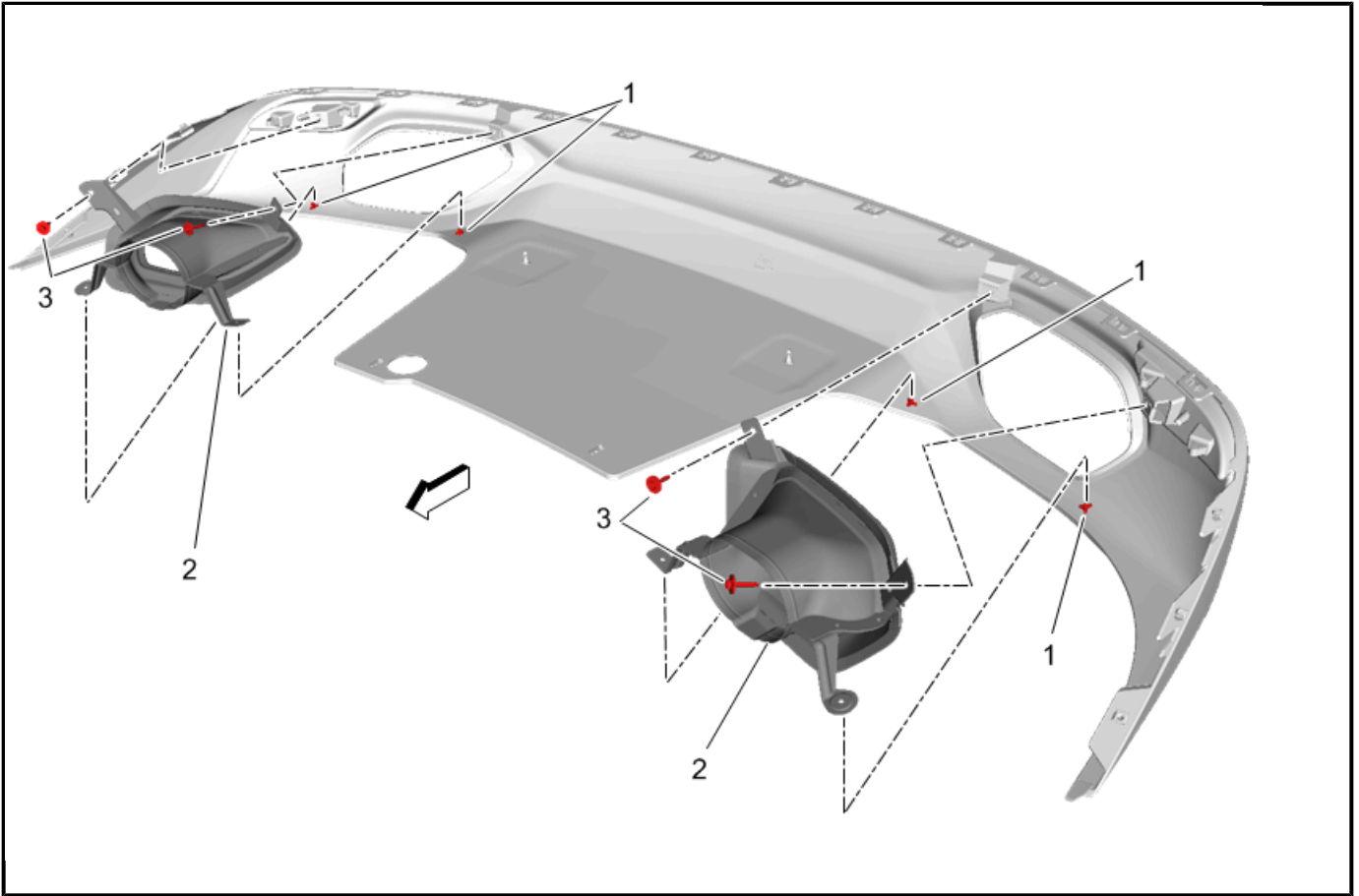

4477356

Note: Steps 18-20 are for vehicles equipped with dual exhaust only.

18. Remove the rivets (1) and screws (3) from the rear exhaust bezels (2).
19. Remove the rear exhaust bezels (2) from the old lower valance panel.

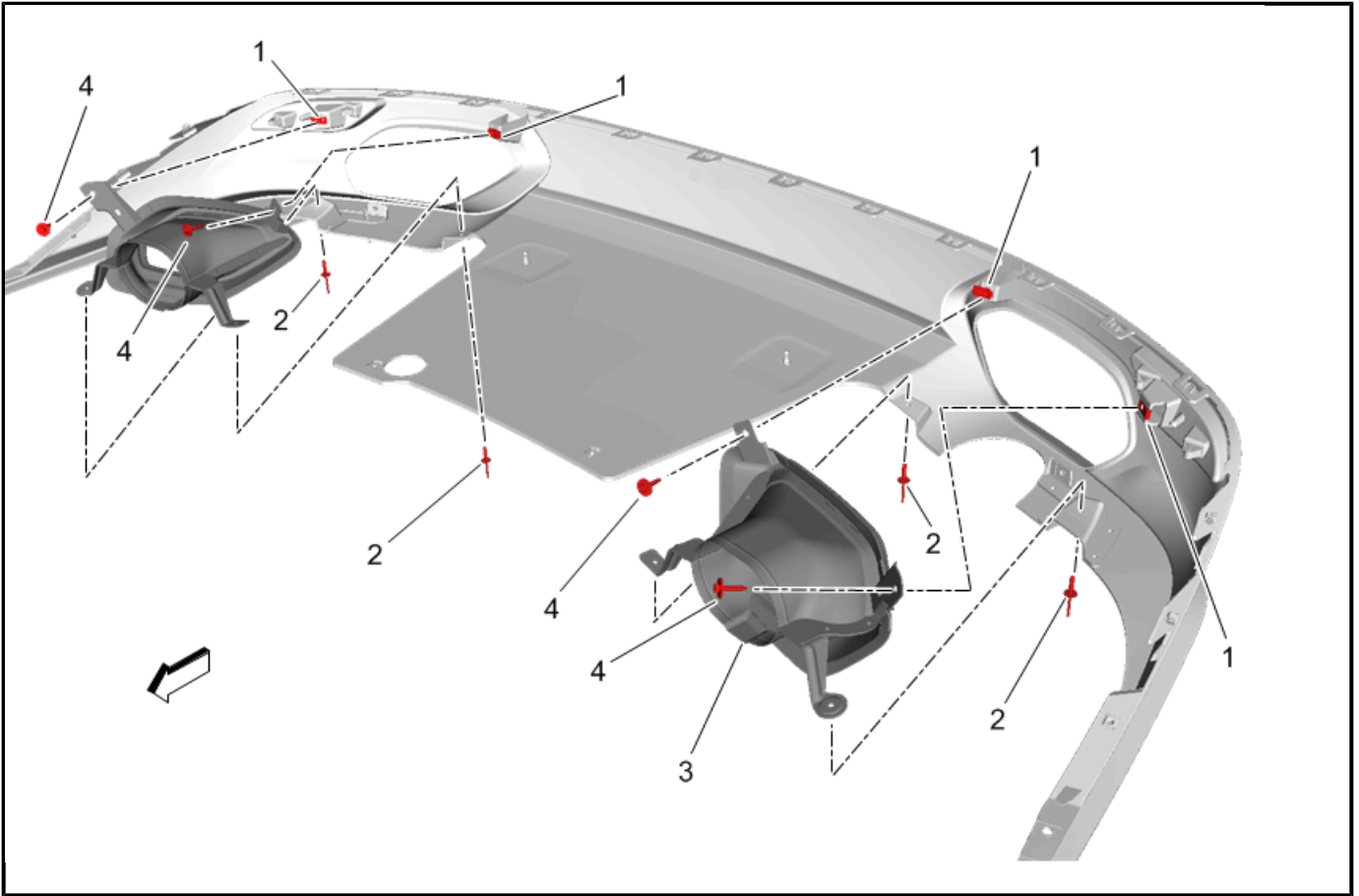

4477359

20. Install the supplied clips (1) to the new valance panel, and install the previously removed rear exhaust bezels (3) and secure with rivets (2) and screws (4). Tighten the screws to 2.5 N.m (22 lb in).

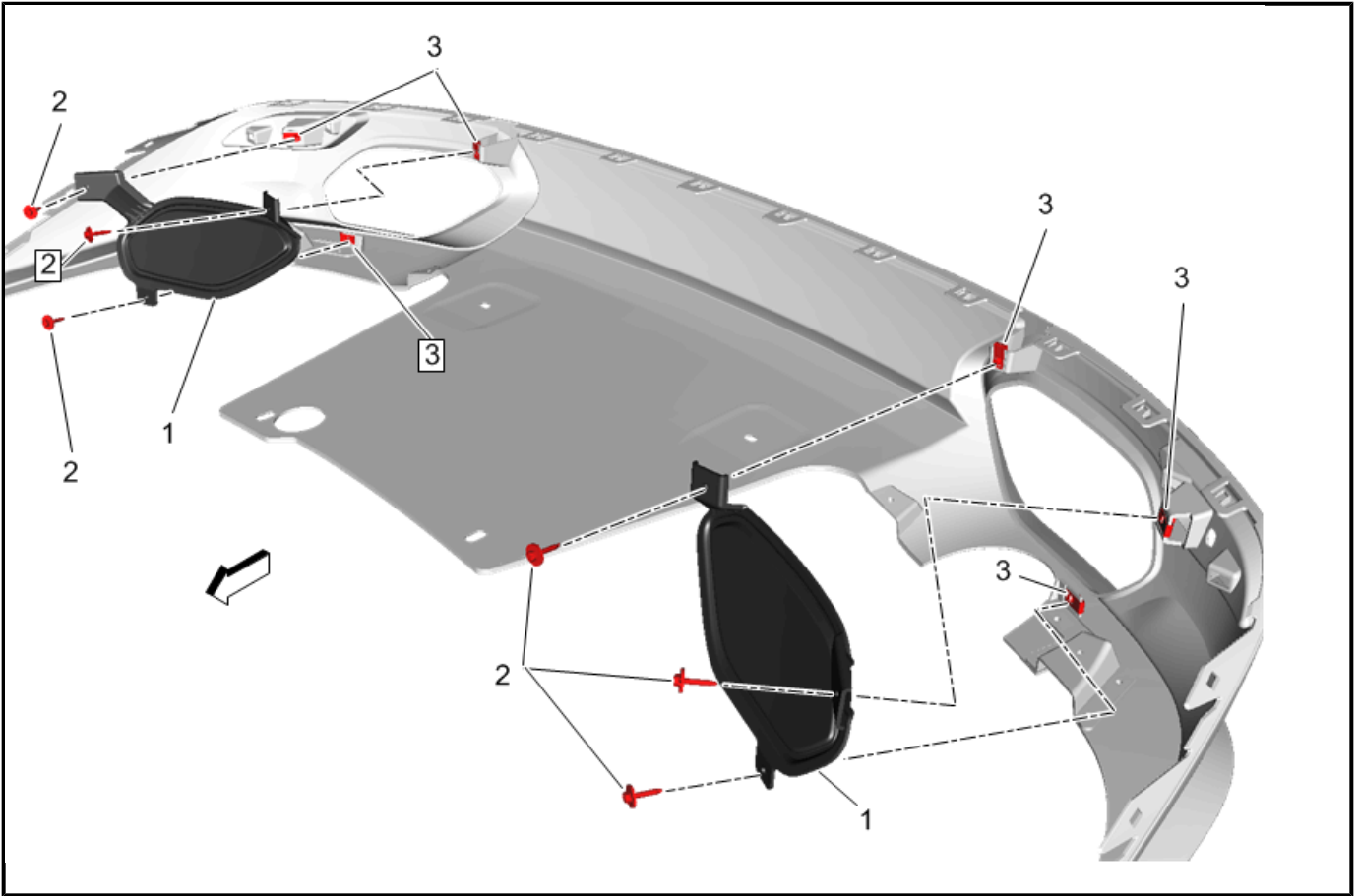

4477363

Note: Steps 21-22 are for vehicles equipped with single exhaust only.

21. Install the supplied clips (3) to the new valance panel.
22. Install the caps (1) to the new valance panel and secure with the provided screws (2). Check caps for a good fit. Loosen and retighten screws to adjust, as needed. Tighten the screws to 2.5 N.m (22 lb in).

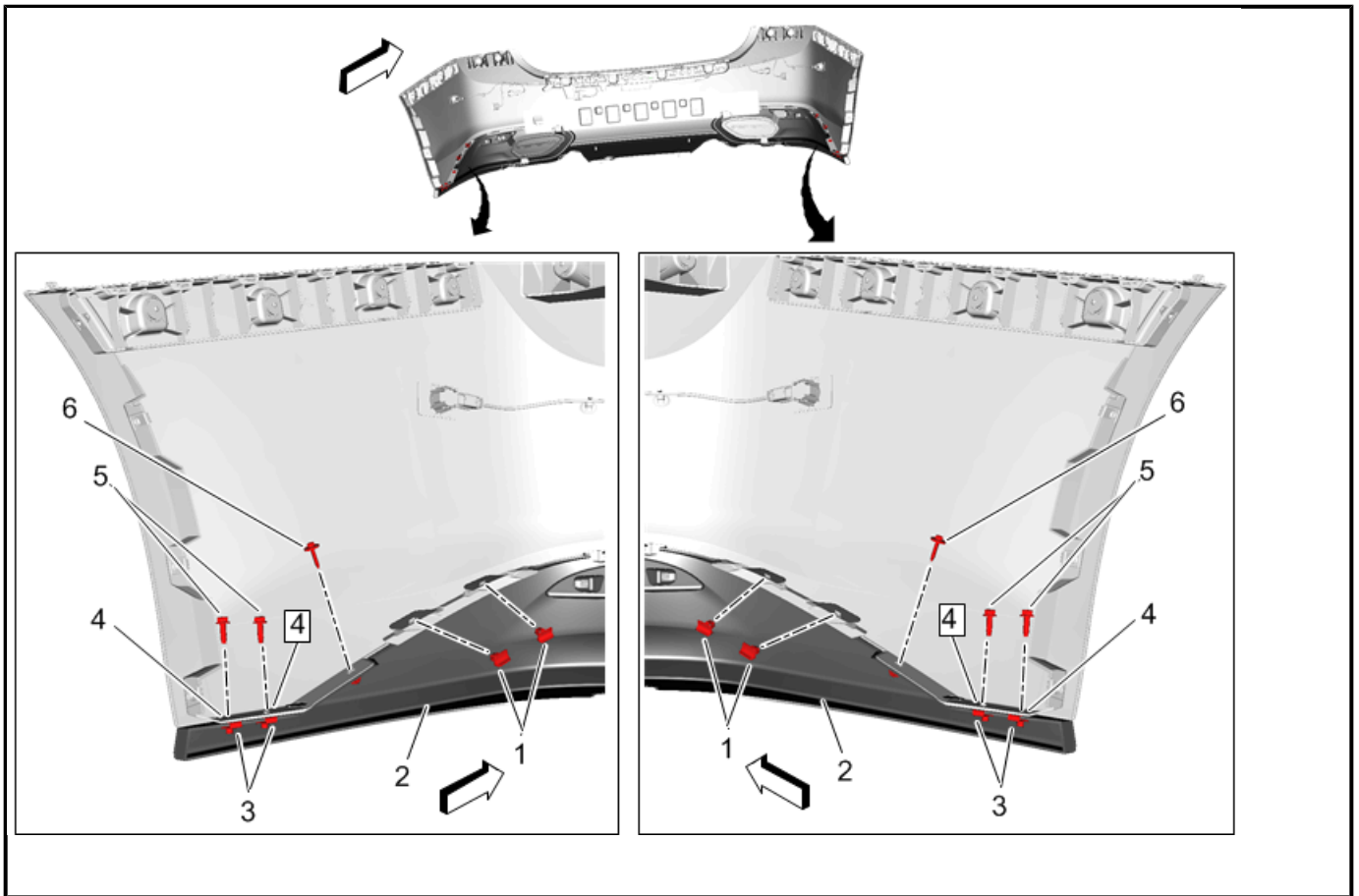

4477367

23. Attach new valance panel (2) to the upper fascia, making sure all clips (1), screws (6) and tabs are properly seated.
24. Reinstall the rear bumper fascia energy absorber to the rear bumper fascia.
25. Making sure the edges of the valance panel are aligned to the upper fascia, drill 5/16" (8 mm) holes (4) into the upper fascia at the designated valance panel holes.
Note: The upper fascia may already have some holes in these locations.
26. Fasten the ends of the valance panel to the upper fascia with the 2 clips (3) and 2 screws (5). Check valance ends for a good fit to the upper fascia. Loosen and retighten screws to adjust, as needed. Tighten the screws (5), (6) to 2.5 N.m (22 lb in).
27. Re-install rear bumper fascia. Refer to Vehicle Service Manual.