

Document ID: 4954765

# Body Accessory Trim Package Installation

## [Installation Instructions Part Number](#)

84081550

### Kit Contents

Qty	Description
1	Splitter-F/End
1	Splitter Bracket - LH
1	Splitter Bracket - RH
1	Hardware Package - Splitter
1	Rocker Molding - LH
1	Rocker Molding - RH
1	Rocker Bracket - LH
1	Rocker Bracket - RH
2	Hardware Package - Rocker
1	Rear Fascia Surround
1	Rear Fascia Valance
2	Exhaust Pipe Extensions (dual exhaust)
1	Hardware Package - Rear
1	Installation Instructions

### Tools Required

Drill, Drill Bit: 13/64" (5mm), Rivet tool, Masking Tape, Ratchet, 7mm Socket, 12oz Caulk Gun, DOW Betaseal U400HMNC or Equivalent Adhesive, DOW Betaprime 5504G Primer

### Note:

- Carefully read and understand instructions and components completely before beginning installation.
- Wash/clean fascias and rockers before ground effects installation.
- Keep the vehicle dry and at room temperature for 24 hours after the installation to allow maximum tape adhesion.© 2018 General Motors. All rights reserved.

- **CAUTION:** Ground Effects reduces the vehicle's ground clearance. Enter driveways, bumps and ramps with care. Do not take vehicle through automatic car washes.

## Procedure

### Front Bumper Fascia Splitter

1. Raise and suitably support the vehicle. Refer to Vehicle Service Manual.
2. Make sure the front fascia is at room temperature.
3. Clean the lower portion of the front fascia.

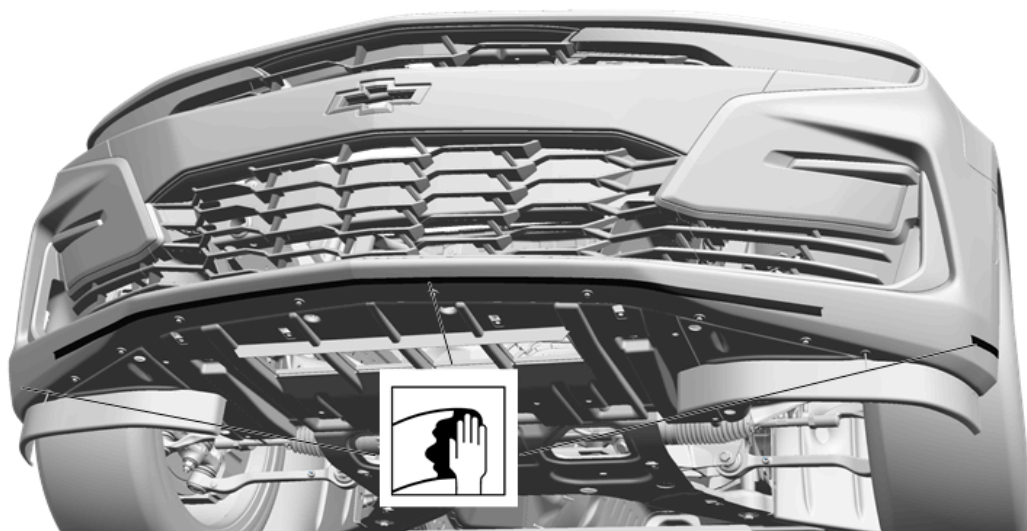

4. Clean the tape apply area with the provided alcohol wipes.

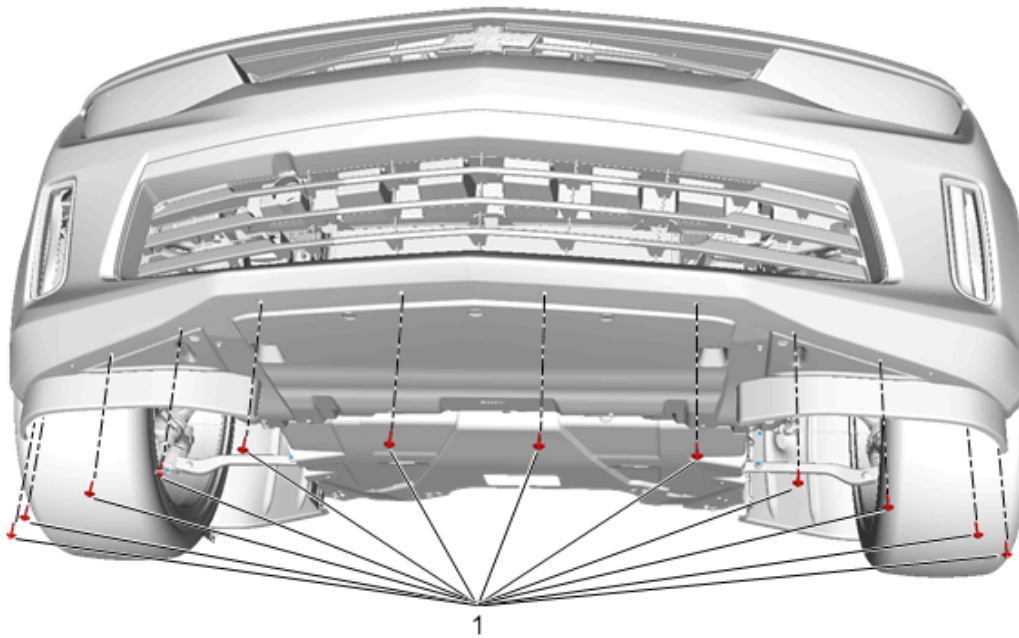

5. Remove and discard the 12 screws (1) along the front under side of the fascia.

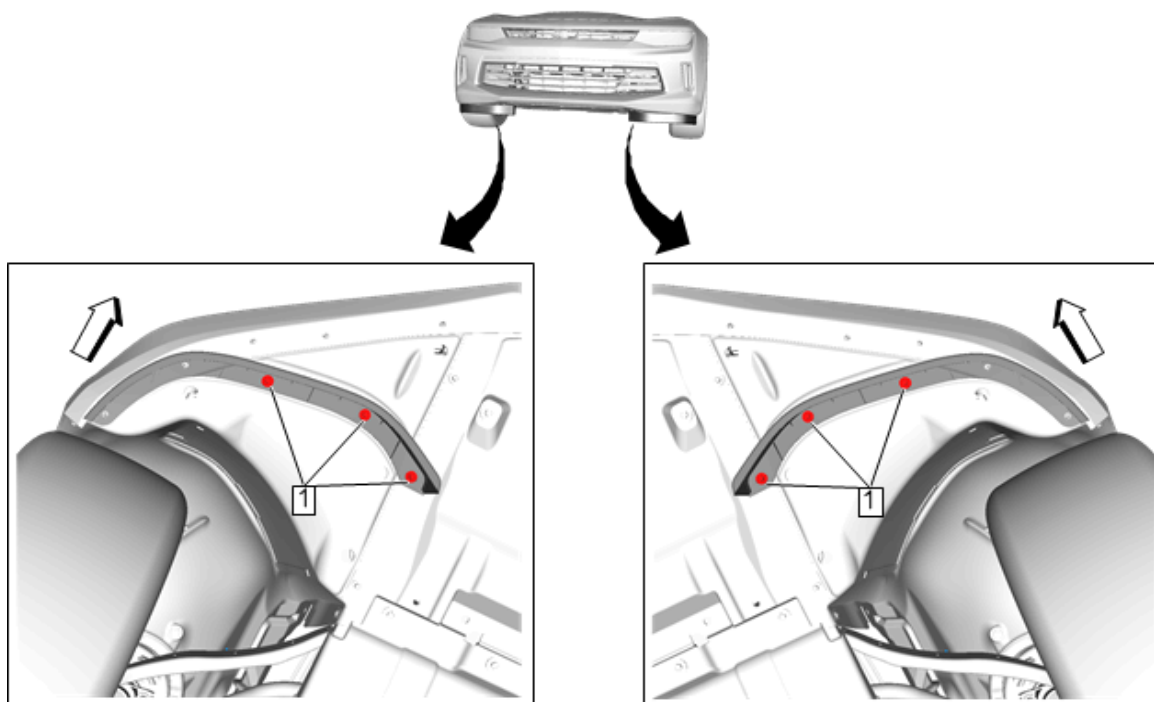

6. Slightly loosen the remaining air deflector screws (1).

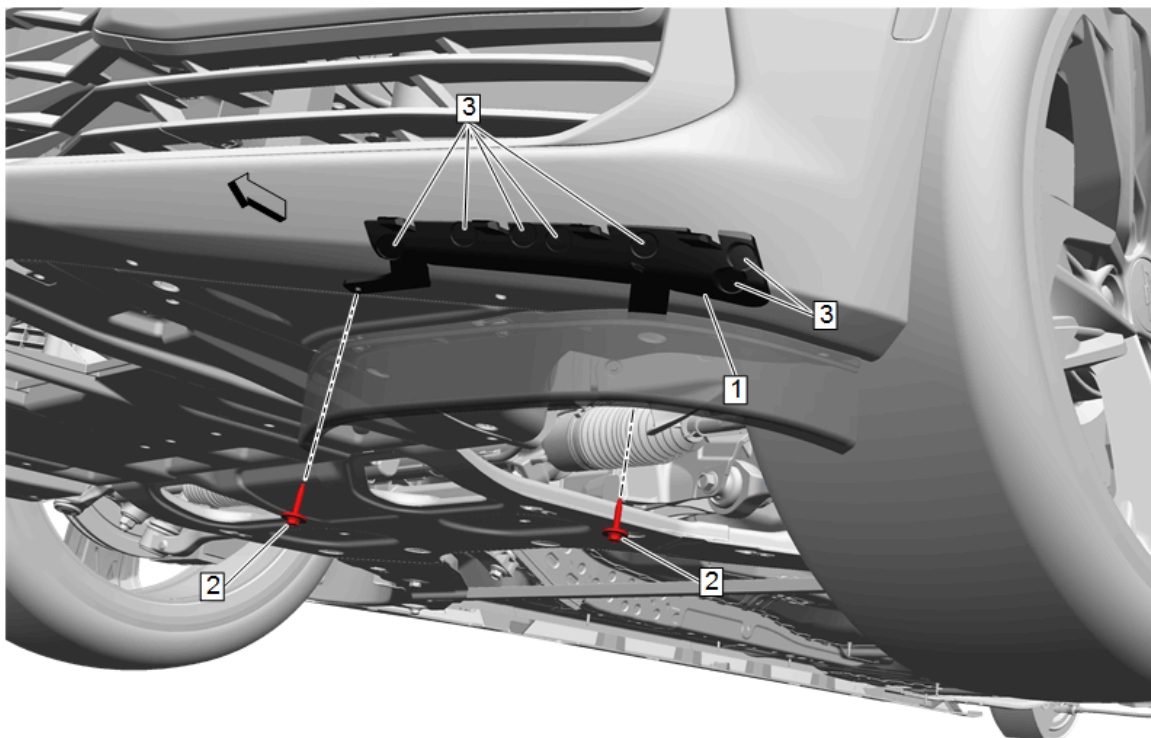

**Caution:** Use the correct fastener in the correct location. Replacement fasteners must be the correct part number for that application. Fasteners requiring replacement or fasteners requiring the use of thread locking compound or sealant are identified in the service procedure. Do not use paints, lubricants, or corrosion inhibitors on fasteners or fastener joint surfaces unless specified. These coatings affect fastener torque and joint clamping force and may damage the fastener. Use the correct tightening sequence and specifications when installing fasteners in order to avoid damage to parts and systems.

7. Position the LH splitter bracket (1) against the fascia as shown and secure in place with 2 screws (2) temporarily.

**Caution:** Always check scale, size and position of all templates before drilling. Failing to do so may cause damage to the vehicle, misalignment of components or the inability to install the accessory.

8. Using a 13/64" (5mm) drill bit, drill 7 holes at the dimple locations (3).

**Caution:** To avoid damaging components behind, limit drill depth when drilling into the fascia. Do not plunge the drill deep into the surface.

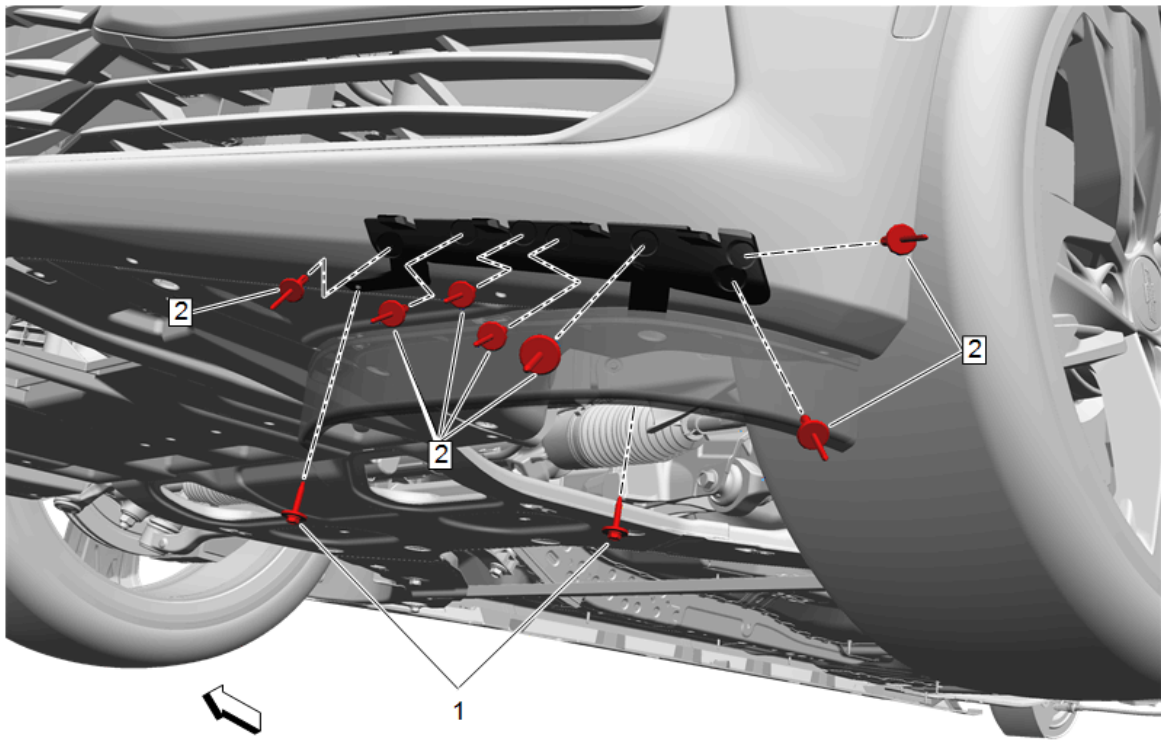

9. Fasten rivets (2) into the drilled holes and remove the lower screws (1).

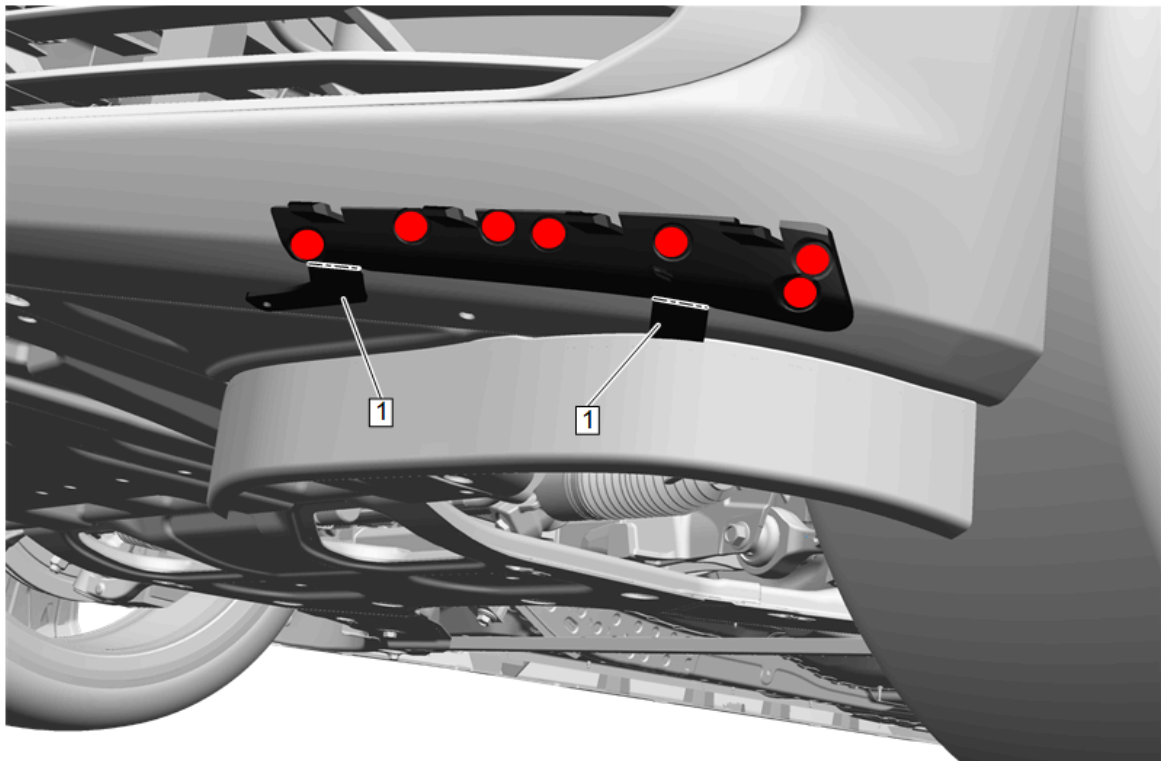

10. Break-off locating tabs (1) as shown and discard.

11. Repeat bracket installation for the other side.

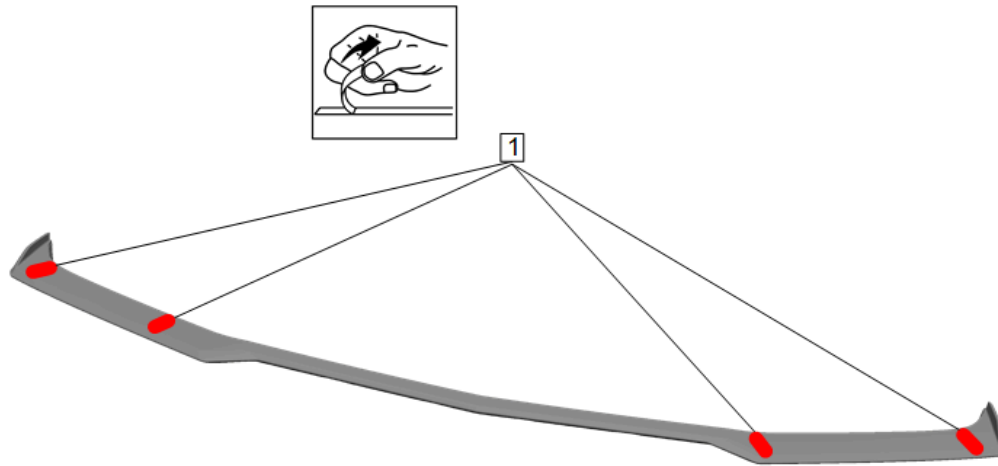

12. On the front splitter, fold back the ends of the tape backing (1) so they stick out above the top edge.

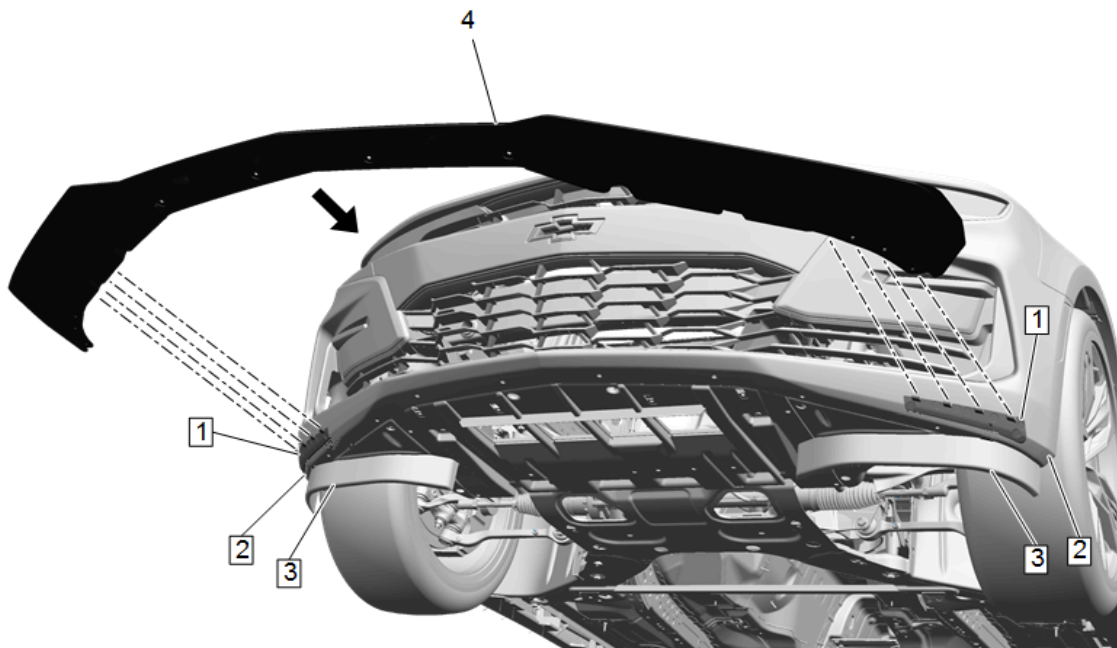

13. Slide the front splitter (4) onto brackets (1) in a fore/aft direction, positioning the bracket tabs in the slots on the splitter. Push splitter onto brackets until the tabs snap into place.

Note: The front splitter should lie between the fascia (2) and the LH/RH air deflectors (3) underneath the fascia.

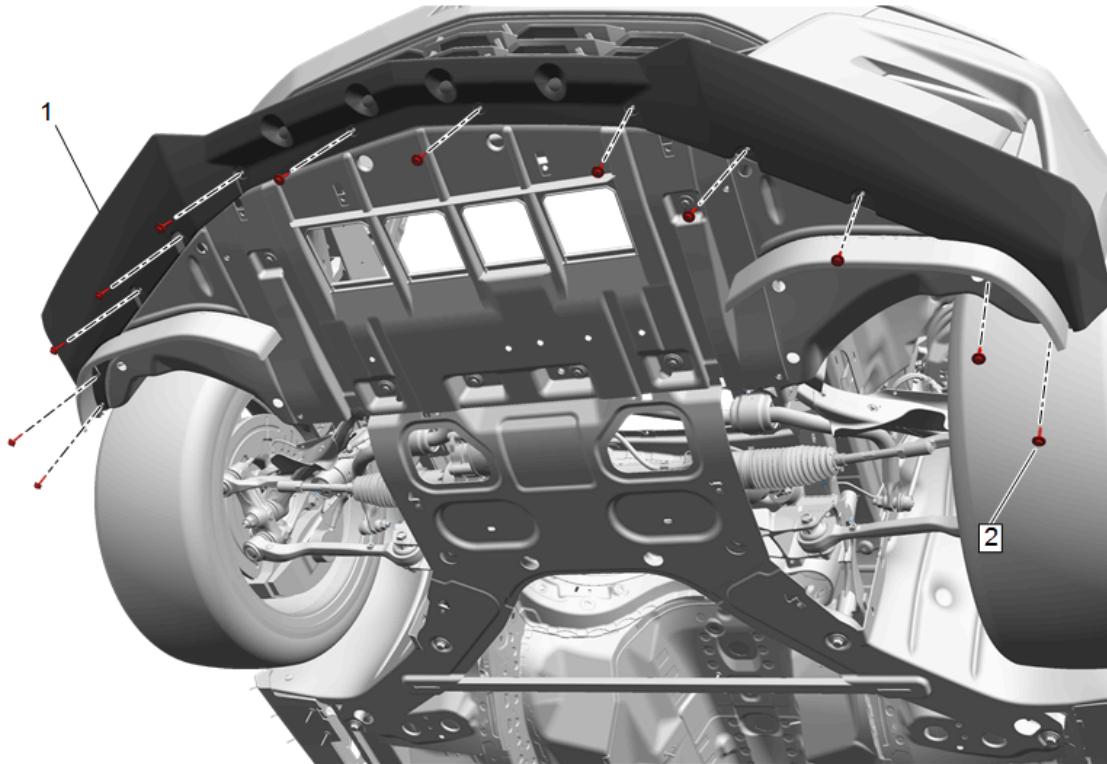

14. Fasten the splitter (1) loosely underneath the fascia with the provided 12 screws (2).
15. Making sure that the front splitter is centered on the front fascia, and starting at the center, carefully remove the backing off the tape strips. Apply strong pressure all along the front splitter to make sure the tape adheres to the fascia. Reach one hand behind the fascia to apply pressure to the tape from behind as needed.

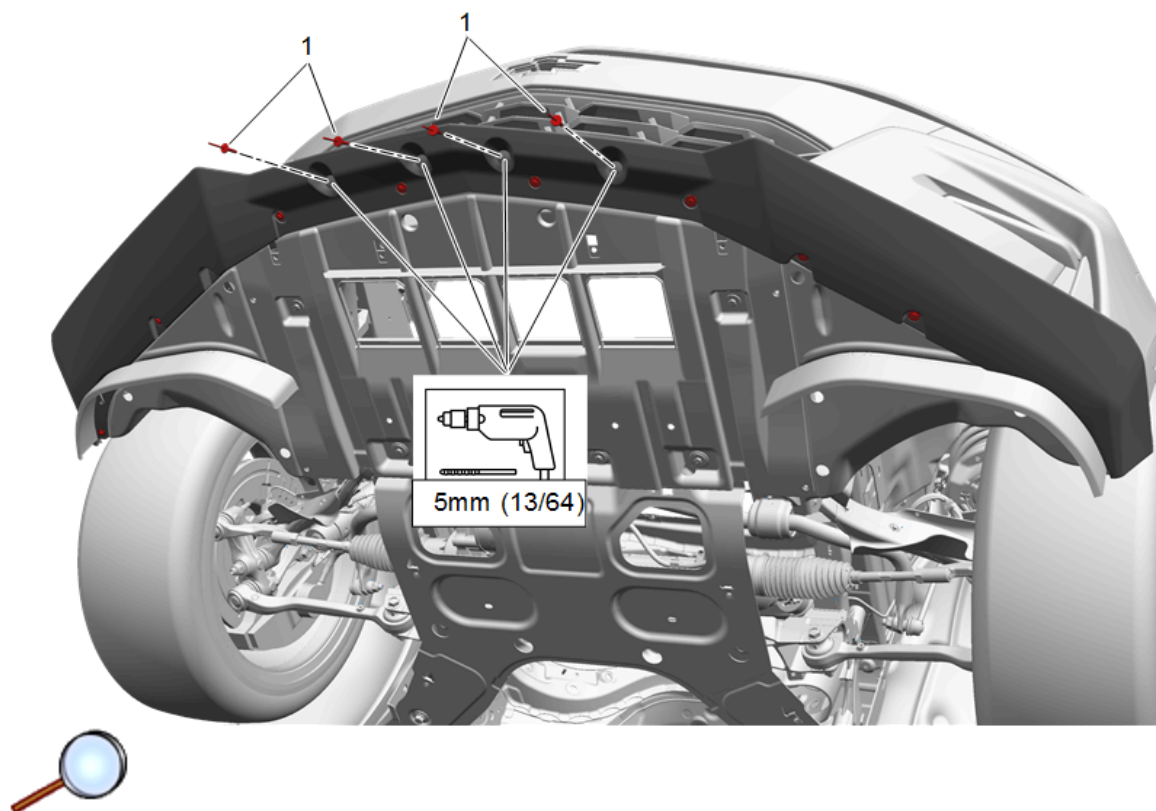

**Caution:** Always check scale, size and position of all templates before drilling. Failing to do so may cause damage to the vehicle, misalignment of components or the inability to install the accessory.

16. On the underside of the front splitter in the designated areas drill four 13/64" (5mm) holes through the front splitter and into the front fascia.
17. Install rivets (1) into the drilled holes.
18. Working from the center outward, tighten the 12 screws that fasten the front splitter to the fascia. Apply pressure to the splitter to reduce gaps as needed.

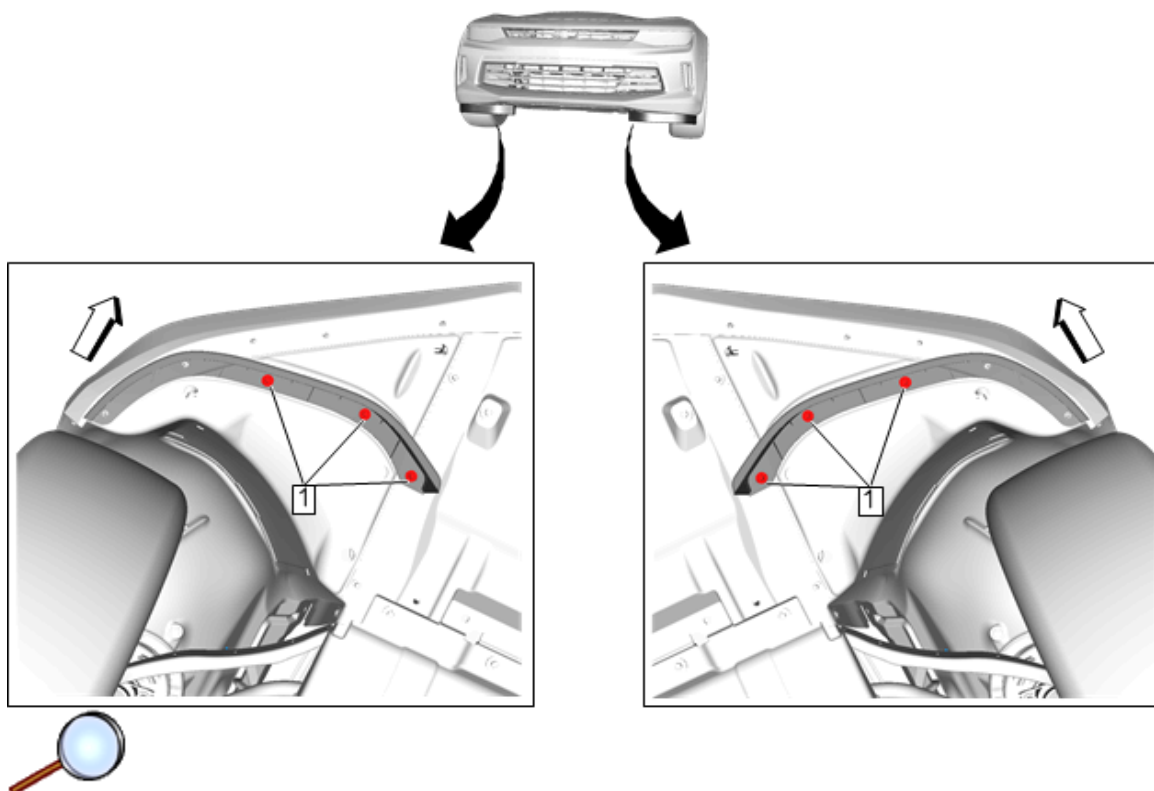

19. Tighten the remaining air deflector screws (1).
20. Inspect the front splitter for proper install. Adjust and tighten lower screws as needed.
21. Lower the vehicle.

#### Rocker Moldings

1. Raise vehicle safely on hoist. Make sure the hoist lift points do not cover the underside of the rocker moldings.
2. Clean the rocker moldings.

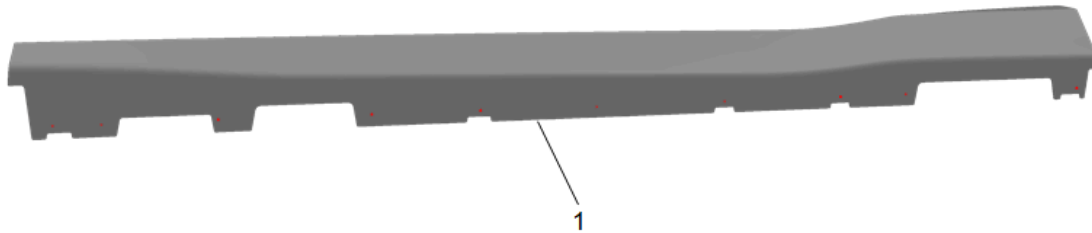
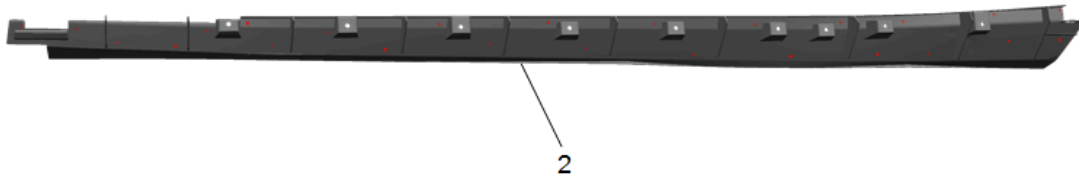

3. Use a visible marker or grease pen to mark the 25 drill dimple locations on the rocker bracket (2). Also mark the 10 dimples on the bottom of the outer rocker molding (1).

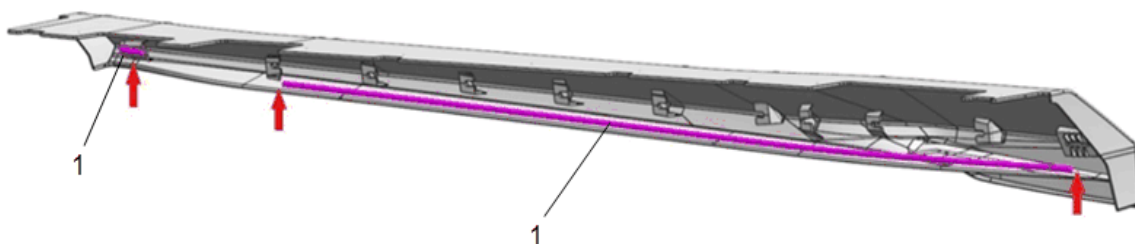
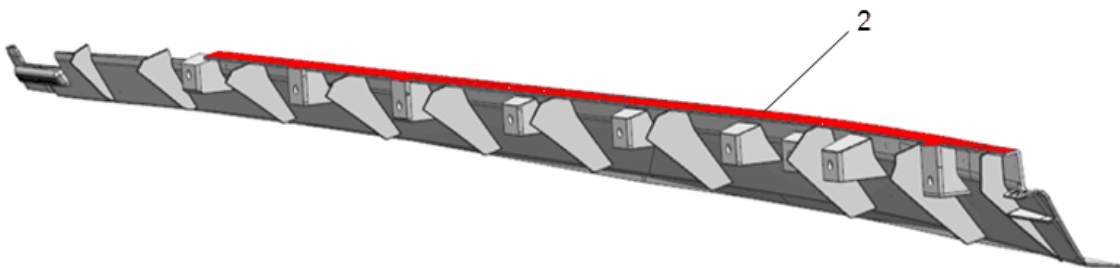

4. Apply 5504G primer to the top flat surface of the brackets (2) and to the undersides of the rocker panels (1) at the pictured locations. Holding the rocker panels upside-down will help.

Note: This primer is to be added in addition to the existing primer already on the parts. Allow primer to dry for 5 minutes. \*Avoid unwanted drips of primer on show surfaces.

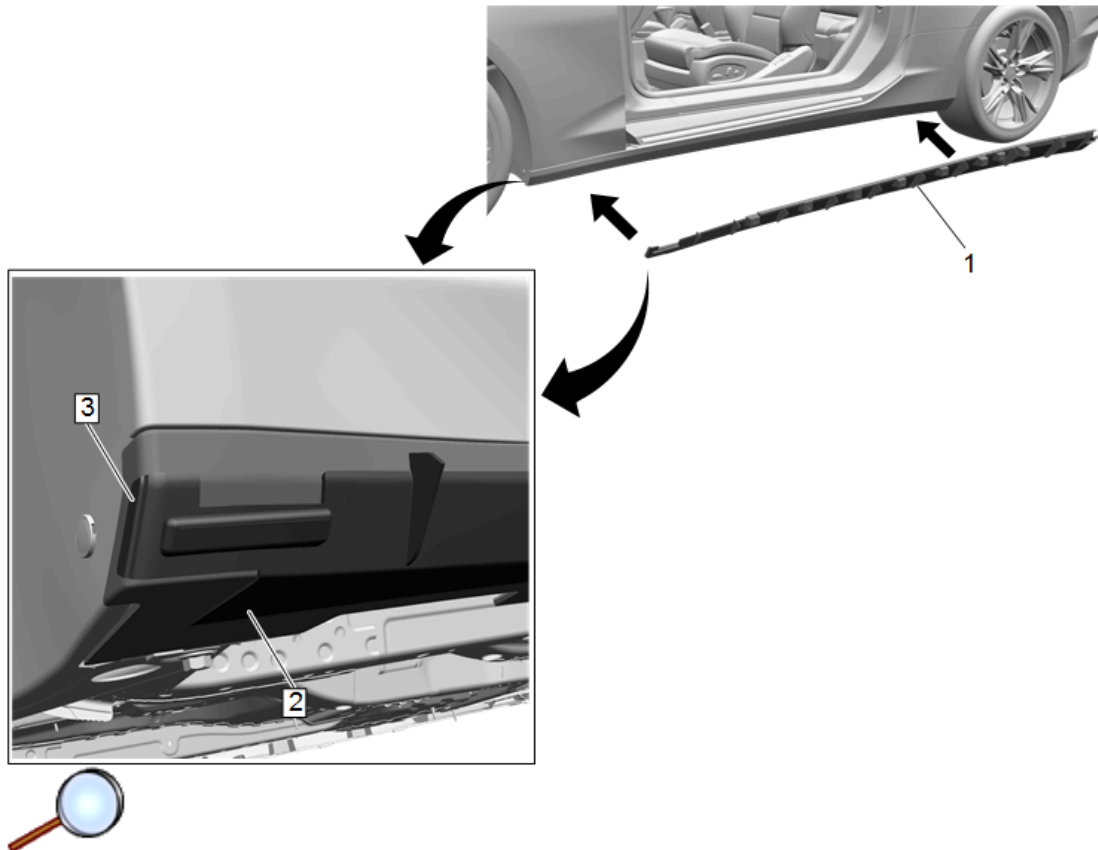

5. Position the LH mounting bracket (1) to the vehicle bodyside using the front locating tab (3) and the shape of the bodyside for reference. The horizontal surface of the bracket (2) should be flat against the underside of the vehicle.
6. Temporarily tape the bracket firmly in place.

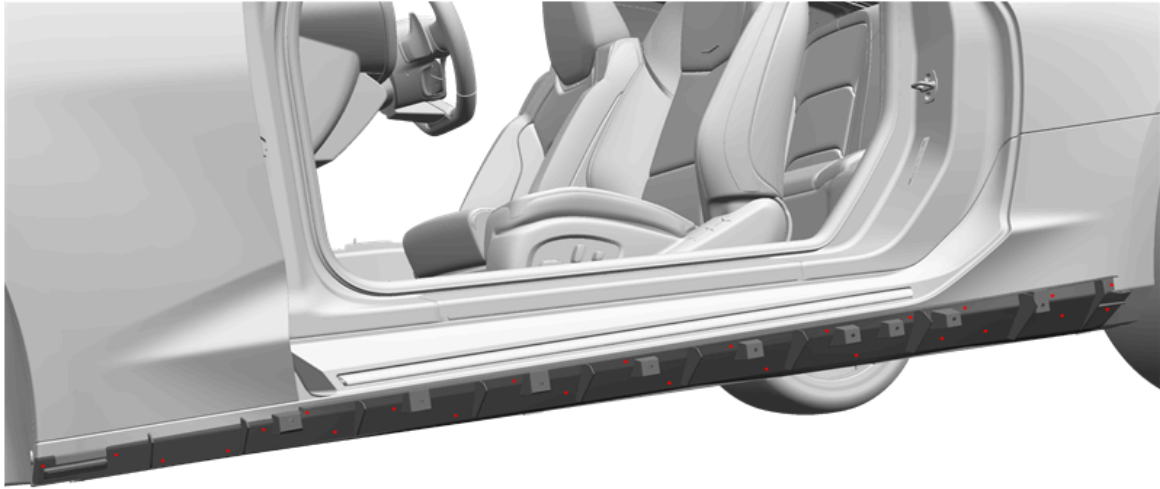

**Caution:** Always check scale, size and position of all templates before drilling. Failing to do so may cause damage to the vehicle, misalignment of components or the inability to install the accessory.

7. Drill 25 holes, 13/64" (5mm) at the marked dimple locations.

**Note:** Drill shallow holes through the plastic only to avoid scraping the underbody. Clean off any burrs.

**Note:** It may be easier to drill a few holes and install rivets (front, middle, and rear) before drilling the rest of the holes.

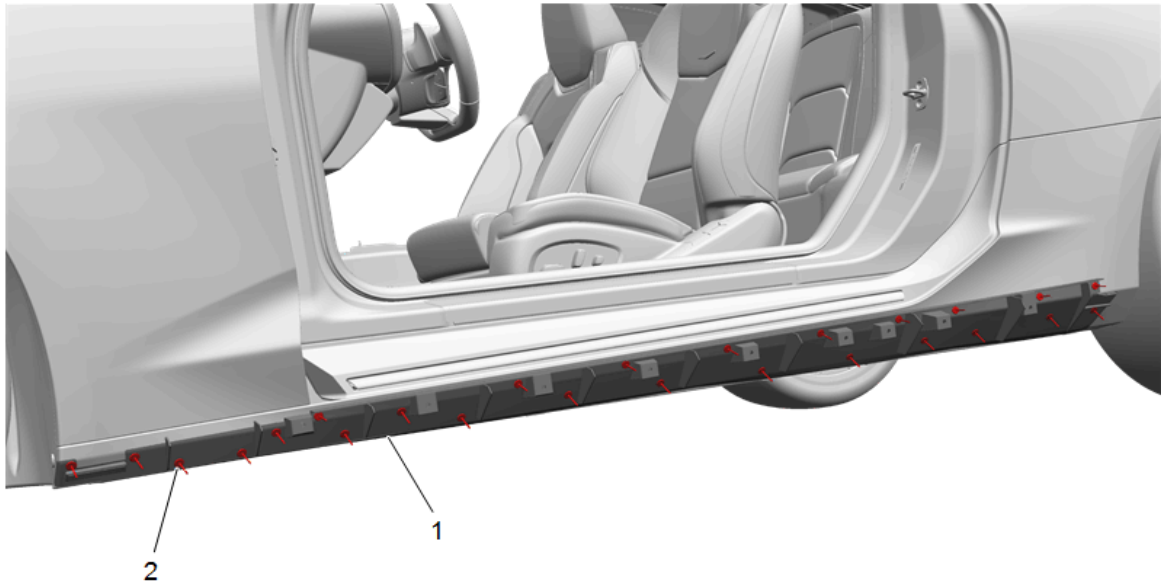

8. Attach the mounting bracket (1) to the bodyside with 25 rivets (2). Remove any tape used to hold the bracket to the vehicle.

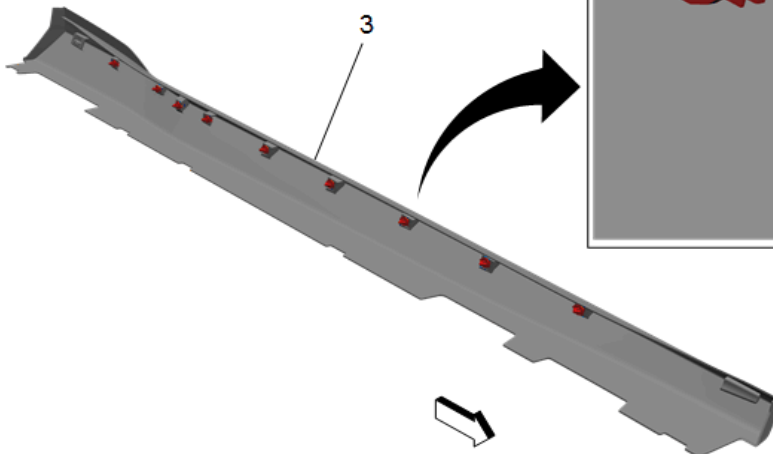
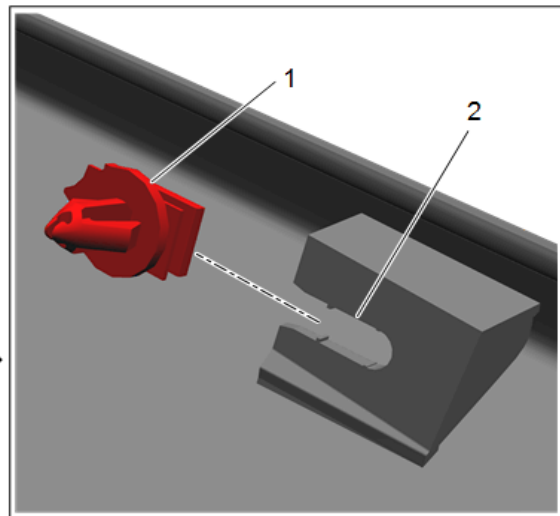

9. Install provided W-clips (1) into doghouses on the LH rocker cover (3). Make sure they are centered in their slots (2).

10. To aid with alignment, apply small pieces of masking tape on the outside of the rocker cover to mark where the W-clips are.

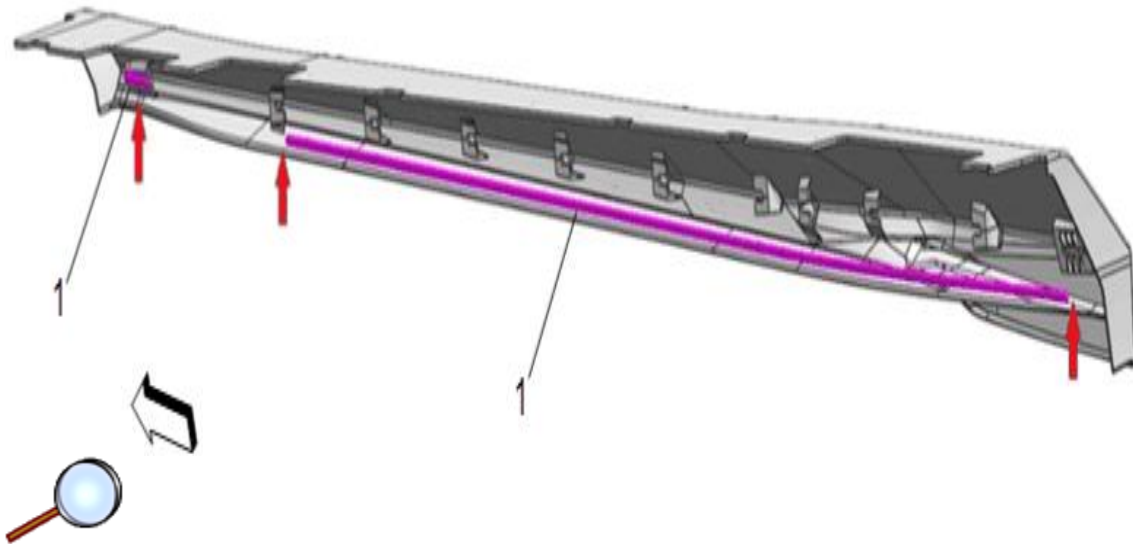

11. Apply a 3/8" (10mm) bead of U400 urethane (1) on the underside of the cover. Apply a bead of urethane on the front cover doghouse. For ease, position the rocker upside-down while applying urethane. Unwanted urethane smears can be wiped clean using a 50/50 mixture of rubbing alcohol and water.

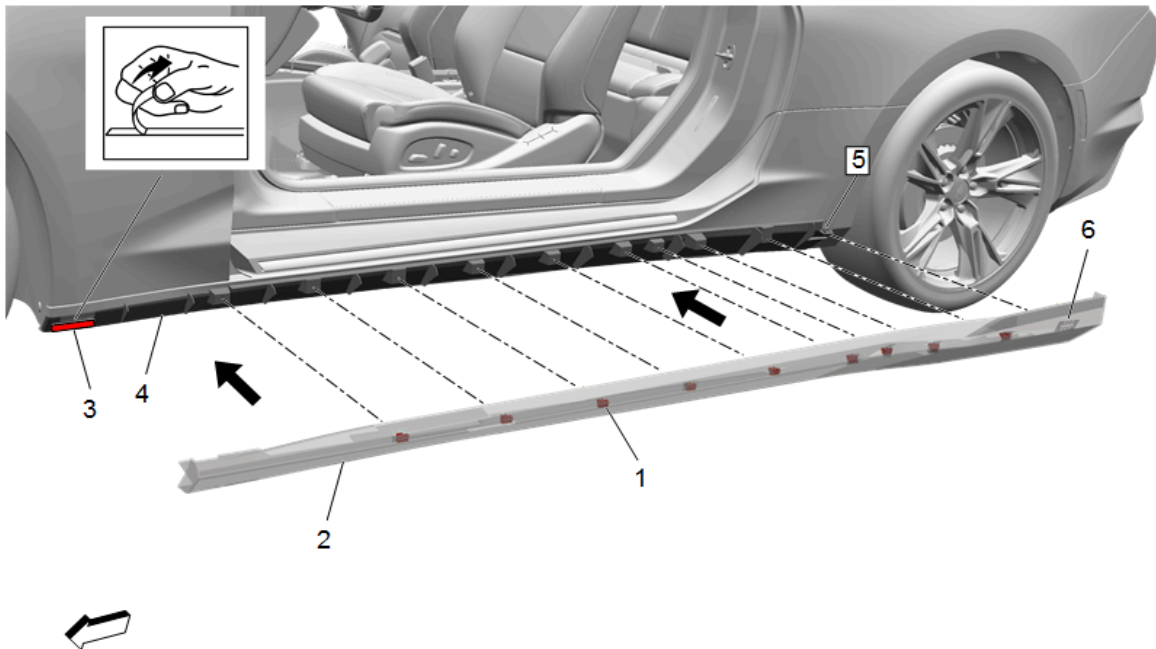

12. Remove the tape backing (3) on the front of the bracket (4).
13. Align the slot (6) at the rear of the rocker cover to the snap tab (5) on the bracket and snap it into place.
14. Continue to install the rocker cover (2) to the bracket by lining up the clips (1) with their holes and applying strong force, making sure all clips 'click' into their holes on the bracket (4).
15. Remove any excess urethane from painted show surfaces using a 50/50 mixture of rubbing alcohol and water.

16. Press firmly on the front of the cover to help the tape and the urethane adhere at the front doghouse.
17. Inspect the fit along top edge of the rocker cover and temporarily use tape to hold the rocker tight to the body as needed as the urethane cures.
18. Allow urethane to set for 30 minutes prior to proceeding. Begin installation of the opposite rocker molding while the urethane cures.

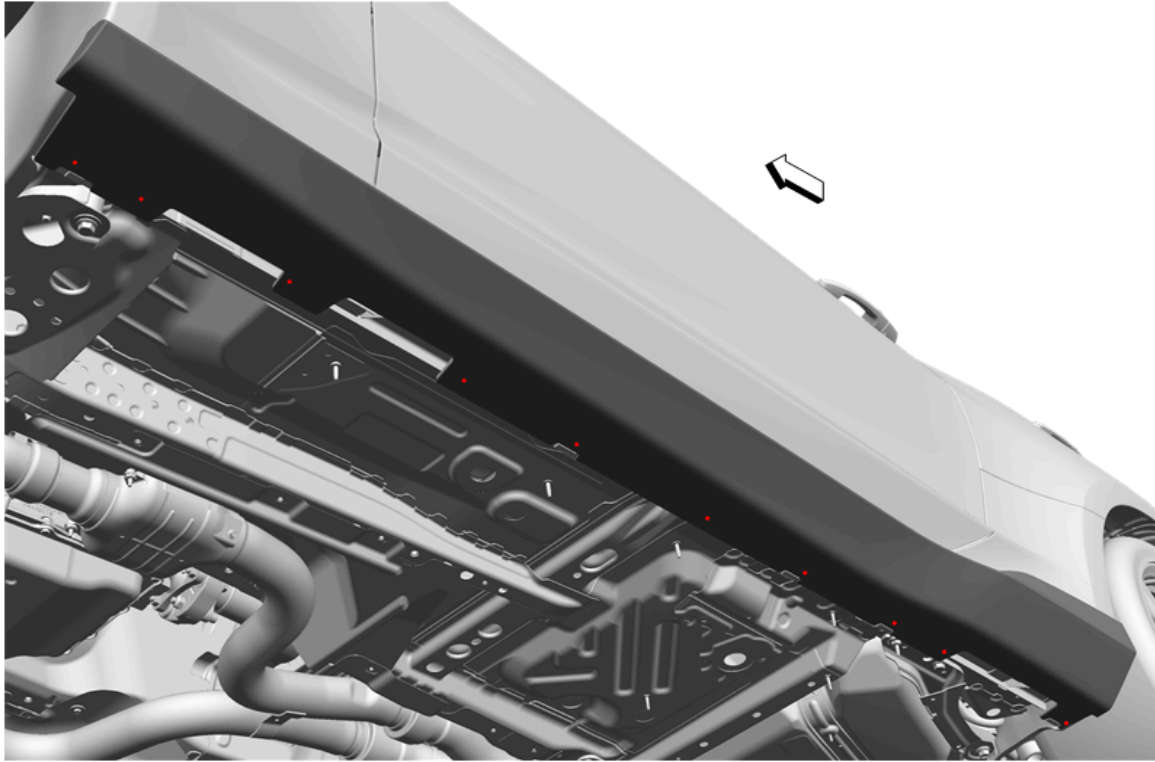

**Caution:** Always check scale, size and position of all templates before drilling. Failing to do so may cause damage to the vehicle, misalignment of components or the inability to install the accessory.

19. At the marked dimple locations, drill ten 13/64" (5mm) holes along bottom of the rocker cover.

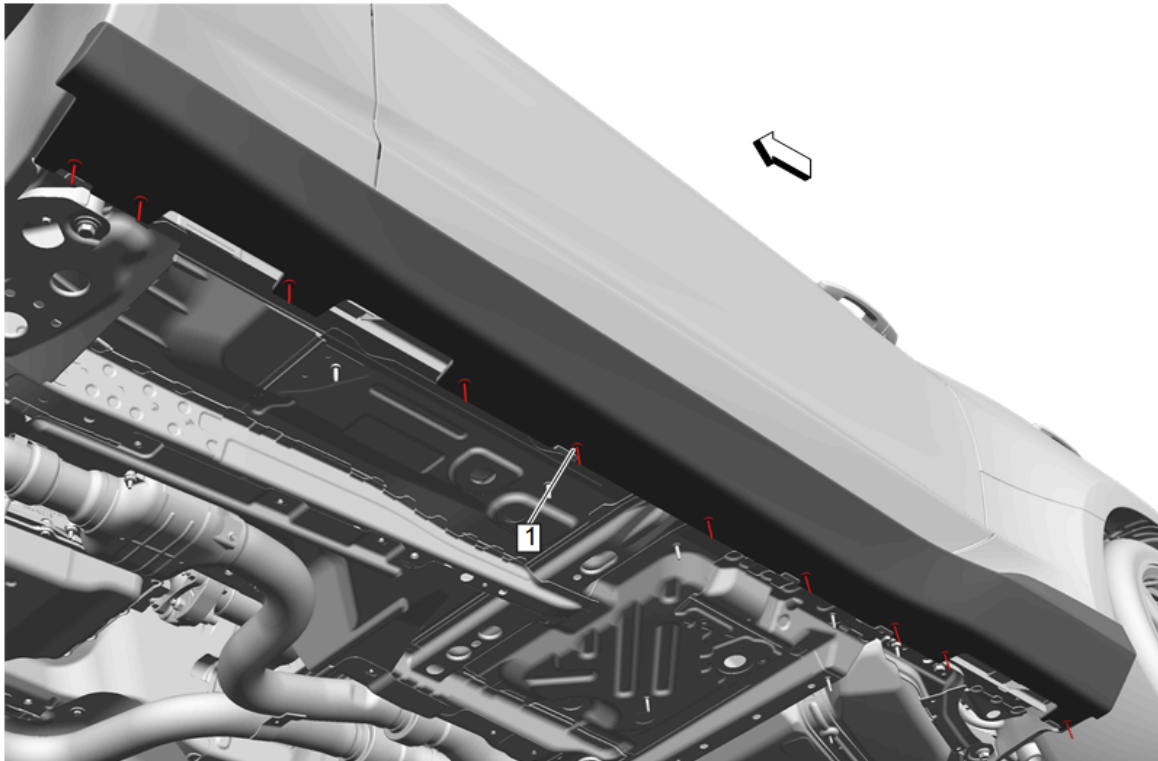

20. Install 10 rivets (1) in the drilled holes.
21. Make sure the ROCKER OUTER is fitting properly to the car in all areas.
22. Repeat rocker installation for the other side.

#### Rear Fascia

1. Remove the rear bumper fascia. Refer to Vehicle Service Manual.
2. Place the fascia down on a clean, protected work surface to avoid scuffing and scratching.

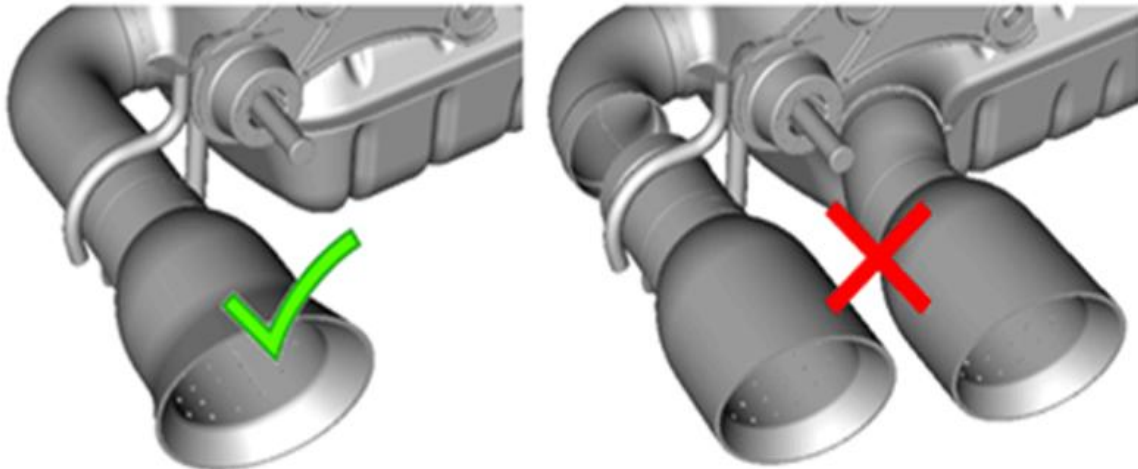

Note: Steps 3 - 6 are for regular DUAL exhaust vehicles ONLY. (1 exhaust tip per side.)

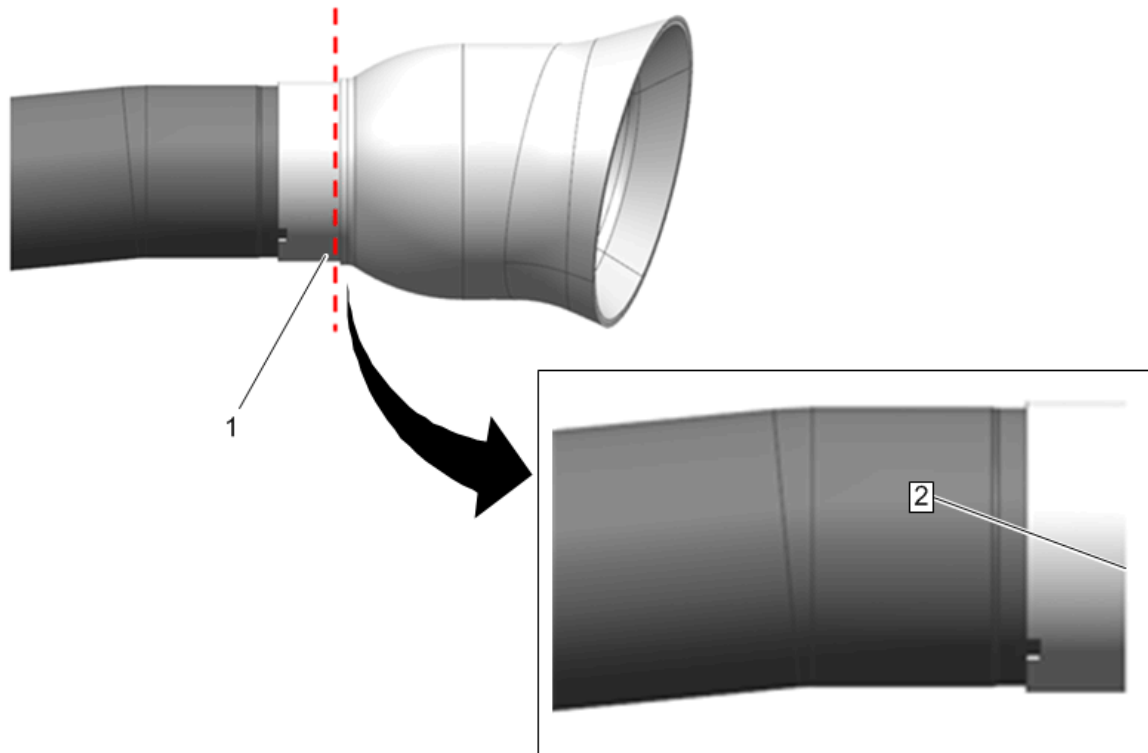

3. Cut through the chrome exhaust tip with a saw at the designated location (1), making sure to leave as much straight length of chrome pipe as possible. Clean and deburr the cut end of the pipe (2).

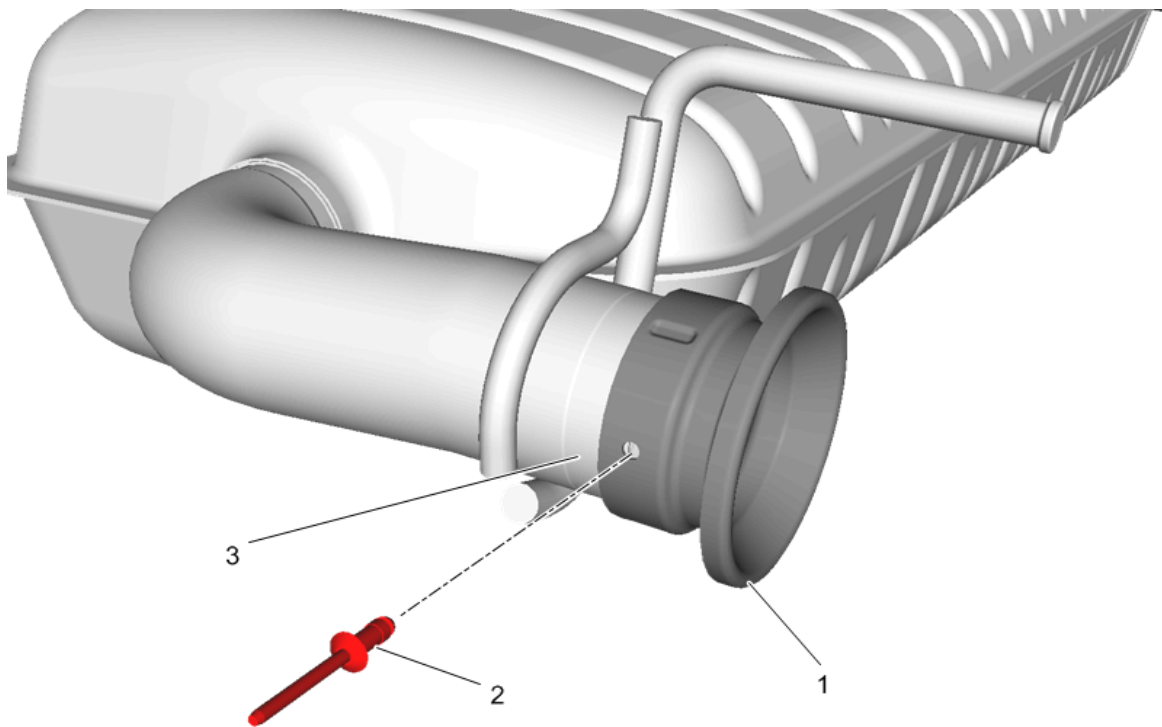

4. Press the EXHAUST RING (1) onto the cut end of the pipe (3). Insert it as far as it will go. Take care not to scratch the black paint on the face of the EXHAUST RING. Make sure the rivet hole is facing outward.

© 2018 General Motors. All rights reserved.

5. Drill a 11/64" (5mm) hole into the exhaust pipe where the exhaust ring hole is. Install provided rivet (2).
6. Repeat steps 2 - 5 for the opposite side.
7. Remove the rear bumper fascia energy absorber. Refer to Vehicle Service Manual.
8. Separate the rear bumper lower fascia from the rear bumper fascia. Refer to Vehicle Service Manual.

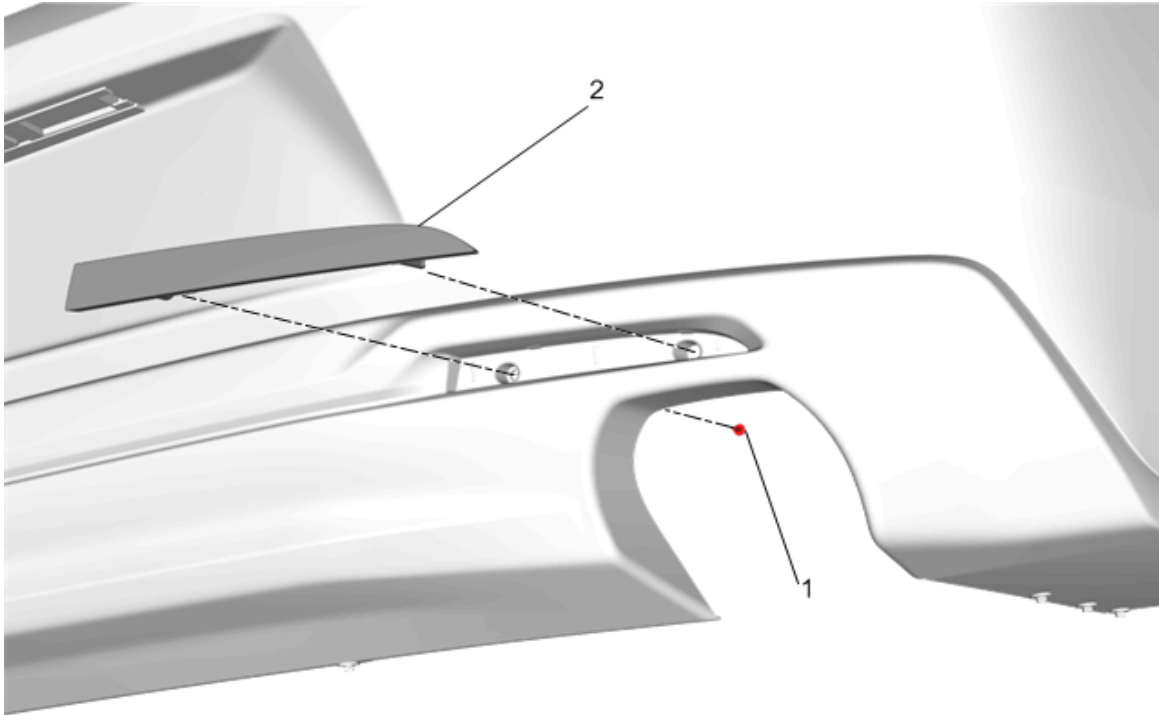

9. Remove the screws (1) and reflectors (2) from the rear bumper lower fascia and transfer them to new accessory valance. Tighten the screws to 2.5 N.m (22 lb in).

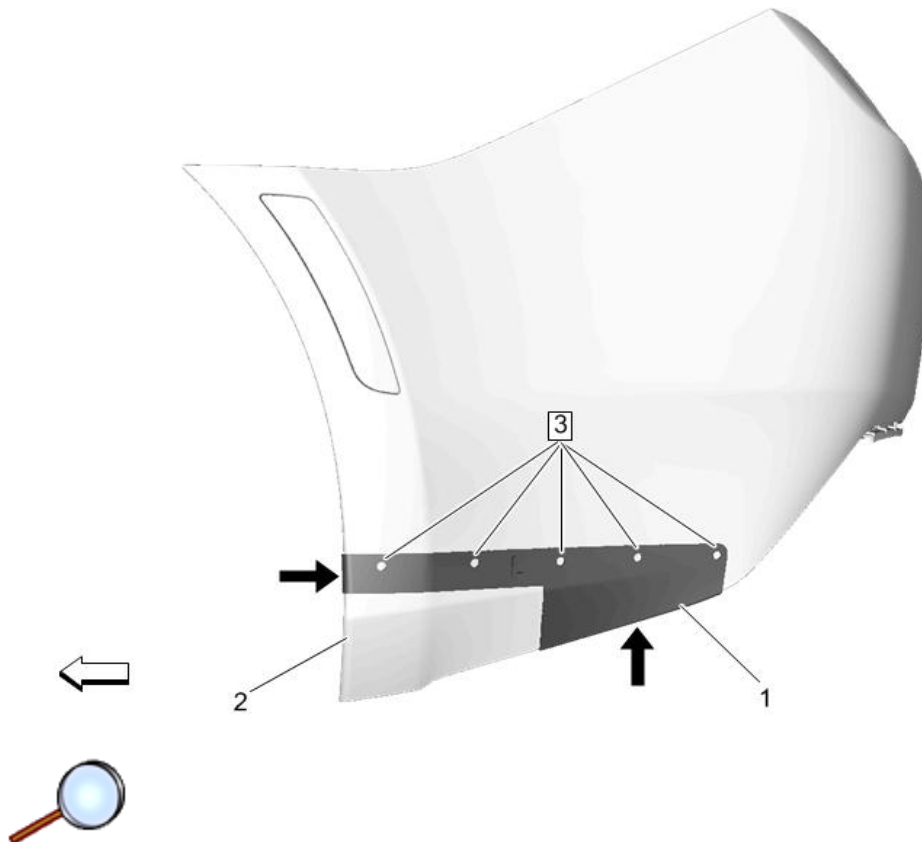

10. Position a supplied plastic template (1) on the side of the rear bumper (2). Use the front and bottom edges to align it. Tape it into position.
11. Drill (5) 9/32" (7mm) holes (3) through the rear bumper at the locations defined by the template.
12. Remove the template and remove any debris.
13. Drill holes on the opposite side of the rear bumper using the other supplied template and similar procedure.

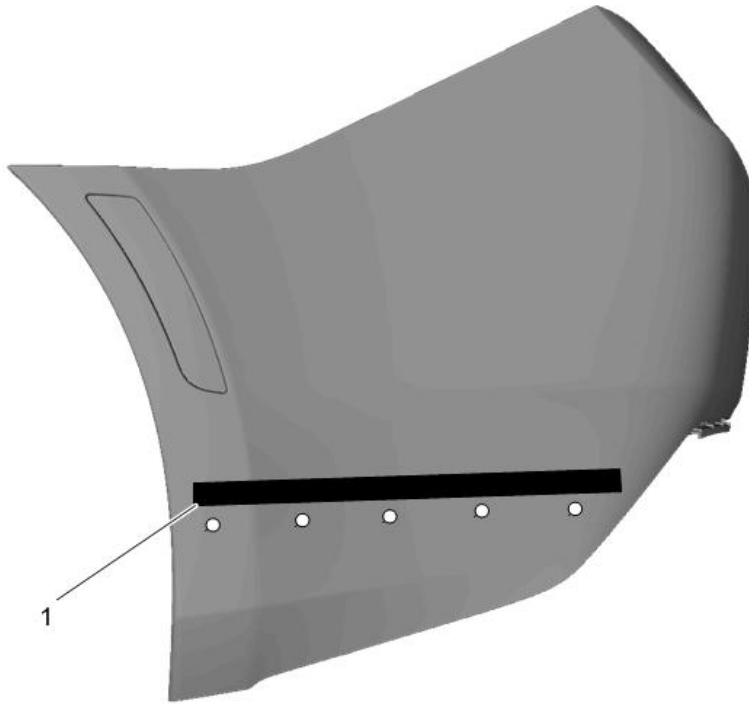

14. Add temporary protective tape (1) above the holes in the rear bumper on both sides to prevent scratching.

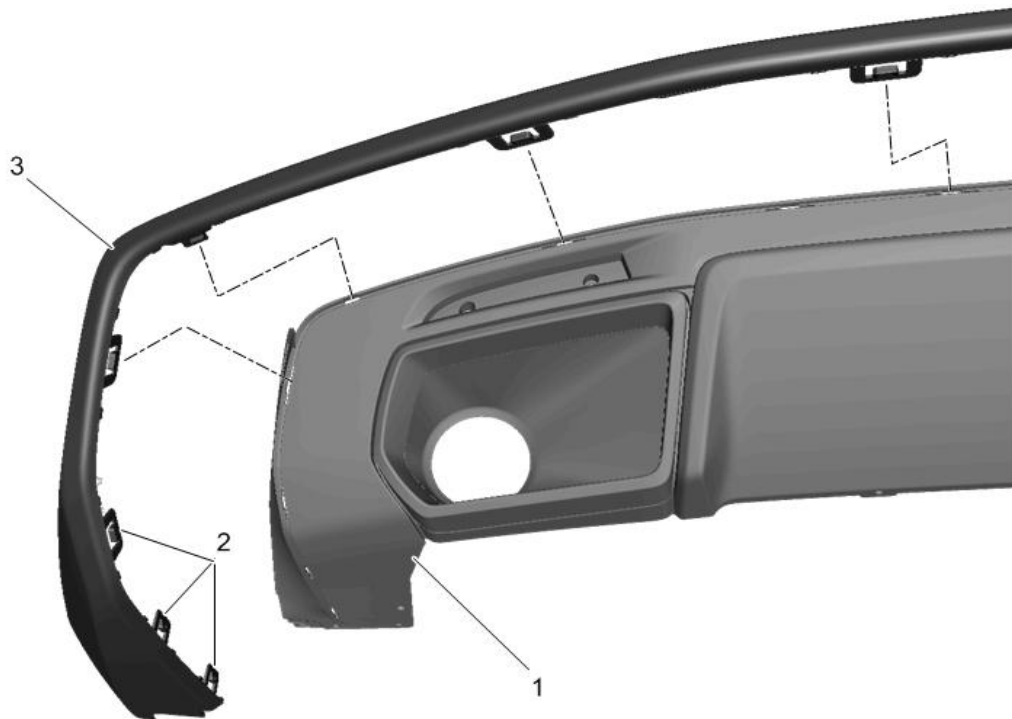

15. Attach the ACCESSORY SURROUND (3) to the ACCESSORY VALANCE (1). Do not attach the last 3 tabs (2) on each side yet.

16. Install ACCESSORY REAR ASSEMBLY to the rear bumper. Attach parts with care. Be careful not to bend attachment tabs as parts are assembled.

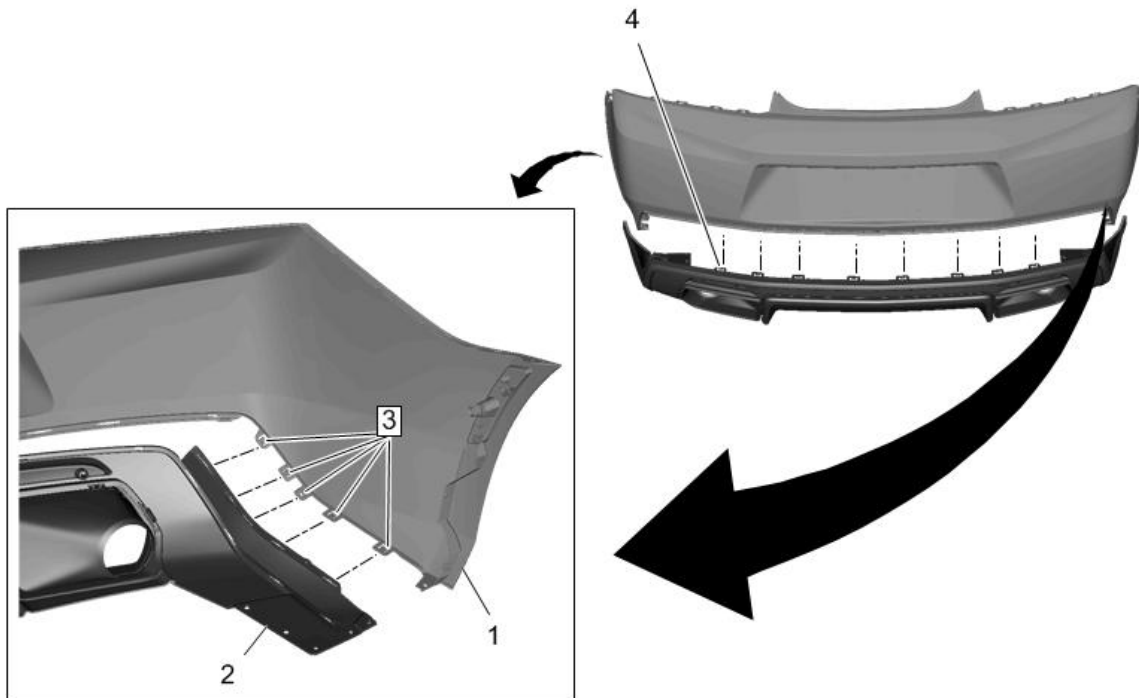

16.1. Start with the rear tabs (4).

16.2. Insert the sideways tabs (3) from the rear bumper (1) into the accessory valance (2).

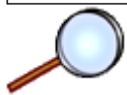
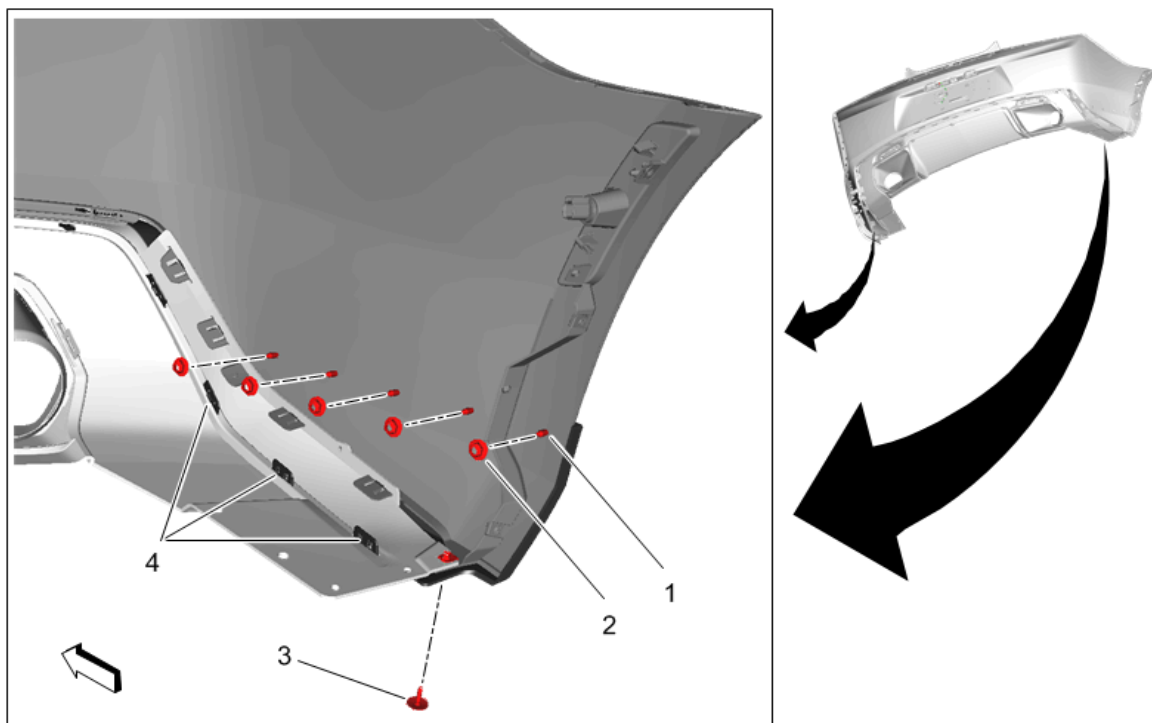

16.3. Install the corner screw (3).

© 2018 General Motors. All rights reserved.

- 16.4. Insert the plastic posts (1) on the inside of the accessory surround into the drilled holes in the rear bumper.
- 16.5. Insert the last 3 vertical tabs (4) from the accessory surround onto the accessory valance.
- 16.6. Make sure that all tabs are firmly and properly inserted.
- 16.7. Remove the protective tape on the sides of the rear bumper from step 14.
- 16.8. Fasten the spin nuts (2) onto the plastic posts of the accessory surround. Make sure the gap between parts is closed. Repeat for the other side.
17. Reinstall energy absorber to rear bumper assembly. Reinstall any electrical wiring that was removed.

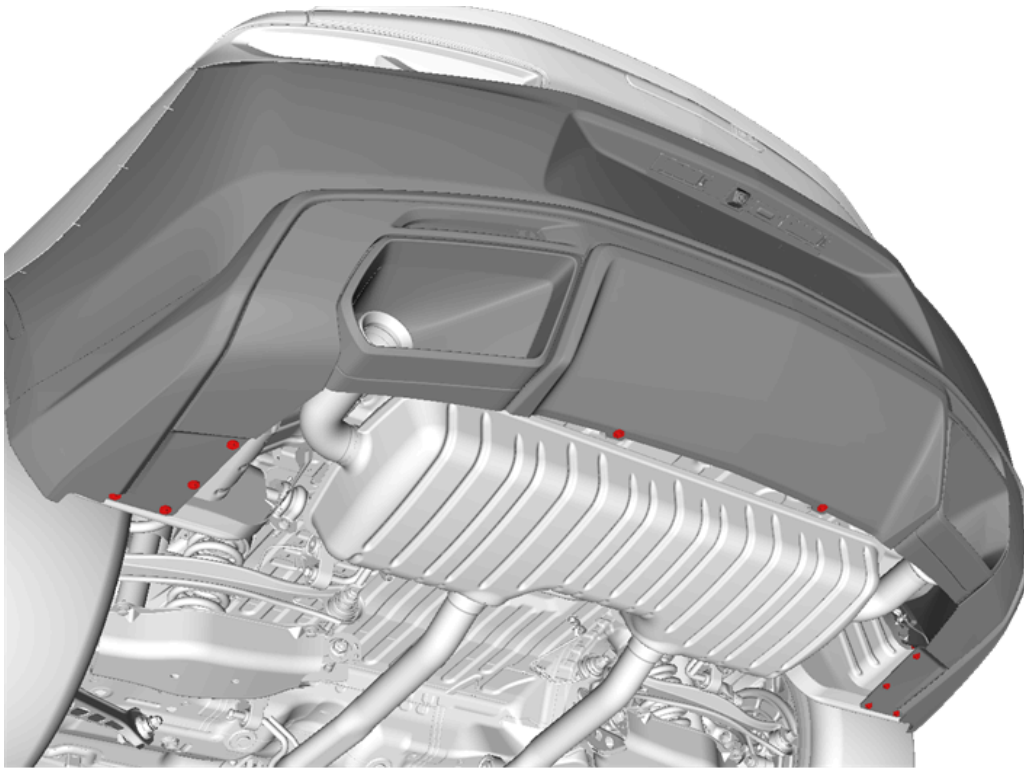

18. Reinstall rear bumper fascia assembly to the vehicle, make sure to attach all fasteners. Refer to Vehicle Service Manual.
19. Inspect installation for proper look and fit.
20. Lower the vehicle.