

Rear Mud Guard Package Installation

Installation Instructions Part Number

84110087

Note: Please read instructions thoroughly before starting.

Rear Mud Flap Kit Contents

Qty	Description
1	Left Hand Splash Guard
1	Right Hand Splash Guard
2	M4.2 x 20 Screw with Washer
2	M4.2 U-nut
4	Rivet
1	Instruction Sheet

Tools Required

- T15 Screw Driver
- Drill
- 13/64" (5.0mm) Drill Bit
- Rivet Gun
- Pliers
- Clean Cloth/Rag

Installation Procedure

Note: If the wheel liner and the splash guards are being installed at the same time. Wheel Liner must be installed first and then the splash guard.

Note: Do not use power tools to install fasteners.

1. Remove the rear wheel and tire. Refer to Vehicle Service Manual.
2. Clean and degrease body panel where splash guards will be located.

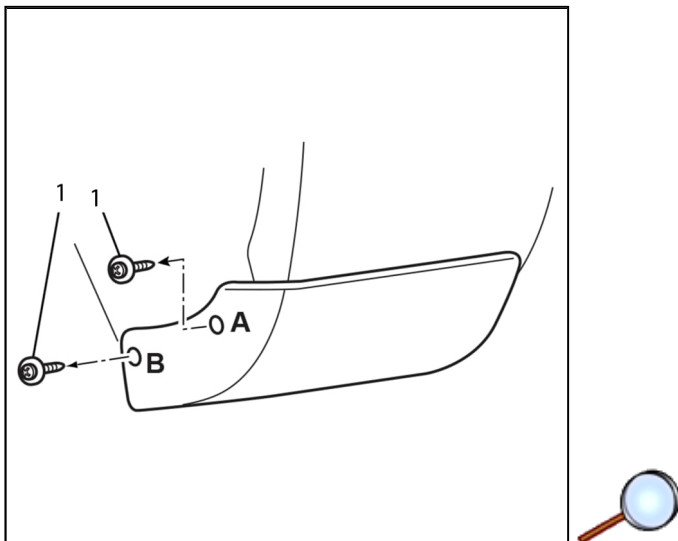

3. Remove existing screws (1) at locations (A) and (B). Retain fasteners.

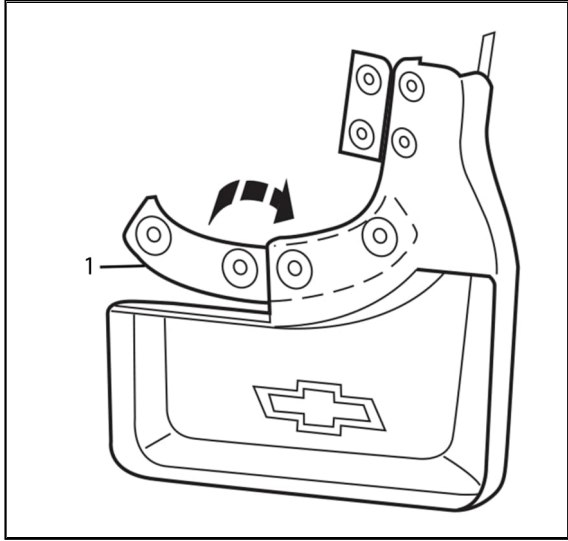

4. Fold lower living hinge (1).

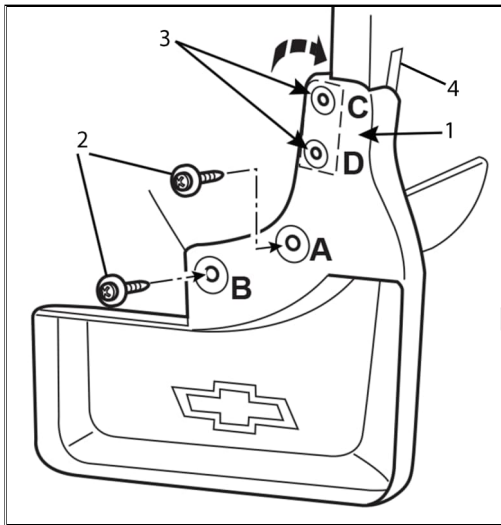

Caution: Use the correct fastener in the correct location. Replacement fasteners must be the correct part number for that application. Fasteners requiring replacement or fasteners requiring the use of thread locking compound or sealant are identified in the service procedure. Do not use paints, lubricants, or corrosion inhibitors on fasteners or fastener joint surfaces unless specified. These coatings affect fastener torque and joint clamping force and may damage the fastener. Use the correct tightening sequence and specifications when installing fasteners in order to avoid damage to parts and systems.

5. While keeping the lower living hinge folded (1), place splash guard to vehicle, make sure red tape pull tab (4) is accessible, then fold splash guard top living hinge to sandwich splash guard to body side outer flange and install retained fasteners (2) at locations (A) and (B). Take care to eliminate gaps.
6. While keeping living hinge (1) folded and pinched around body side outer, drill through splash guard hole (3) locations (C) and (D). Using a 13/64" (5.0mm) bit, drill through splash guard and wheel liner.

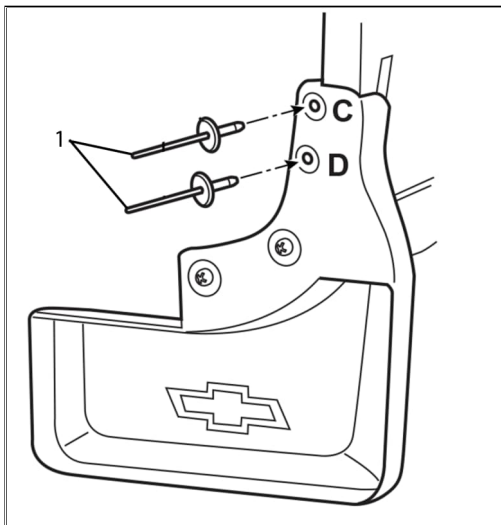

7. Install supplied rivets (1) in newly drilled holes at (C) and (D). Living hinge should firmly pinch to body side outer flange.

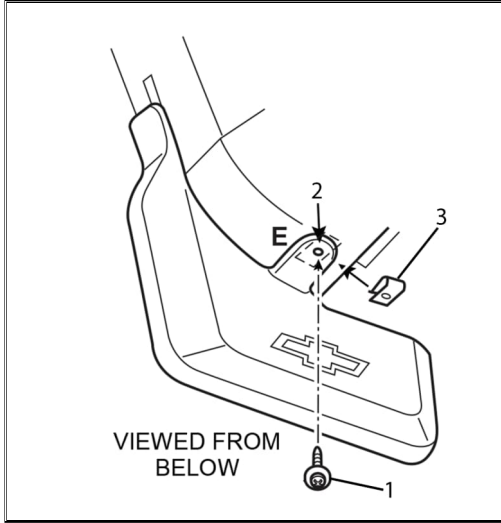

8. Using a 13/64" (5.0mm) bit, drill through splash guard and stone protector (2) at location (E).
9. Install supplied M4.2 screw w/ washer (1) and U-nut (3) at location (E). The U-nut should be installed as a nut above the body side outer.

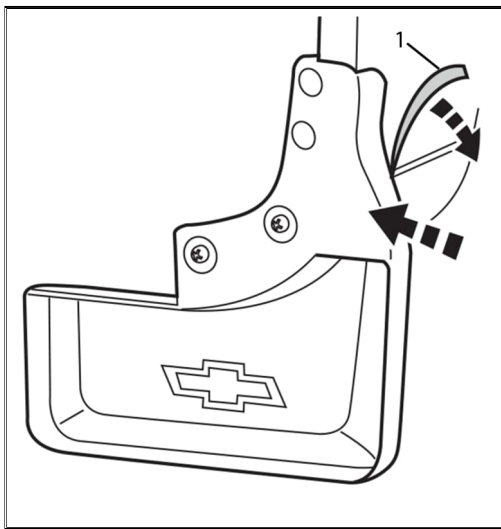

10. Remove tape liner (1) and apply firm pressure to the splash guard along the tape line to adhere the tape to the fender. Hold the firm pressure for a minimum of 60 seconds to properly adhere the tape.
11. Install the rear wheel and tire. Refer to Vehicle Service Manual.
12. Repeat for other side.
13. Guards can be cleaned with any commercially available cleaner.

Note: Maximum torque on M4.2 screw is 3.0 N•m.