

Document ID: 5090721

Body Emblem Package Installation

[Installation Instructions Part Number](#)

84188539

Kit Contents

Qty	Description
1	Emblem Assembly Bow Tie – Front
1	Emblem Assembly Bow Tie – Rear
1	Installation Instructions

Tools Required

Plastic Flat Bladed Tool

[Procedure](#)

Front Bow Tie Emblem Replacement

1. Read all instructions before performing procedure.
2. Inspect kit to verify all parts are included.
3. Turn off the vehicle.
4. Open the hood.
5. Remove the front bumper fascia from vehicle. Refer to [Front Bumper Fascia Replacement](#) in Vehicle Service Manual.

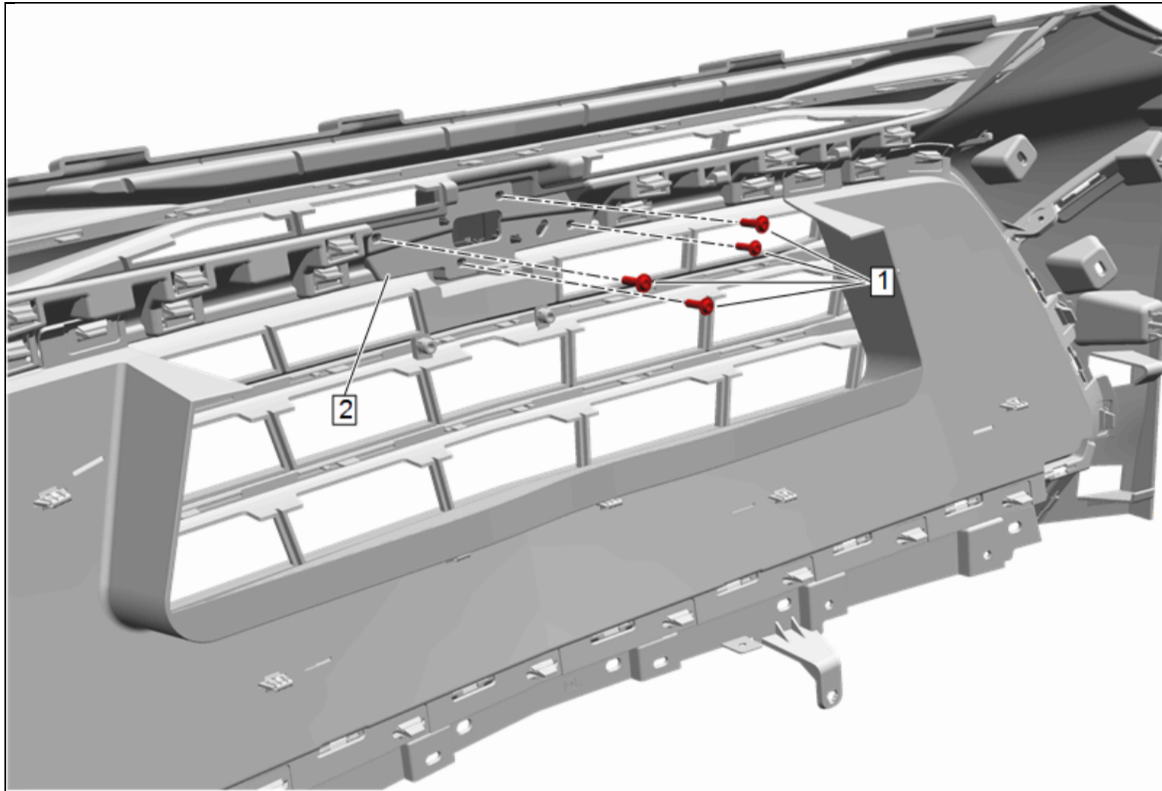

6. On the backside of the grille assembly (2) remove and retain the screws (2) securing the emblem adaptor.

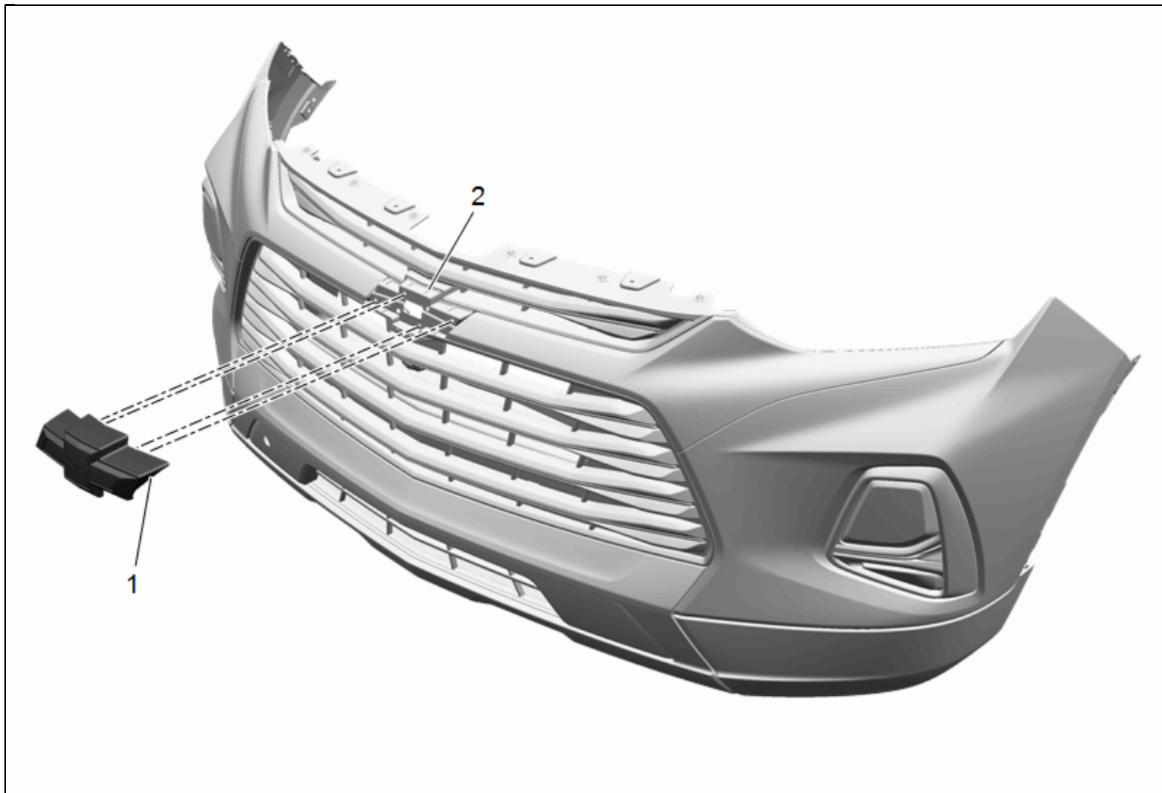

7. Remove the production bowtie emblem with adaptor (1) from grille assembly (2).

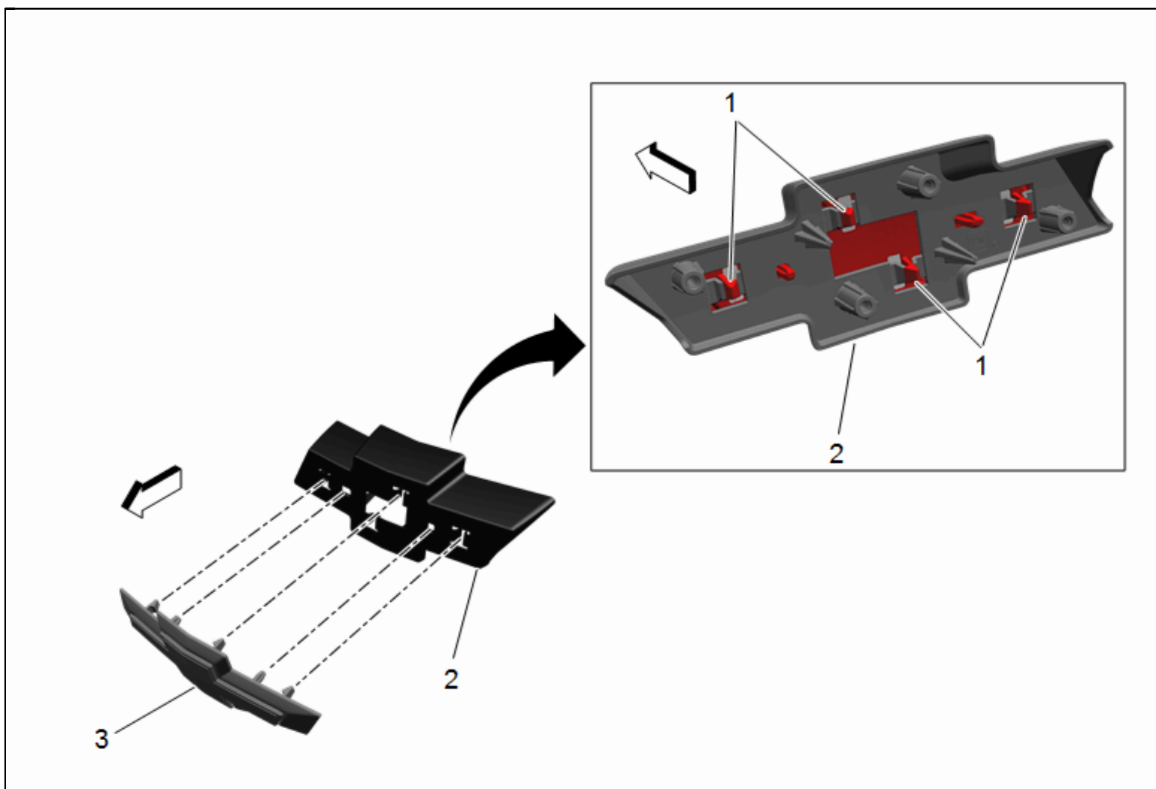

8. Disengage the retaining tabs (1) and remove the production bowtie emblem (3) from the emblem adaptor (2).

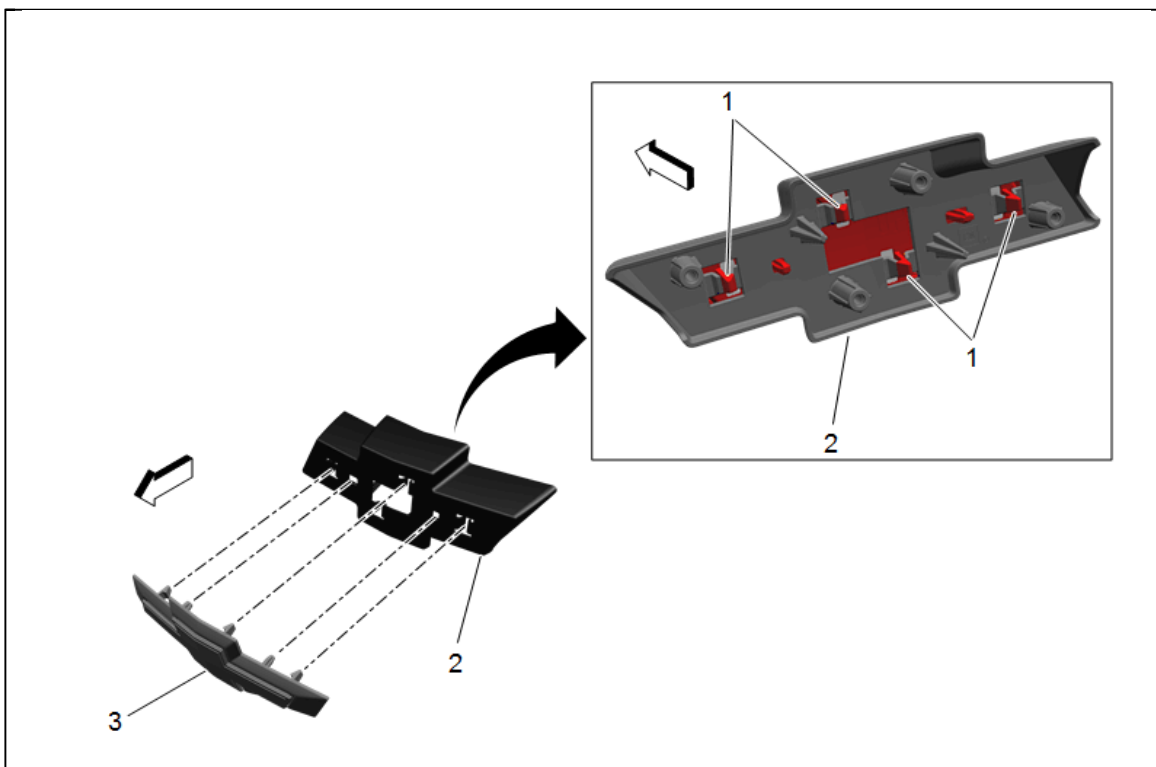

9. Install the new bowtie emblem (3) to the emblem adaptor (2) applying enough evenly distributed pressure to engage the retention tabs (1).

Note: Wiggle the retention tabs (1) to make sure they are fully engaged.

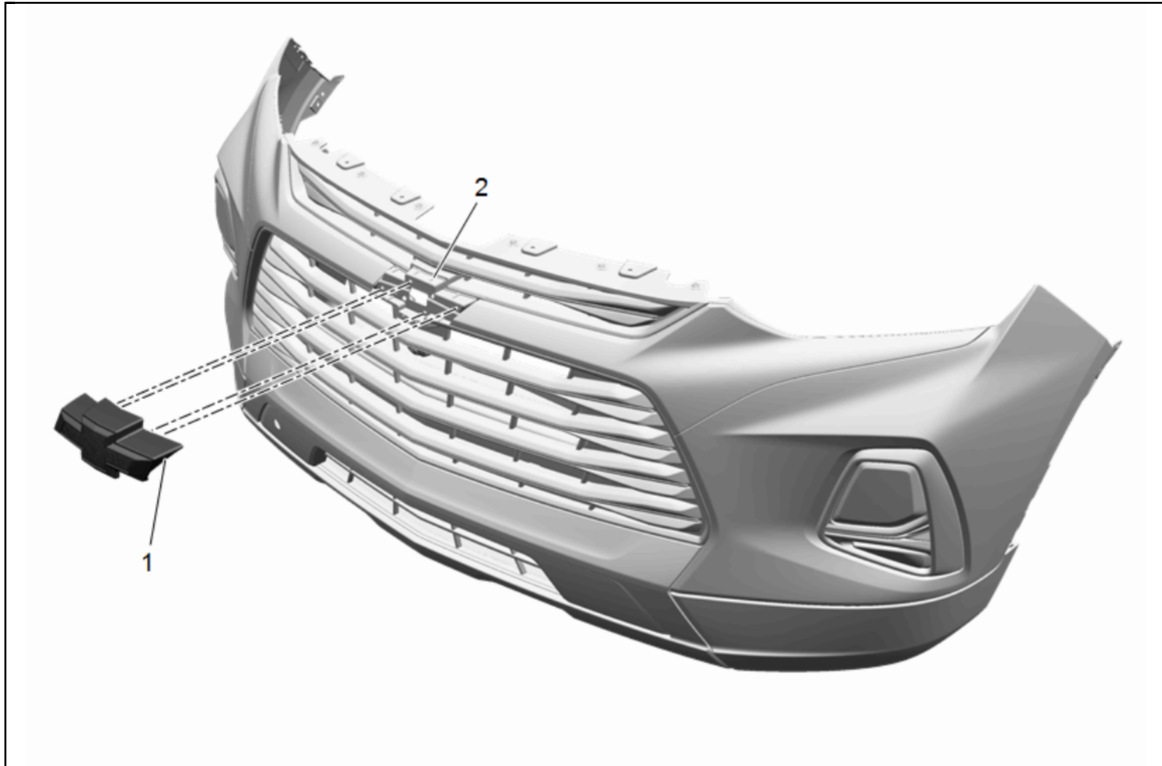

10. Install the new bowtie emblem with adaptor (1) to the grille assembly (2).

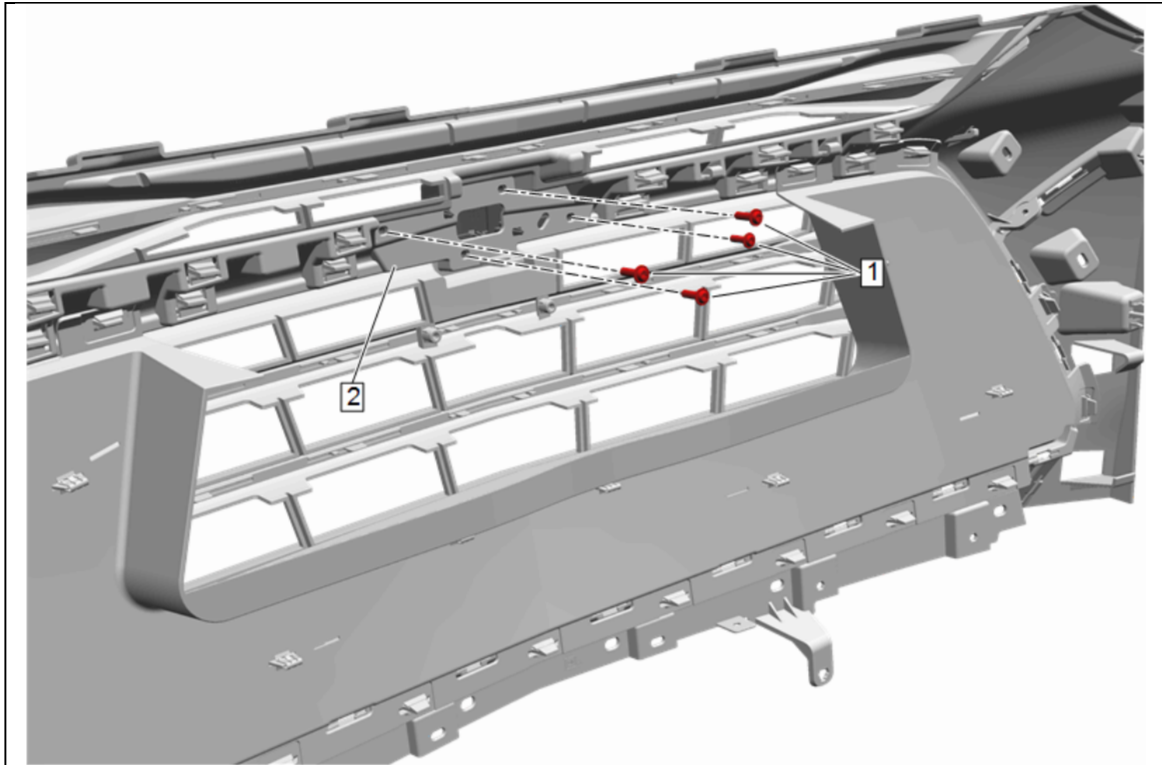

Caution: Use the correct fastener in the correct location. Replacement fasteners must be the correct part number for that application. Fasteners requiring replacement or fasteners requiring the use of thread locking compound or sealant are identified in the service procedure. Do not use paints, lubricants, or corrosion inhibitors on fasteners or fastener joint surfaces unless specified. These coatings affect fastener torque and joint clamping force and may damage the fastener. Use the correct tightening sequence and specifications when installing fasteners in order to avoid damage to parts and systems.

11. On the backside of the grille assembly (2) install the previously retained screws (2) securing the emblem adaptor. Tighten the screws to 2.5 N.m (22 lb in).
12. Re-install the front bumper fascia. Refer to [Front Bumper Fascia Replacement](#) in Vehicle Service Manual.
13. Test and confirm front lighting operation (headlamp and fog lamp).
14. Close the hood.

Rear Bow Tie Emblem Replacement

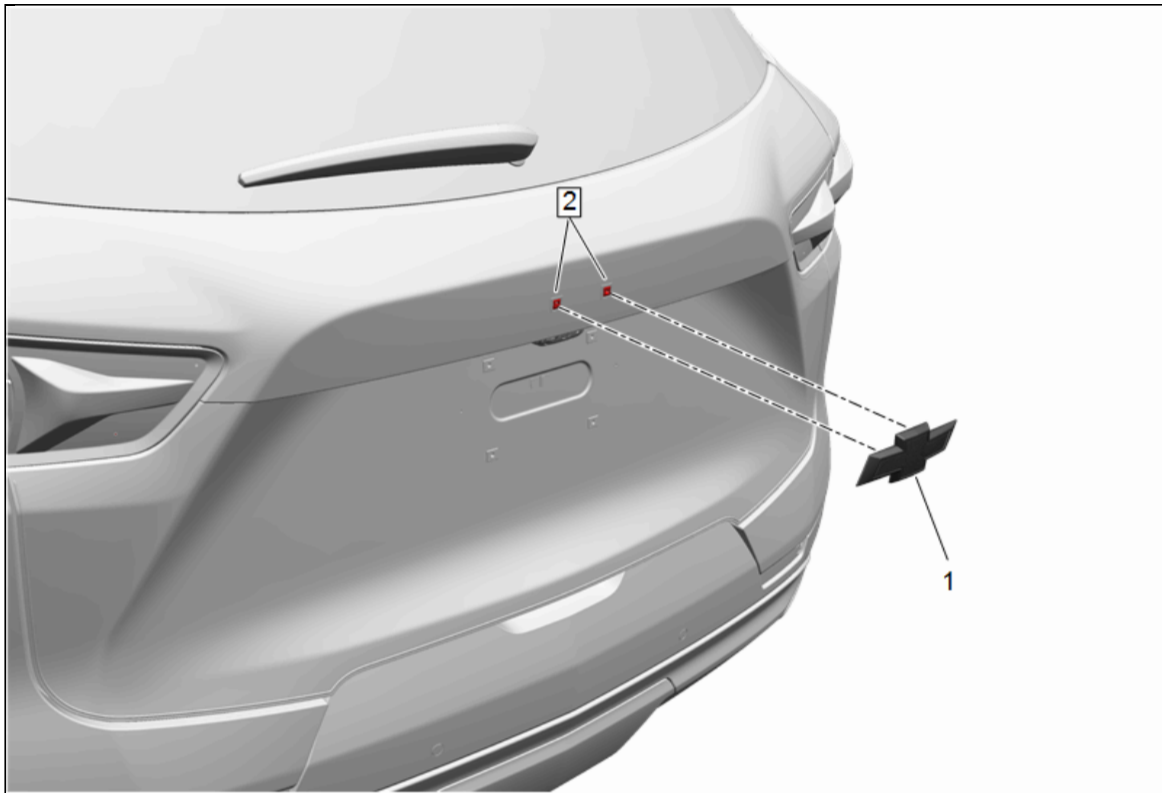

Caution: DO NOT use heat gun to remove emblems from any plastic part (applique) or around any plastic part. Applying heat to emblem may damage the finish of the surrounding plastic part (applique) resulting in replacing the plastic parts (applique).

Caution: Use a plastic, flat-bladed tool to prevent paint damage when removing an emblem/name plate.

1. Using a plastic flat bladed tool, disengage the retainers on the production bowtie emblem (1) from the grommets and remove from liftgate. Remove excess adhesive tape from liftgate.

Note: Wash the vehicle mating surfaces with a non-petroleum based cleaning product. If a stronger cleaner is required to remove any contaminates, use 3M general purpose Adhesive Cleaner (P/N 08984). Then, thoroughly dry with a soft clean cloth.

2. Position new bowtie emblem (1) to the grommets (2) on liftgate making sure retainers are engaged.