

# Assist Step Kit Installation (Instruction ID: 84322012)

## Installation Instructions Part Number

84322012

### Kit Contents

Description	Qty:
LHS Step Assist Assembly	1
RHS Step Assist Assembly	1
M6 Nut	8
SEMS Bolt M6 x 1 x 30	8
SEMS Bolt M6 x 1 x 20	8
M6 Hex Riv Nut	8
U-Nut	4
W-Clip	2
Rear Plastic Bracket-RH	1
Rear Plastic Bracket-LH	1
Rear Jack Cover-RH	1
Rear Jack Cover-LH	1
Front Jack Cover-RH	1
Front Jack Cover-LH	1
Installation Instructions	1

## Procedure

1. Raise and support the vehicle. Refer to [Lifting and Jacking the Vehicle](#) in Vehicle Service Manual.

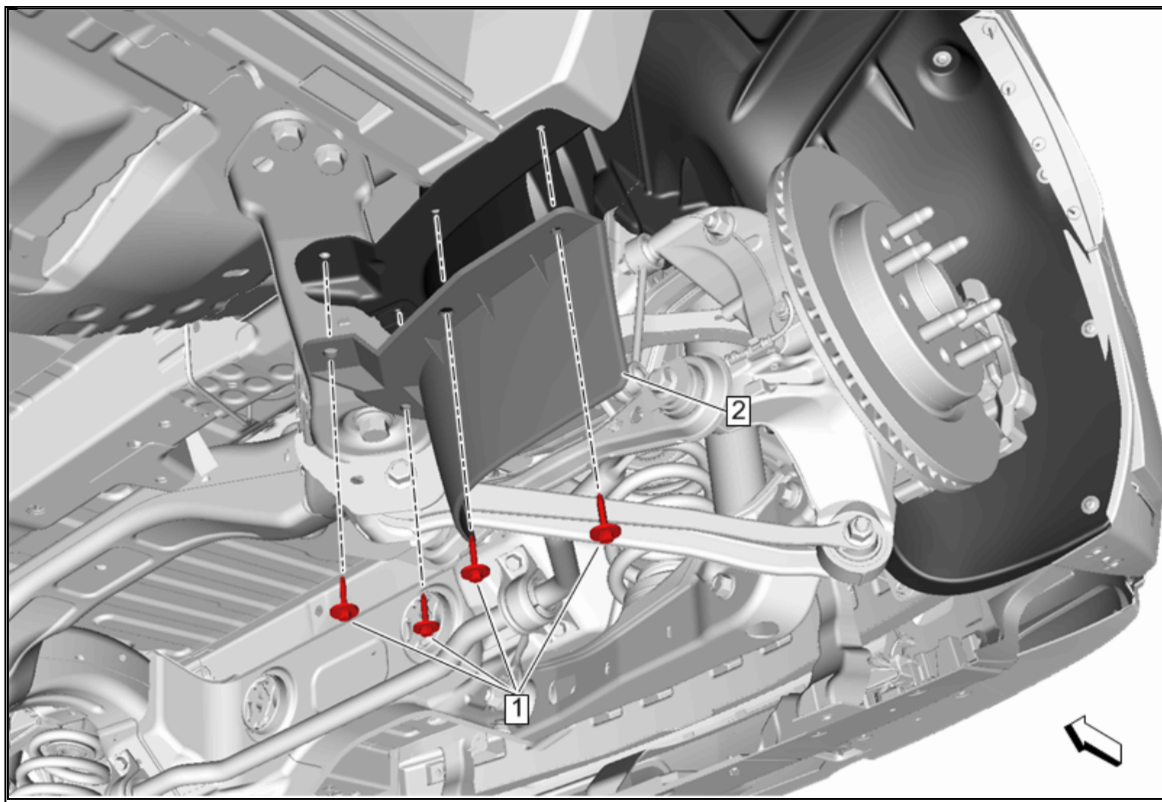

- 2. Remove and retain the fasteners (1) from the rear deflector.
- 3. Remove the rear deflector (2).

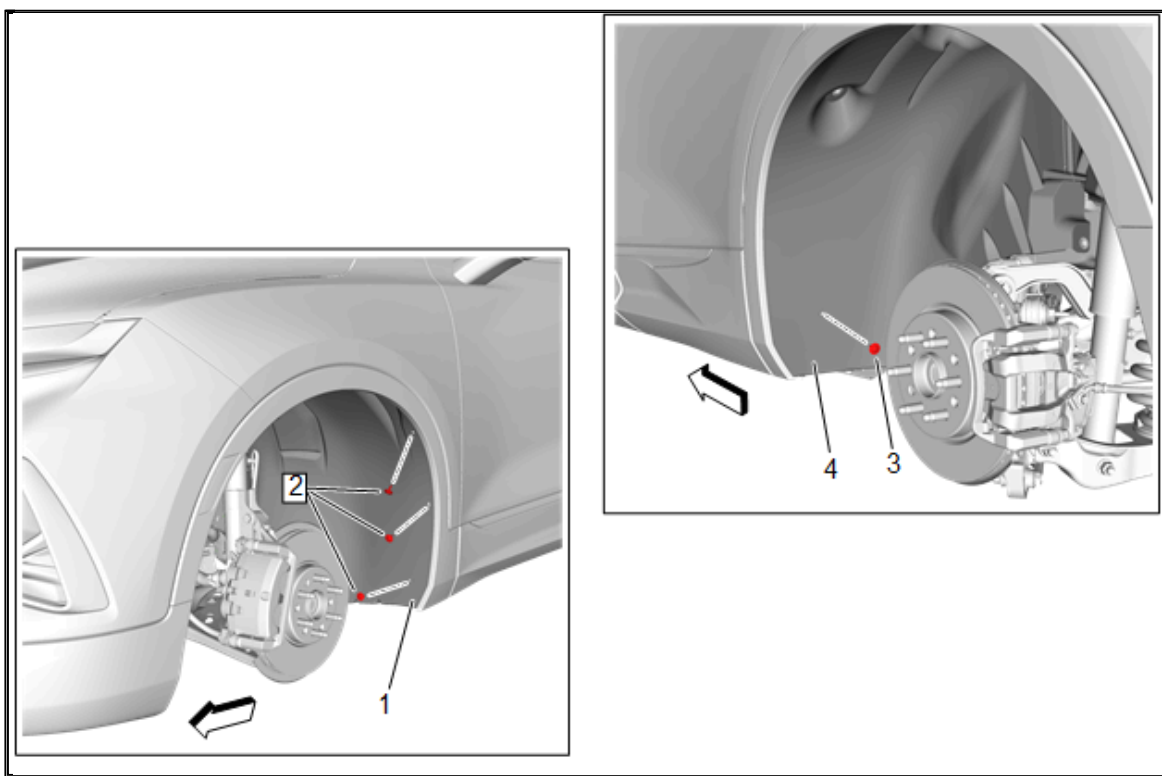

4. Remove the three fasteners (2) from the front wheelhouse panel (1).
5. Remove the fastener (3) from the rear wheelhouse panel (4).

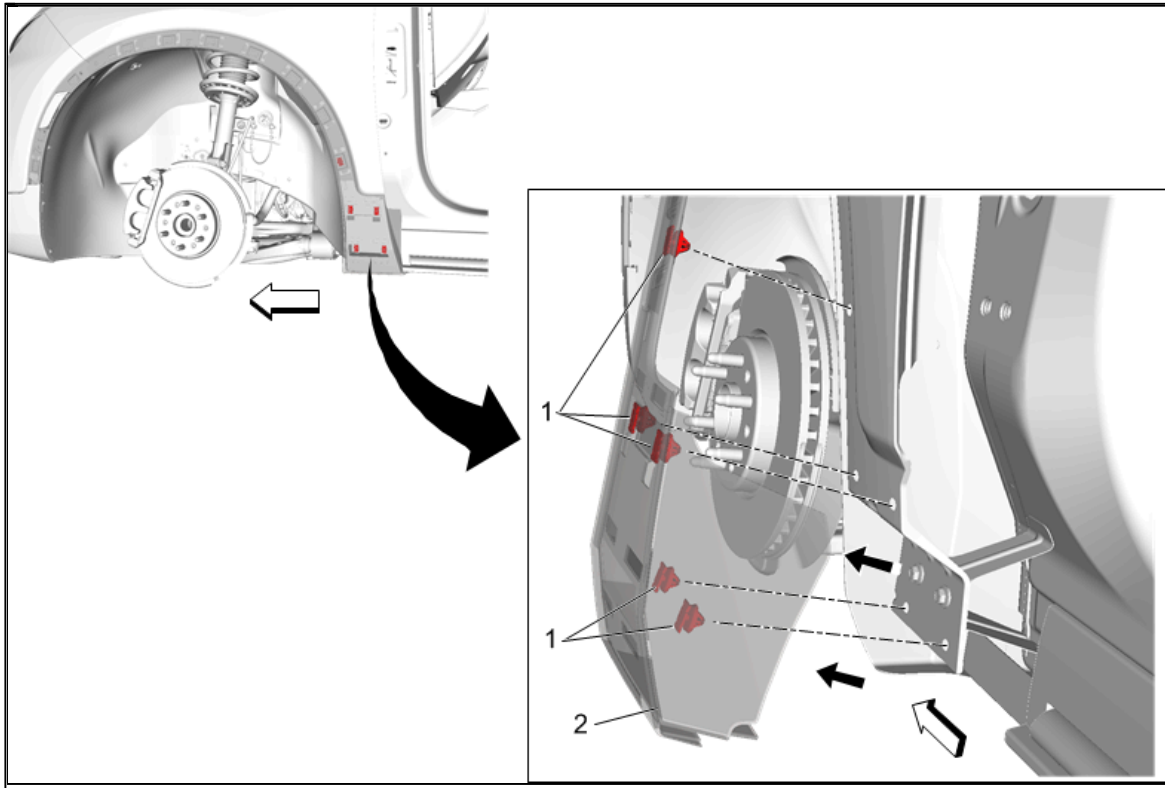

**Note:** Use a rag if necessary to avoid marking paint.

6. Use suitable trim removal tool / non marring prybar to disengage the clips (1) and remove the lower portion of front wheel opening molding (2).

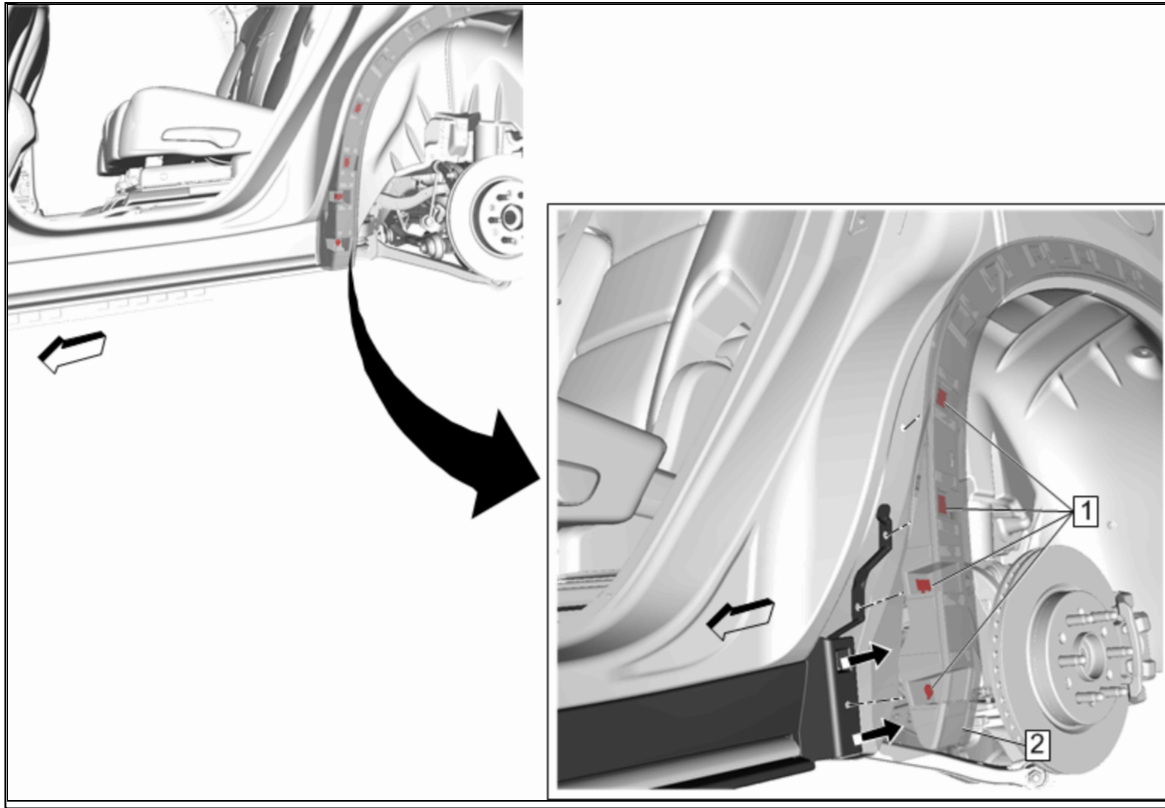

**Note:** Use a rag if necessary to avoid marking paint.

7. Use suitable trim removal tool / non marring prybar to disengage the clips (1) and remove the lower portion of rear wheel opening molding (2).

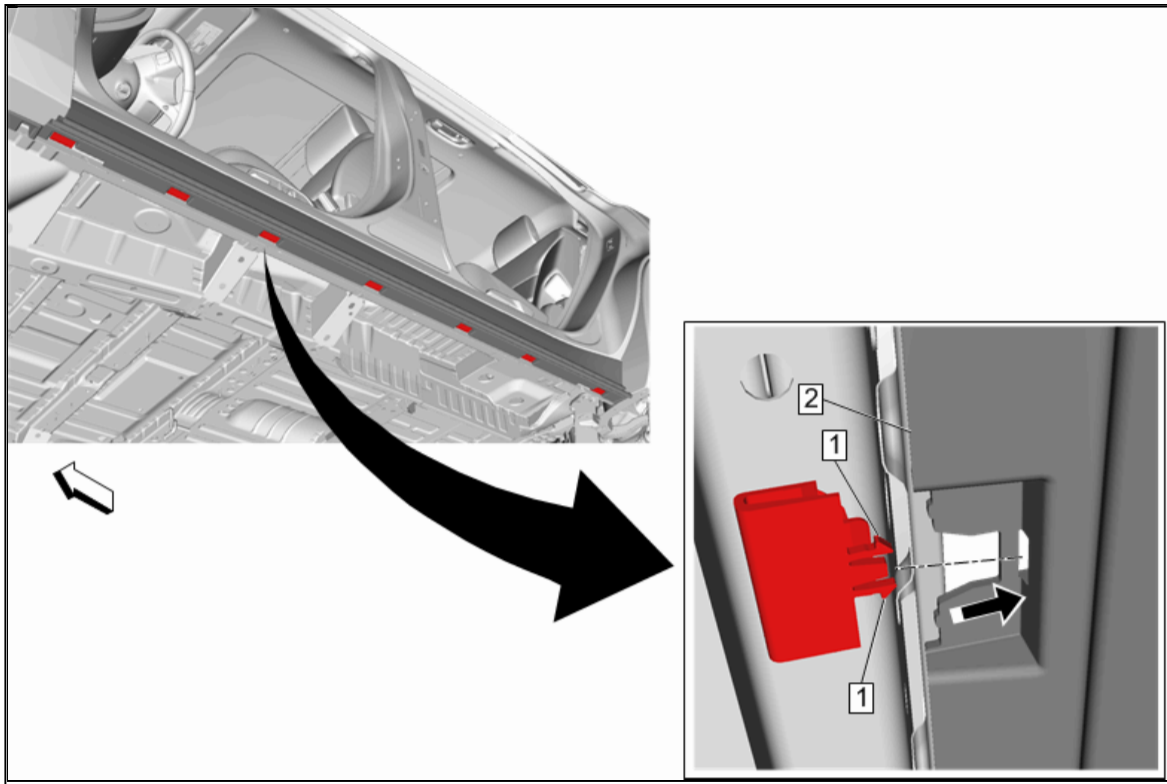

**Note:** Use a rag if necessary to avoid marking paint.

8. From the underside, squeeze tabs (1) and disengage clips from rocker molding (2).

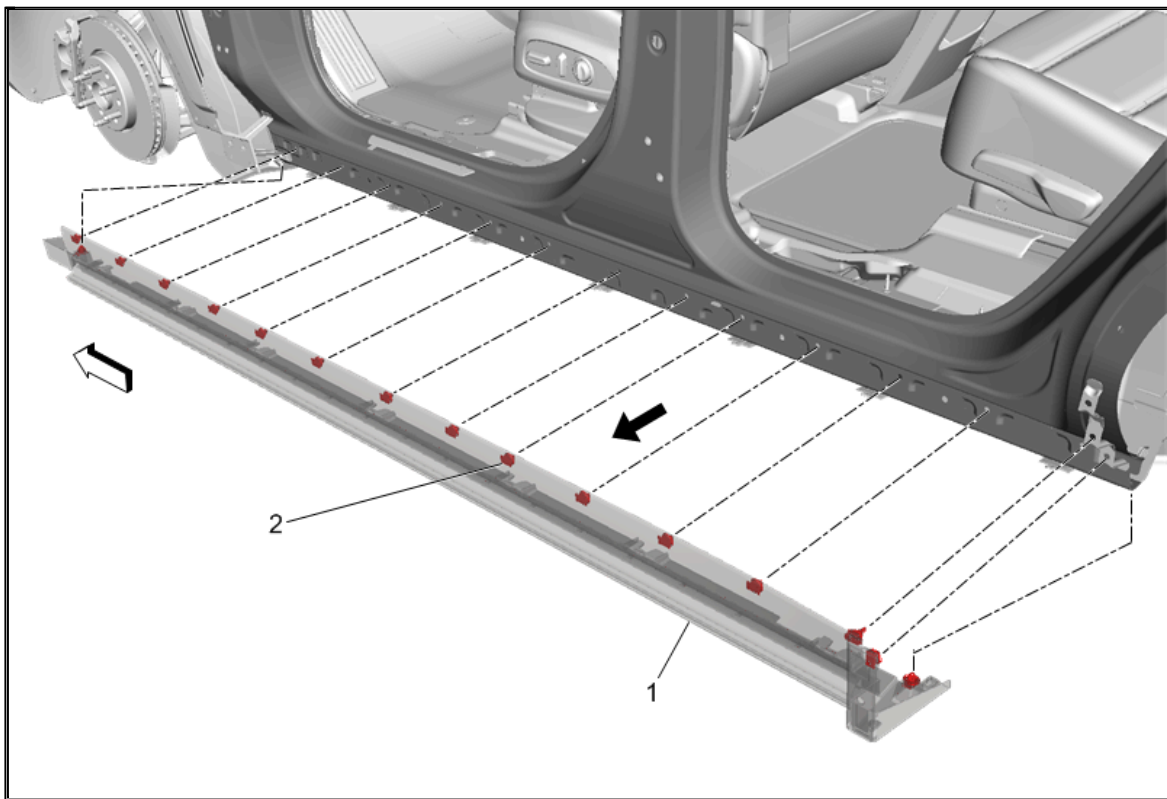

**Note:** Use a rag if necessary to avoid marking paint.

9. Use suitable trim removal tool / non marring prybar to disengage clips (2) remove the rocker molding (1).

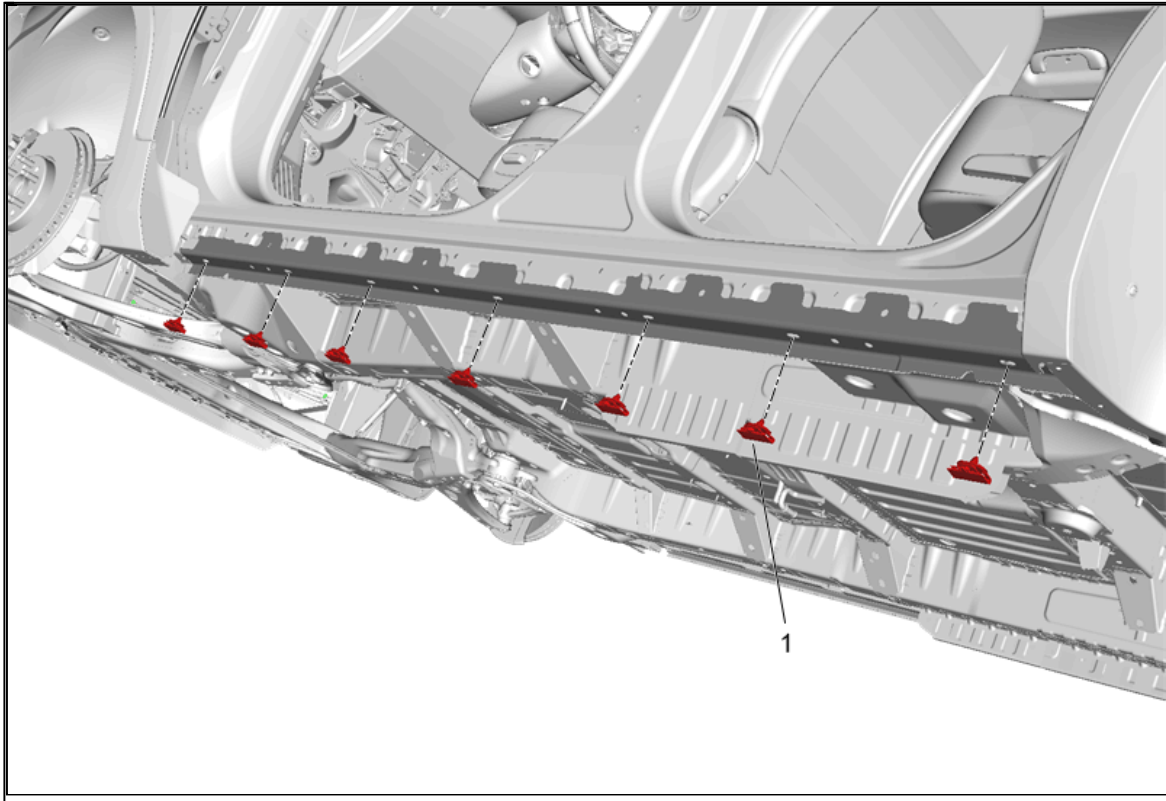

**Note:** Use a rag if necessary to avoid marking paint.

10. Use suitable trim removal tool / non marring prybar to disengage clips (1) remove the rocker panel.

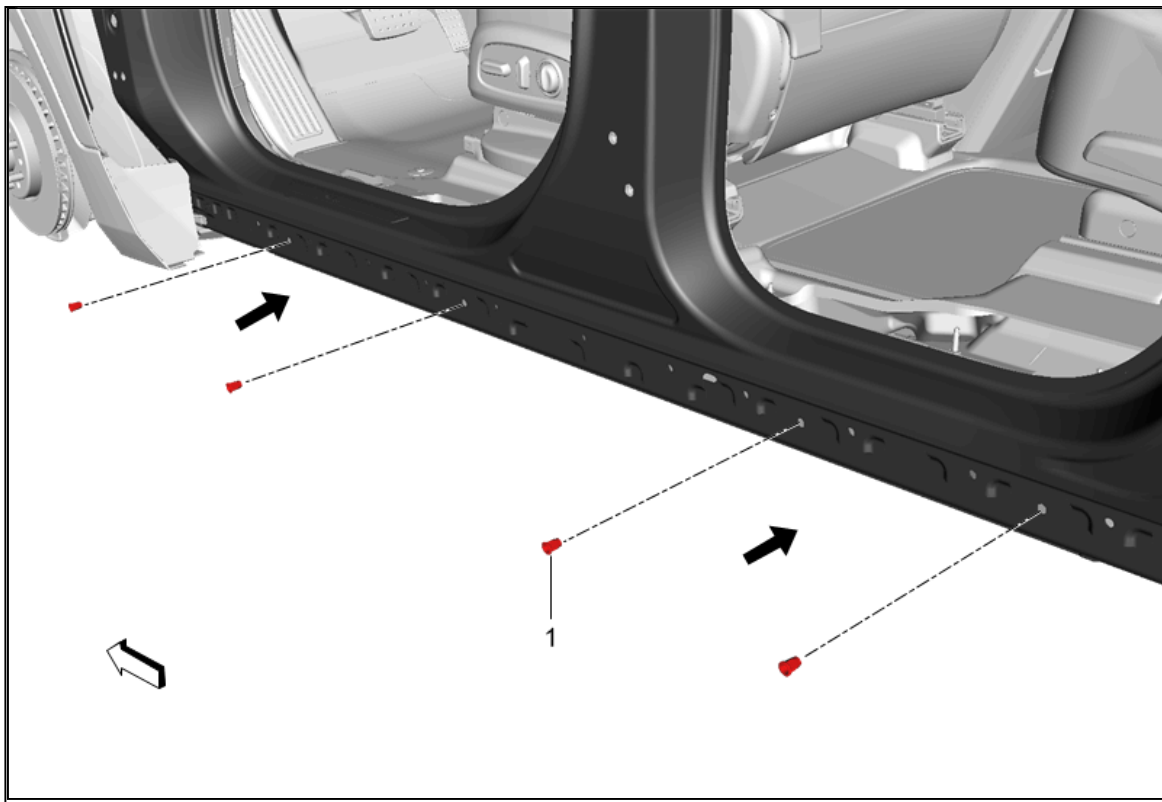

11. Locate the holes and install the hex rivet nuts (1) into the rocker panel.

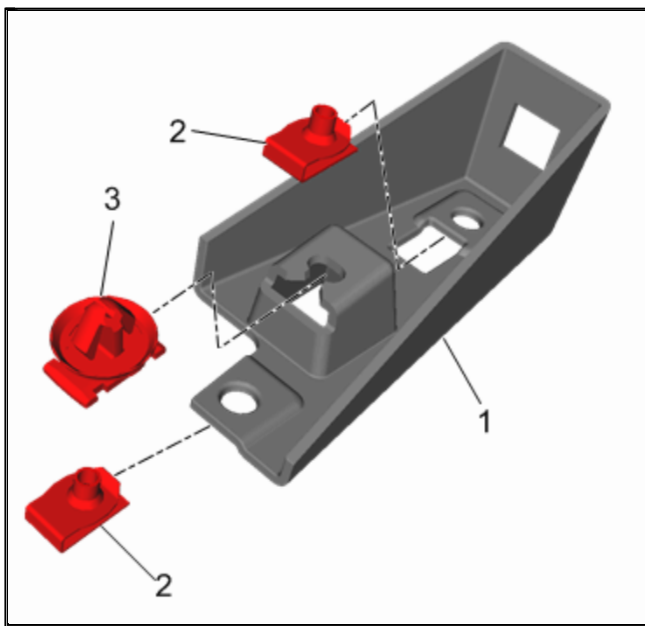

12. Install the U nuts (2) and W clip (3) to rear plastic bracket (1).

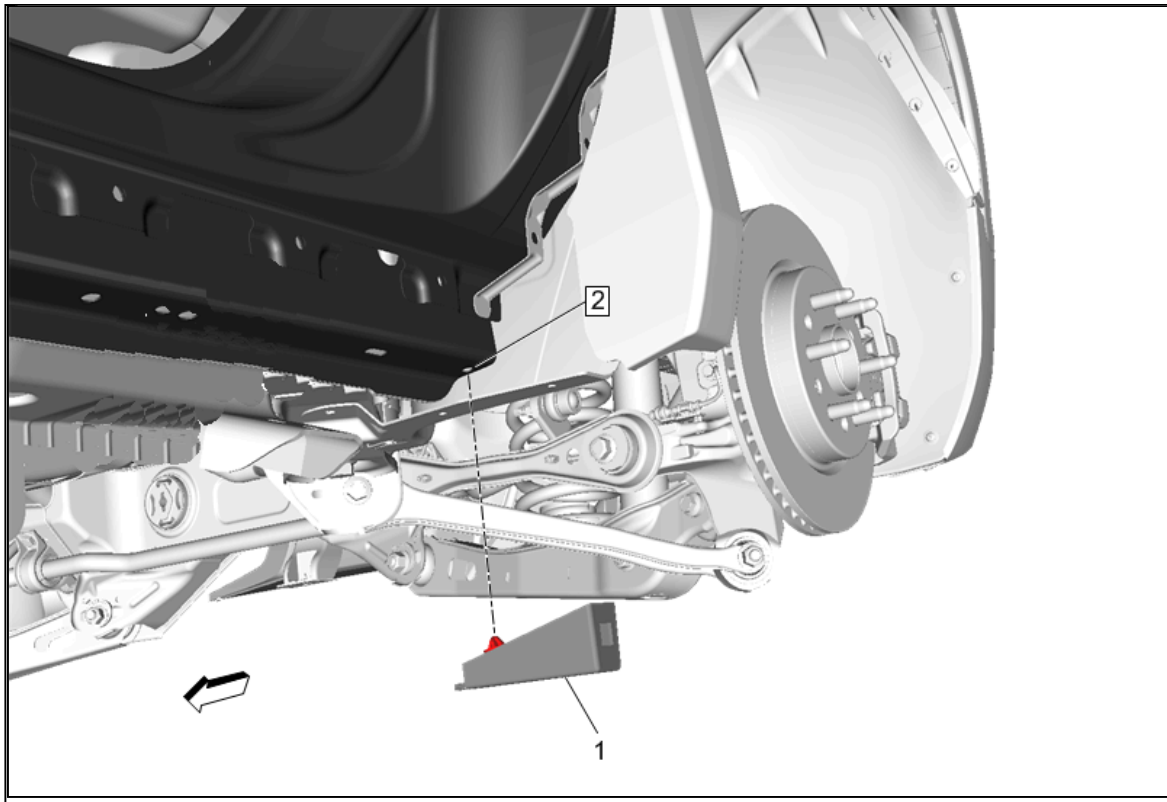

- 13. Position rear plastic bracket (2) to the rear hole on lower rocker panel (2) engaging the W clip.

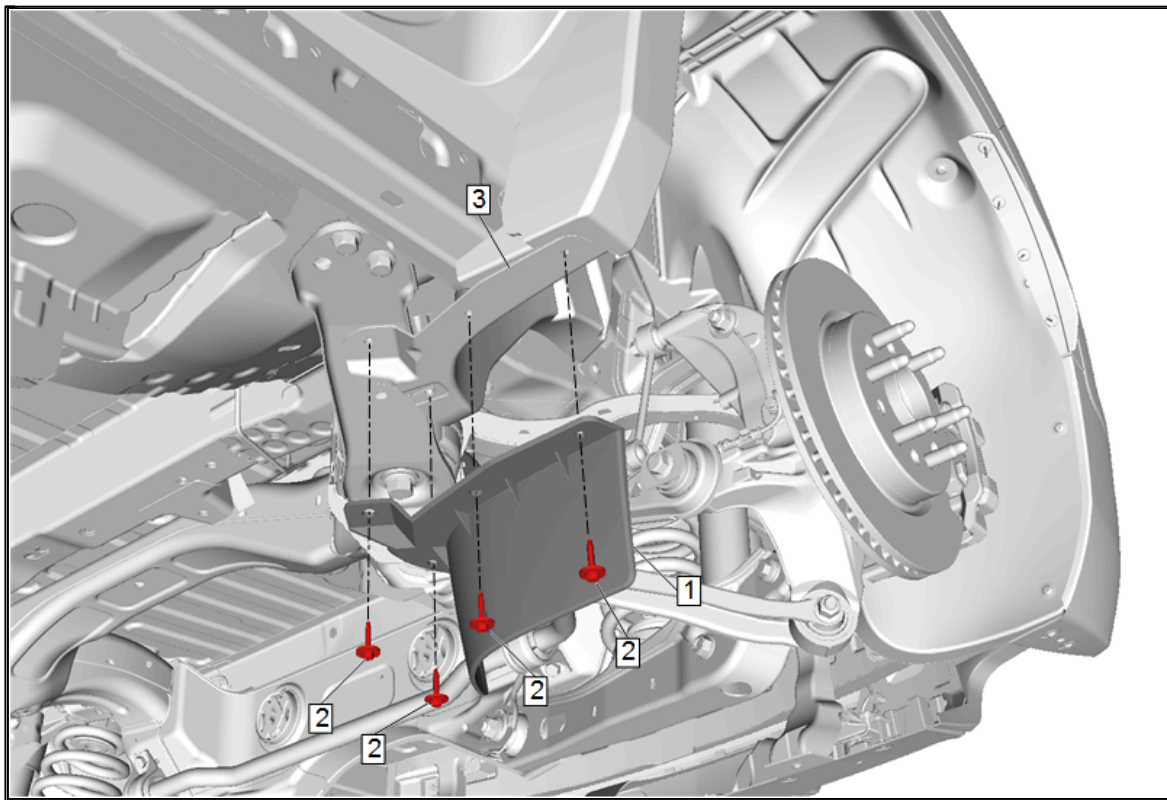

**Caution:** Use the correct fastener in the correct location. Replacement fasteners must be the correct part number for that application. Fasteners requiring replacement or fasteners requiring the use of thread locking compound or sealant are identified in the service procedure. Do not use paints, lubricants, or corrosion inhibitors on fasteners or fastener joint surfaces unless specified. These coatings affect fastener torque and joint clamping force and may damage the fastener. Use the correct tightening sequence and specifications when installing fasteners in order to avoid damage to parts and systems.

14. Reinstall the rear air deflector (1), to the rear wheelhouse panel (3) and secure with the previously retained fasteners (2). Tighten the fasteners to 2.5 N.m (22 lb in).

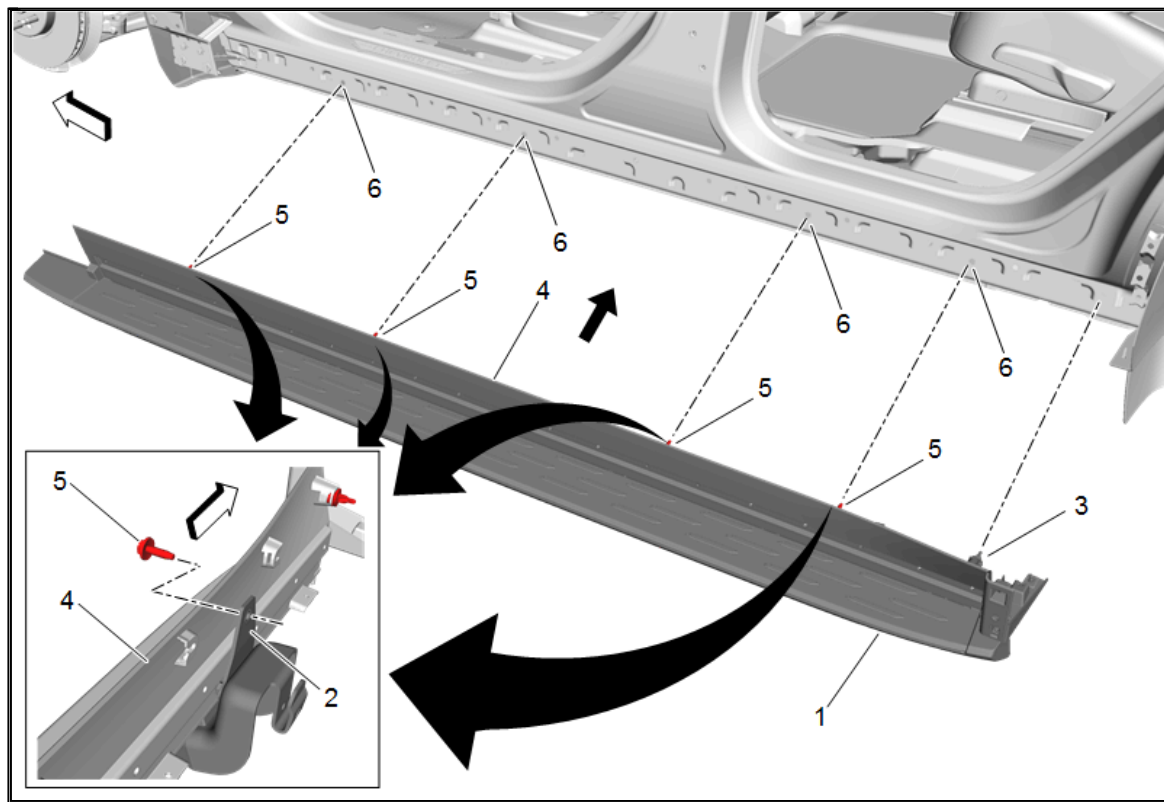

15. Place the assist step assembly (1) to the vehicle, engage only the rear W clip (3) to locate step pad.

**Note:** The flange (4) on the assist step will need to be bent slightly to access bolts (5). Once bolts are fastened engage the rest of the W clips. Use a rag if necessary to avoid marking paint.

16. Install the provided M6 x 20 bolts (5) through the bracket holes (2) and position to previously installed hex rivet nuts (6). Tighten the M6 x 20 bolts to 9 N.m (7 lb ft).

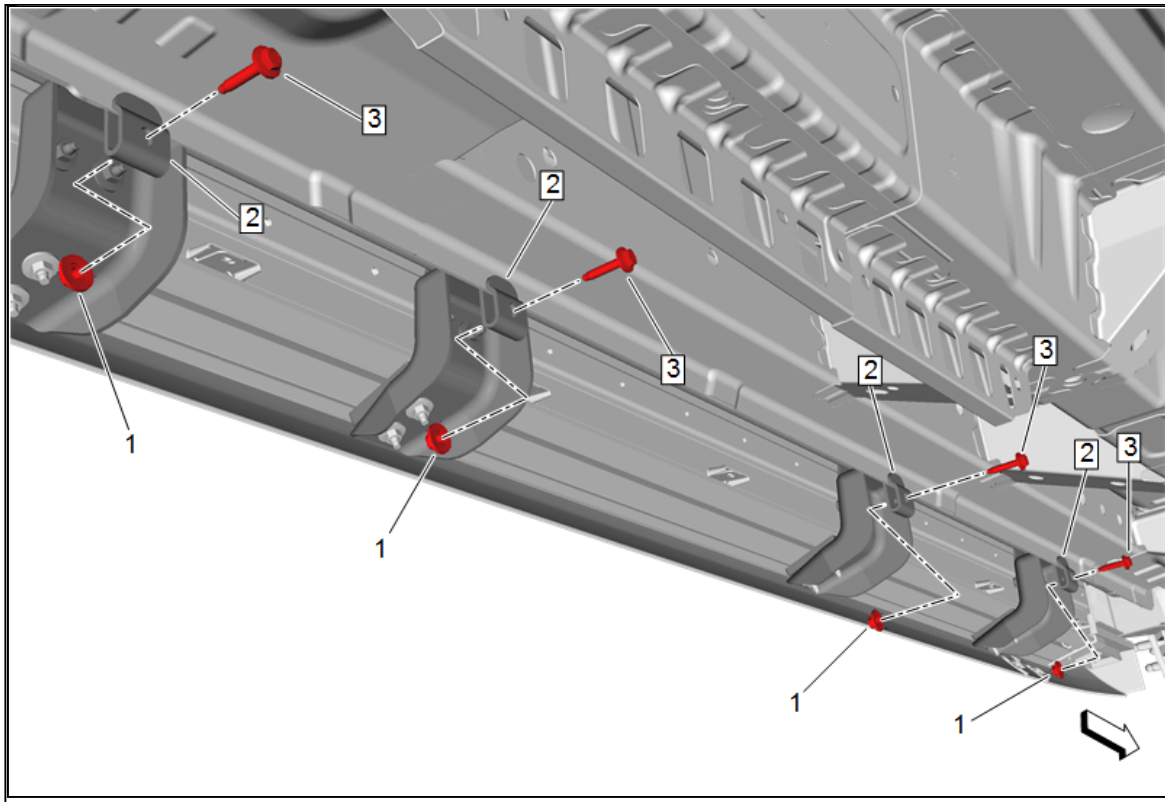

17. Install the M6 x 30 bolt (3) and M6 nut (1) into each bracket (2) ensuring the rocker flange is pinched and tighten to 9 N.m (7 lb ft).

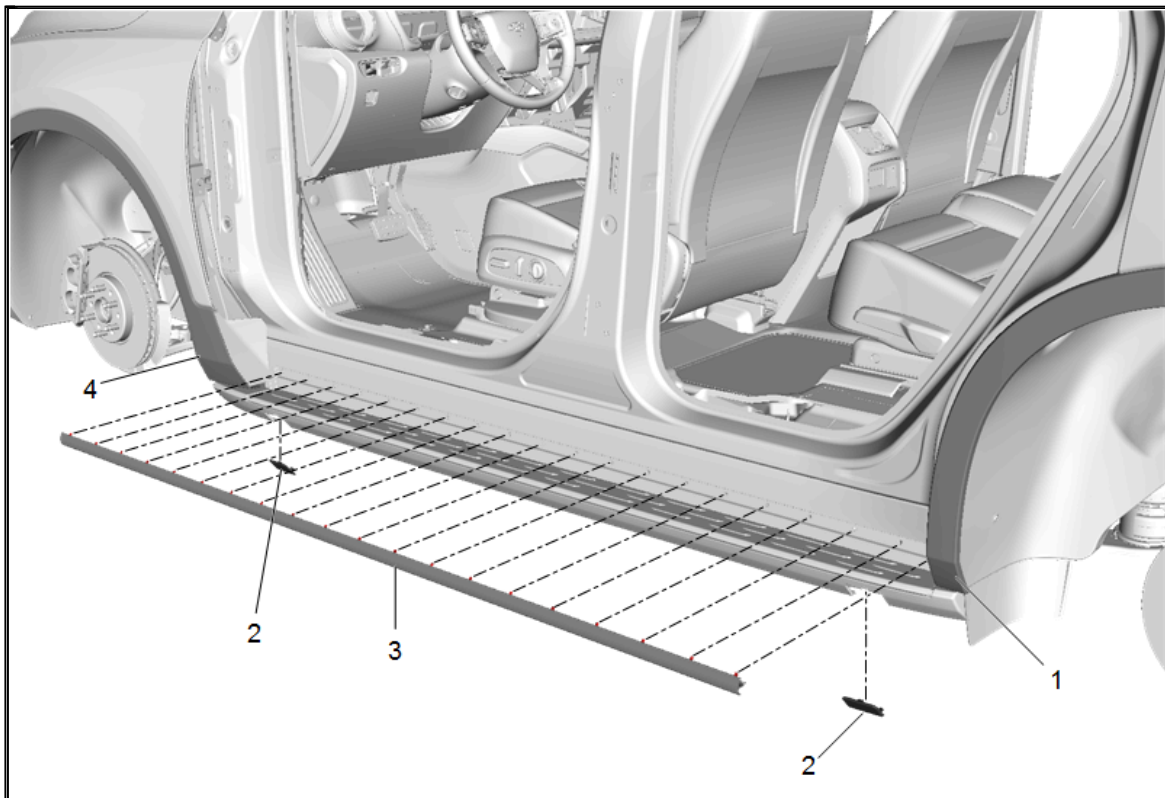

18. Install the weather strip (3) to the assist step engaging the clips.
19. Reposition and engage to clips to the front (4) and rear (1) wheel opening moldings.
20. Install the front and rear jack covers (2).

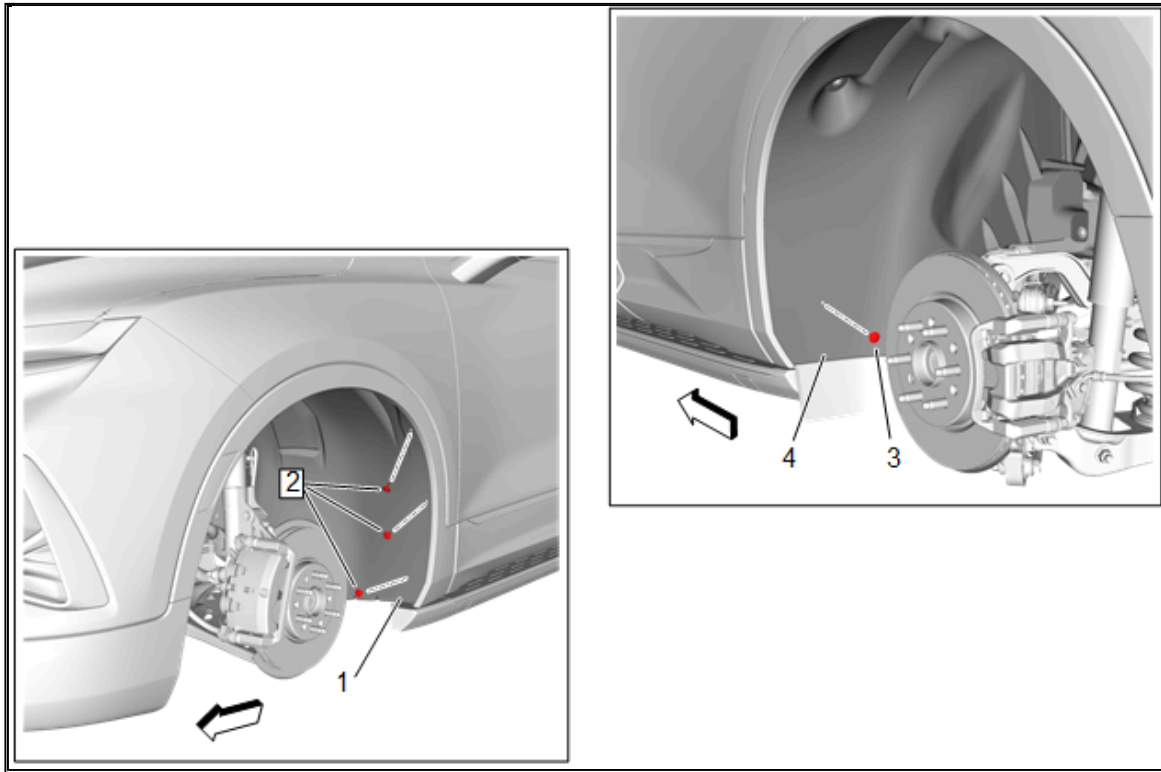

21. Reinstall the three fasteners (2) to the front wheelhouse panel (1). Tighten the fasteners to 2.5 N.m (22 lb in).
22. Reinstall the fastener (3) to the rear wheelhouse panel (4). Tighten the fasteners to 2.5 N.m (22 lb in).
23. Repeat steps 1-22 to complete installation of passenger side assist step assembly.
24. Lower the vehicle.