

Document ID: 5595901

Front Grille Package Installation

[Installation Instructions Part Number](#)

84596349

Kit Contents

Qty	Description
1	Upper Grille
1	Hood Front Molding
1	Emblem Assembly GMC – Liftgate
1	Alcohol Wipe
1	Installation Instructions

Required / Recommended Tools

Plastic flat-bladed tool

Isopropyl Alcohol

Lint free towel

[Procedure](#)

Preliminary Procedures

1. Remove the front bumper fascia. Refer to [Front Bumper Fascia Removal and Installation](#) in Vehicle Service Manual.
2. Remove the front view driver information camera, if equipped. Refer to [Front View Driver Information Camera Replacement](#) in Vehicle Service Manual.

Remove Grille

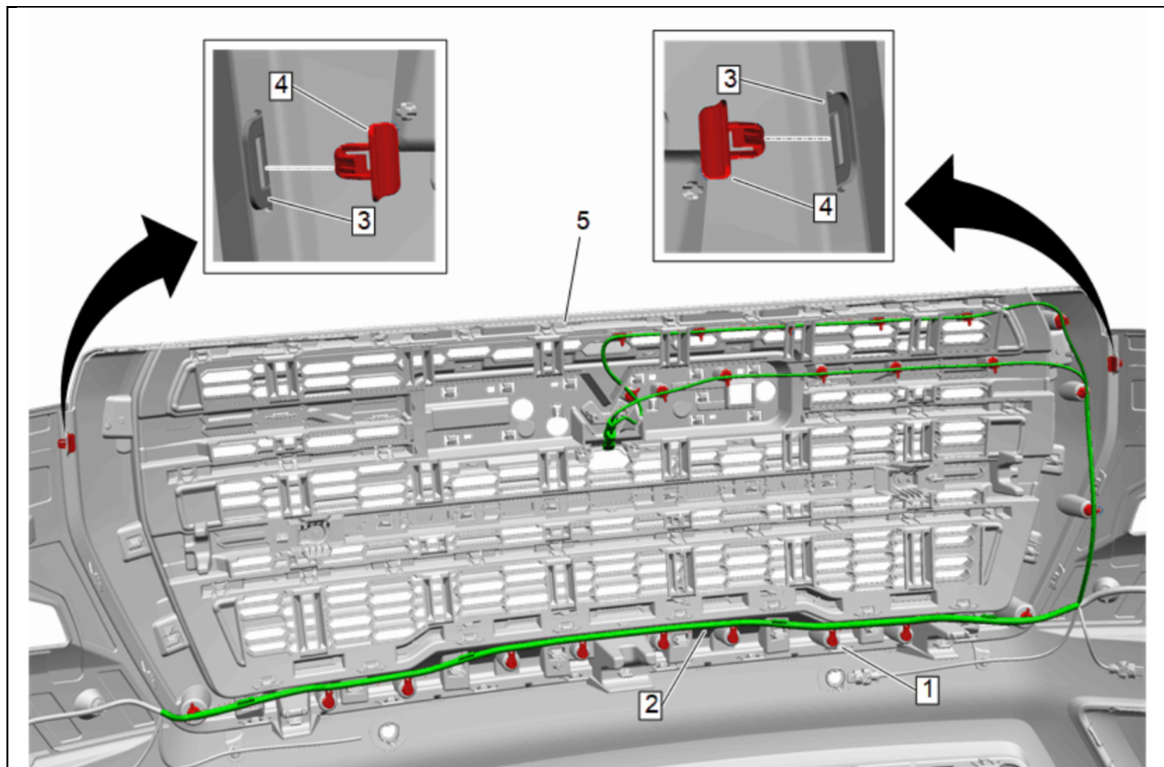

1. Disengage the harness retainers (1) from grille (5) and reposition harness (2).
2. Remove left and right grille retainers (4) from the front fascia tabs (3), keep retainers.

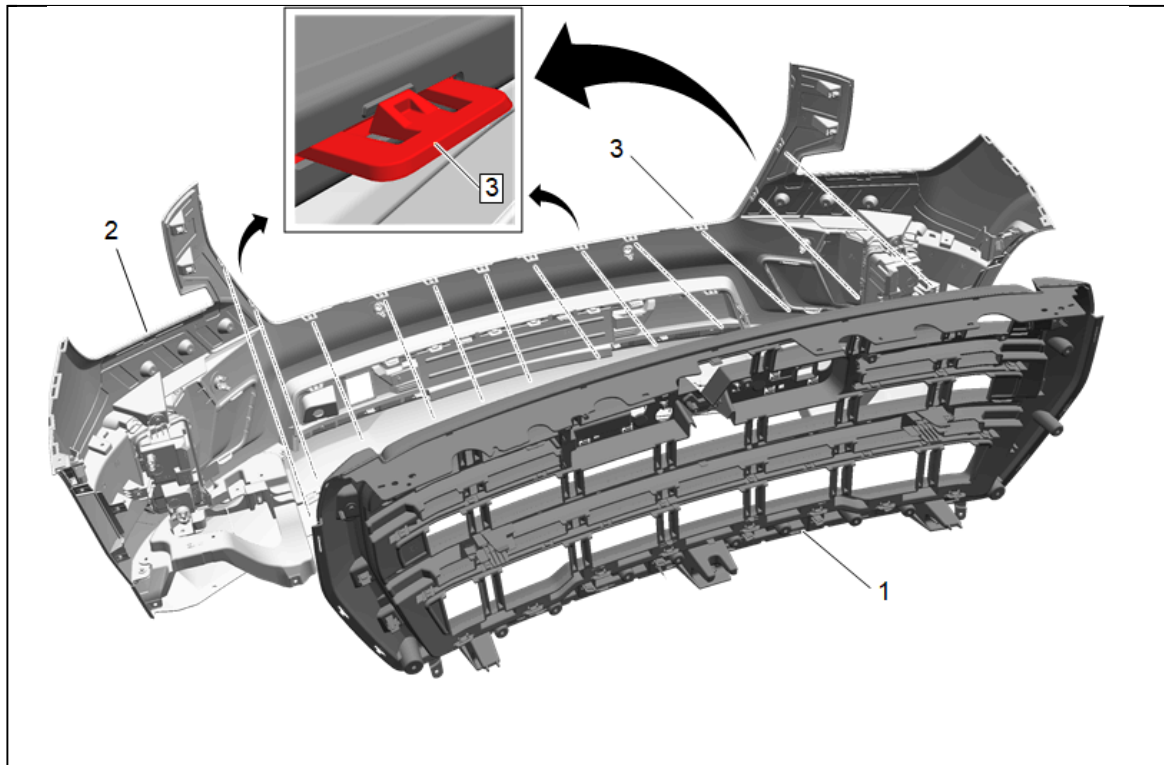

3. Using a suitable plastic flat bladed plastic tool, disengage the fascia tabs (3) from the front upper grille (1).
4. Remove the front upper grille (1) from the front bumper fascia (2).

Install Accessory Grille

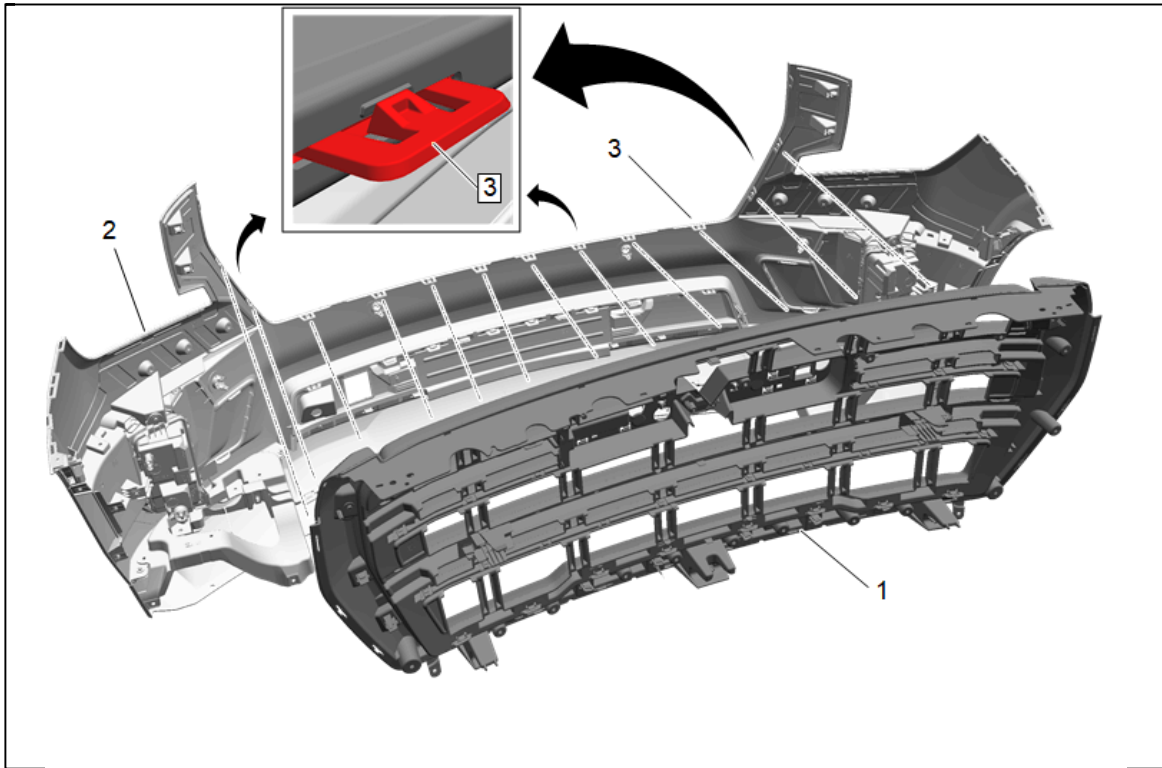

1. Position the front accessory grille upper grille (1) to the front bumper fascia (2) and carefully engage the front bumper fascia tabs (3).

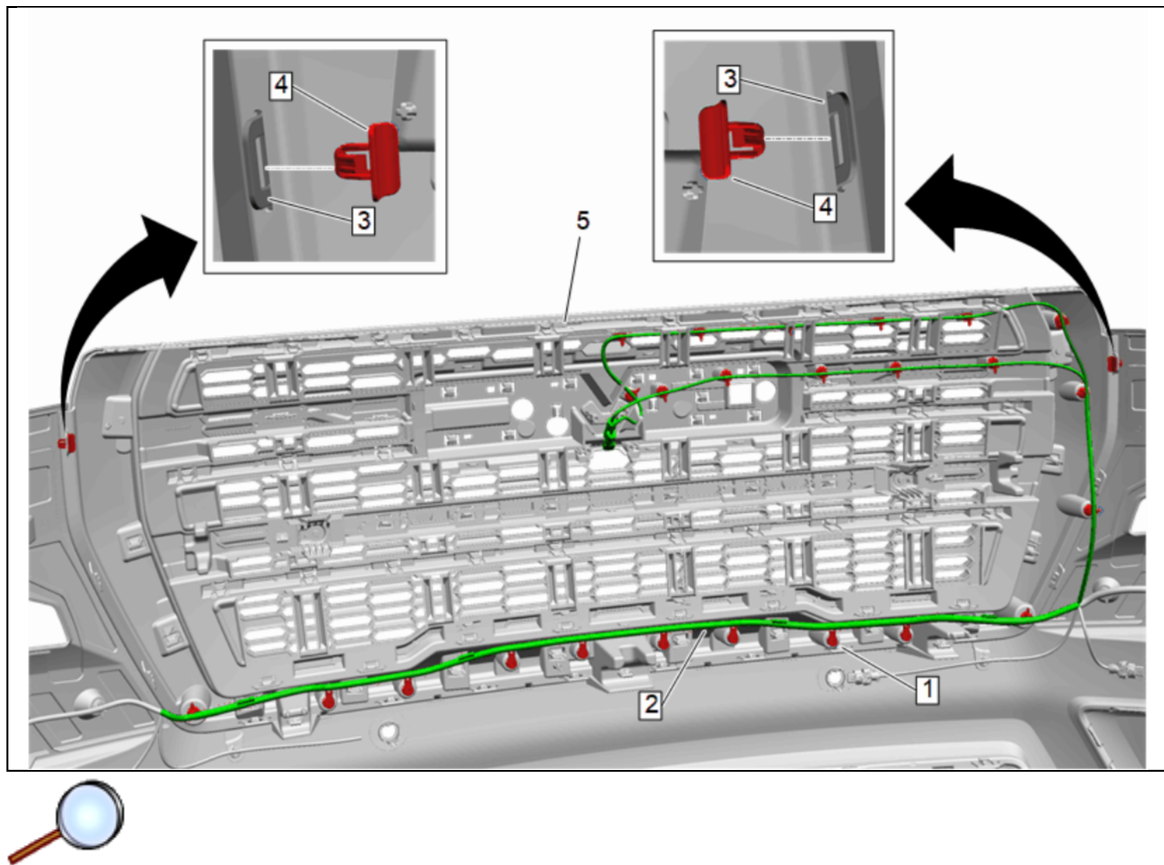

2. Reinstall left and right grille retainers (4) to the front fascia tabs (3).
3. Reposition harness (2) and engage the harness retainers (1) to grille (5).
4. Reinstall the front view driver information camera, if equipped. Refer to [Front View Driver Information Camera Replacement](#) in Vehicle Service Manual.
5. Reinstall the front bumper fascia. Refer to [Front Bumper Fascia Removal and Installation](#) in Vehicle Service Manual.

Hood Front Molding Removal

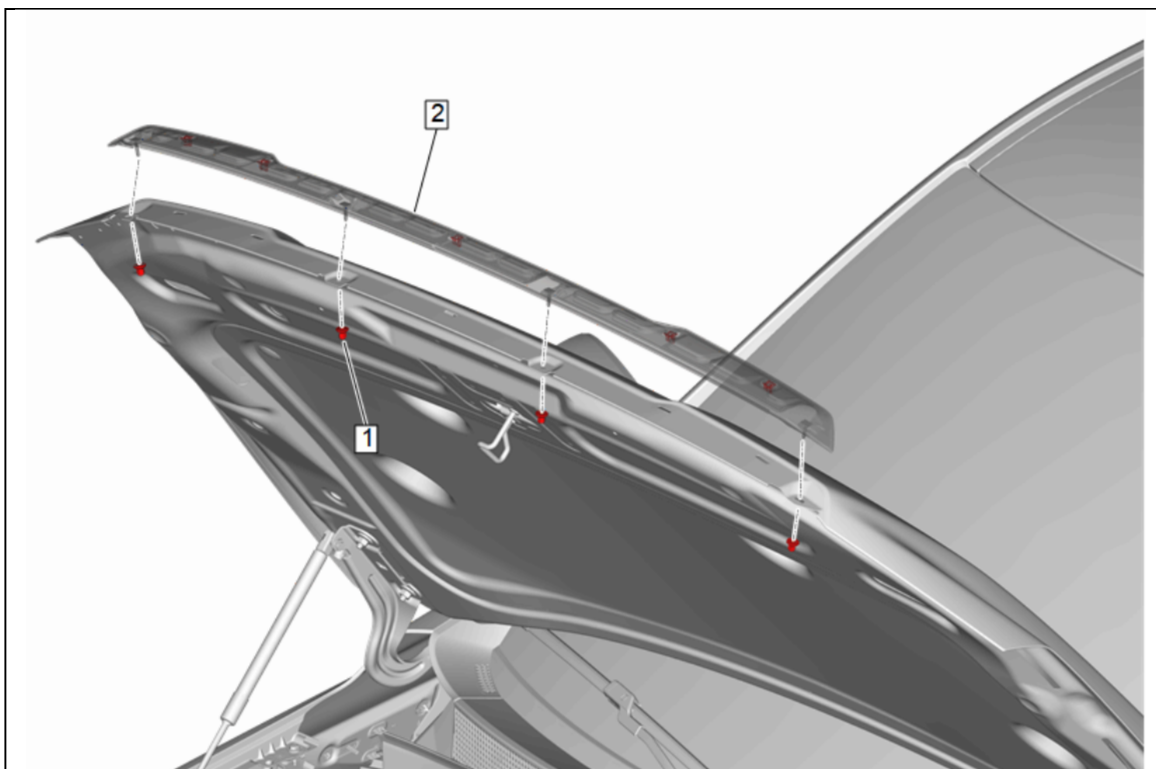

Note: Quantity of fasteners may vary based on option content.

1. Hood Front Molding Nut (1) » Remove [4x]
2. Using a flat-bladed plastic trim tool, release the retaining clips.
3. Hood Front Molding (2) » Remove

Hood Front Molding Install

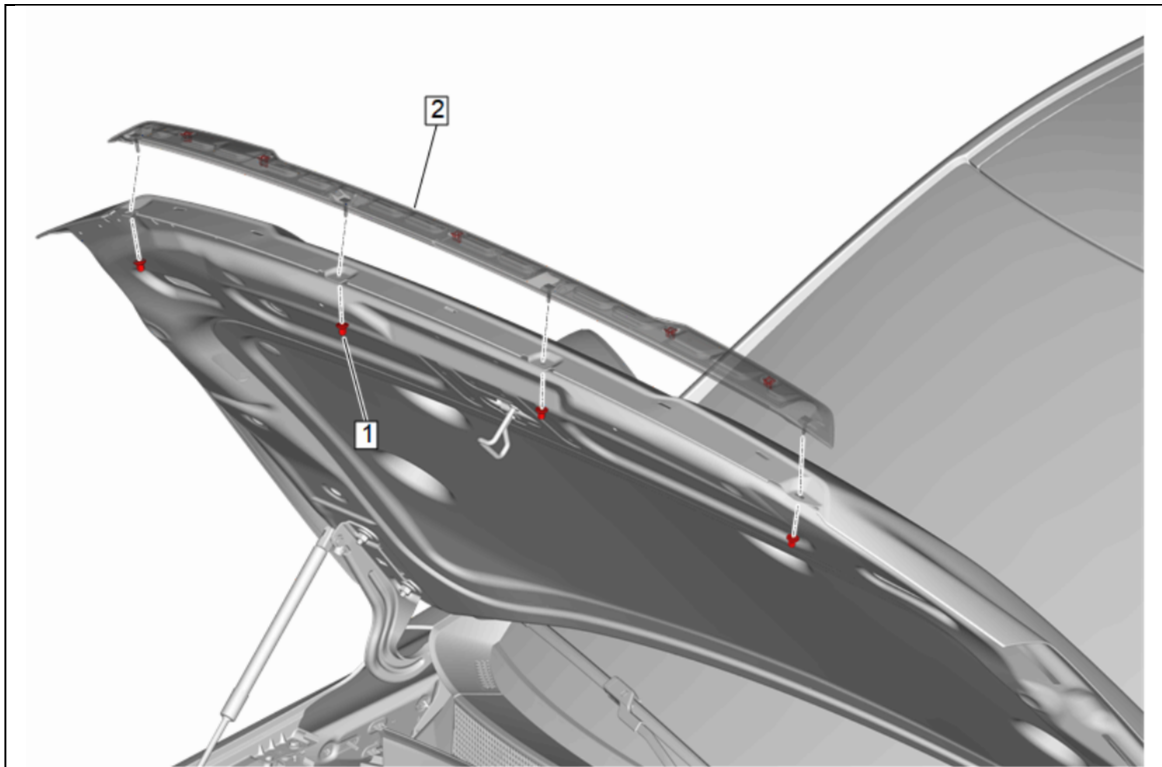

1. Hood Front Molding (2) » Install

Caution: Refer to [Fastener Caution](#).

Note: Quantity of fasteners may vary based on option content.

2. Hood Front Molding Nut (1) » Install and tighten [4x] — [Fastener Specifications](#)

Rear Black GMC Emblem Replacement

1. Turn off vehicle.

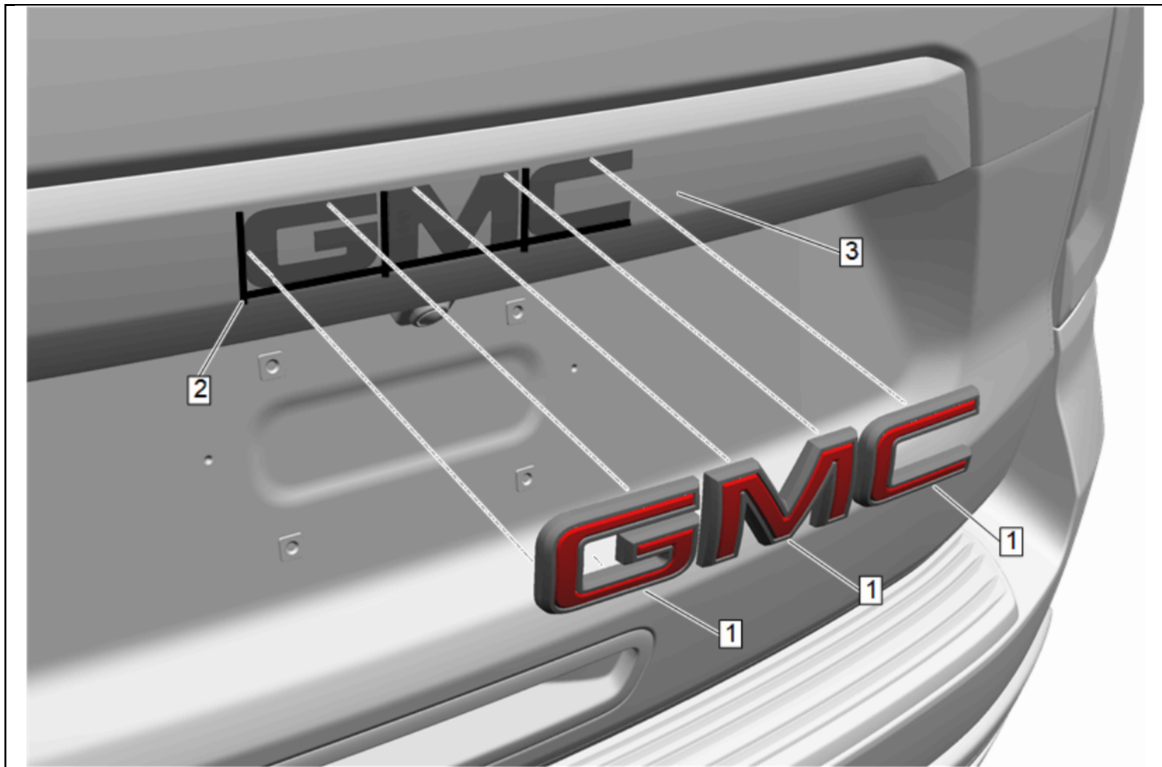

Caution: DO NOT use heat gun to remove emblems from any plastic part (applique) or around any plastic part. Applying heat to emblem may damage the finish of the surrounding plastic part (applique) resulting in replacing the plastic parts (applique).

Caution: Use a plastic flat-bladed tool to prevent paint damage when removing an emblem/name plate.

2. Mark the position of the emblem with a washable marker or masking tape (2) prior to removal.
3. Carefully remove the existing emblems (1) from the liftgate surface (3) using a plastic flat-bladed tool .
4. Clean any remaining residue with a 50/50 mixture by volume of isopropyl alcohol and clean drinkable water. Wipe surface dry with a clean lint-free towel.
5. Installing the Rear Emblem:
 - 5.1. The part surface should be 21°C (70°F) prior to installation. The vehicle should remain 21°C (70°F) for one hour after assembly to allow adhesive to develop sufficient bond strength.
 - 5.2. When removing protective liners from the adhesive tape, be careful not to touch tape with hands and do not allow tape to come in contact with dirt or any foreign matter prior to adhesion.

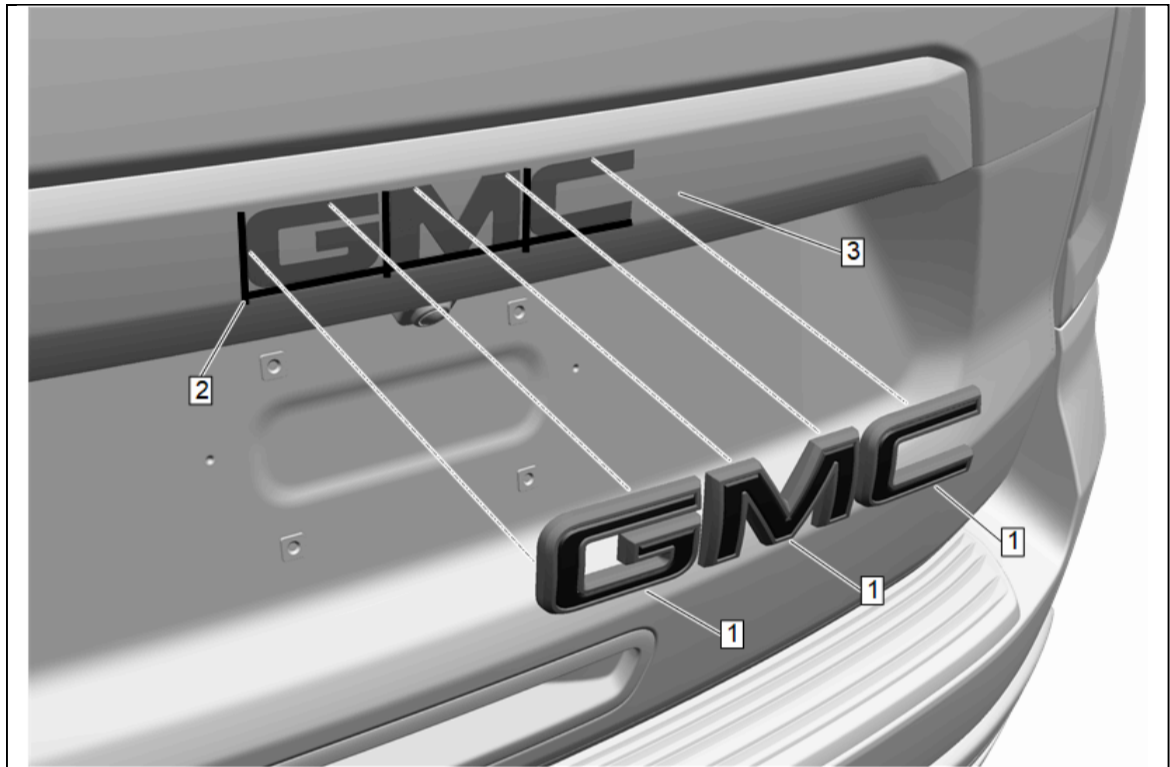

- 5.3. Position new emblems (1) carefully within reference marks (2) and place on prepared surface of liftgate (3).
- 5.4. Using the palm of the hand, apply strong pressure to all areas of the emblem to ensure full adhesion is achieved.
- 5.5. Carefully remove any markings or tape used to locate the rear emblem. Clean the liftgate surface as needed.

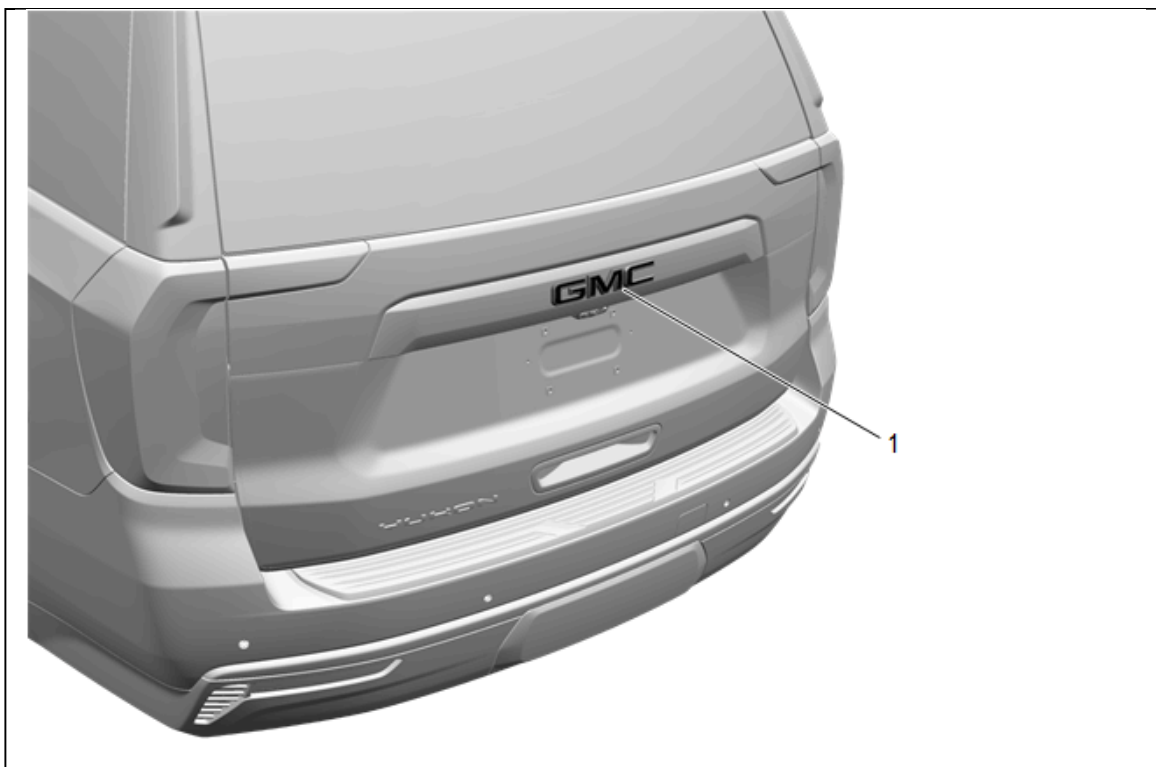

6. Liftgate emblem complete (1).