

Front and Rear Tow Hook Package Installation

Table 1: [Kit Contents – Black Tow Hook \(RPO: SDA\)](#)

Table 2: [Kit Contents – Alternate Color Tow Hook \(RPO: ULK, W0H\)](#)

Note: This document contains Instructions for 2 Accessory Tow Hook Packages: Black Kit (RPO: SDA) and color hooks (RPO: ULK, W0H)

Note: This document contains installation instructions for both rear and front positions.

Installation Instructions Part Number: 85150853

This section applies to the Black (RPO: SDA) Tow Hook Package

Note: P/N 84930570 - Model Years: 2022 - 2023, P/N 86811294 - Model Years: 2022 - 2023, P/N 85640805 - Model Years: 2022+

Note: Each box/kit comes with 1 tow hook. Hummer EV requires two rear tow hooks for rear bumper position.

Note: SUT allows for 2 Accessory rear Tow Hooks. SUV only allows for 1 Accessory rear Tow Hook which must be installed on right side of vehicle.

Kit Contents – Black Tow Hook (RPO: SDA)

Qty	Description
1	Tow hook base
4	Tow hook base bolt
8	Washer
1	D-ring
1	Cross-car-bolt
1	Installation Instructions

Tools required

Power drill

31.75 mm (1-1/4 in) Forstner bit (for drilling through plastic rear fascia)

T-90 6-lobed bit (Torx® or equivalent)

18 mm socket

Loctite PN 89021297

Lloyds Kryptonite™ Metal Treatment P/N 36500 High Temp Satin Black, or equivalent

Procedure Rear Black Tow Hook (RPO: SDA)

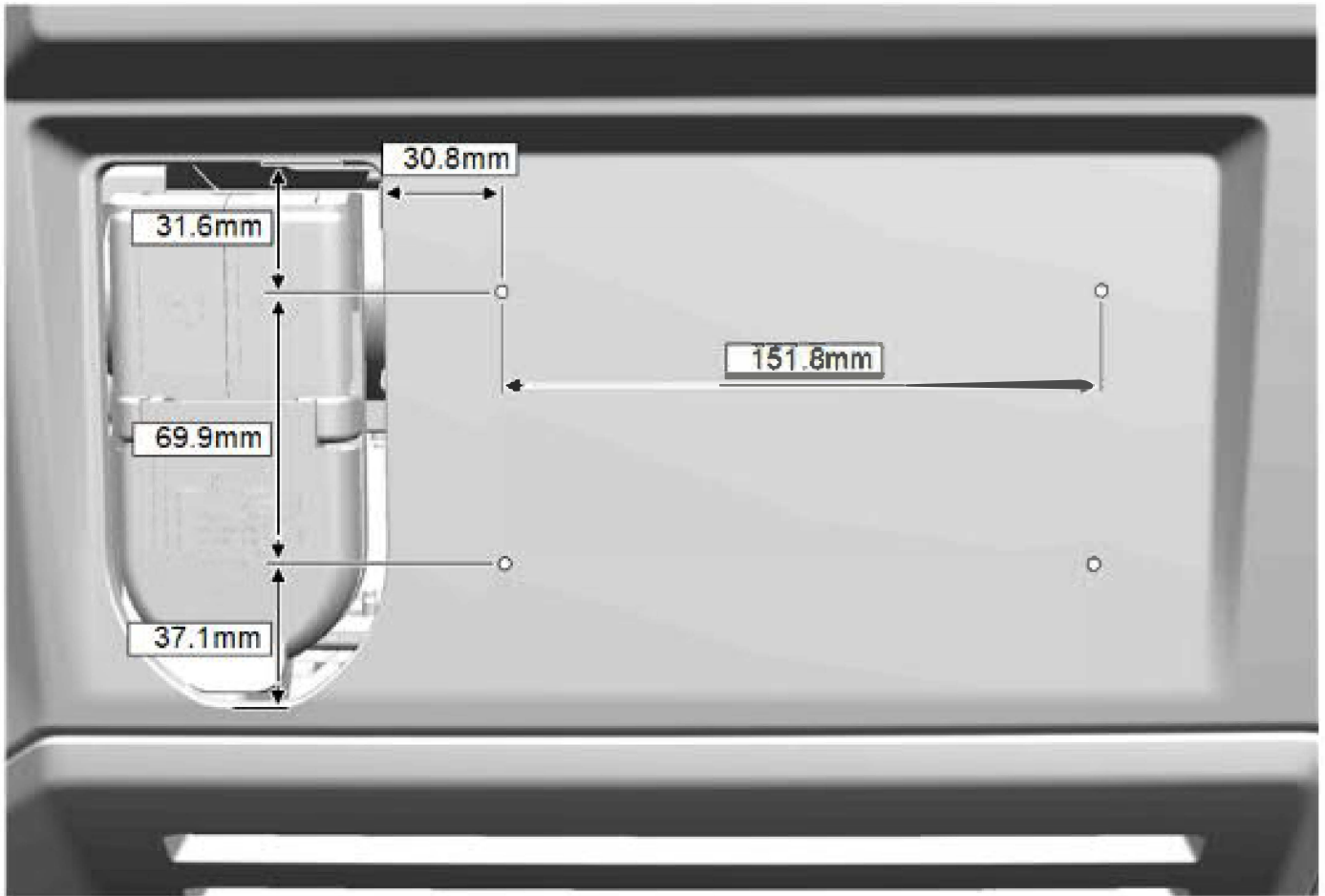

Note: This step is only for SUV if dimple locations do not exist on rear fascia.

1. if dimple locations do not exist on SUV rear bumper fascia, please refer to the dimensions to mark and locate areas to drill.

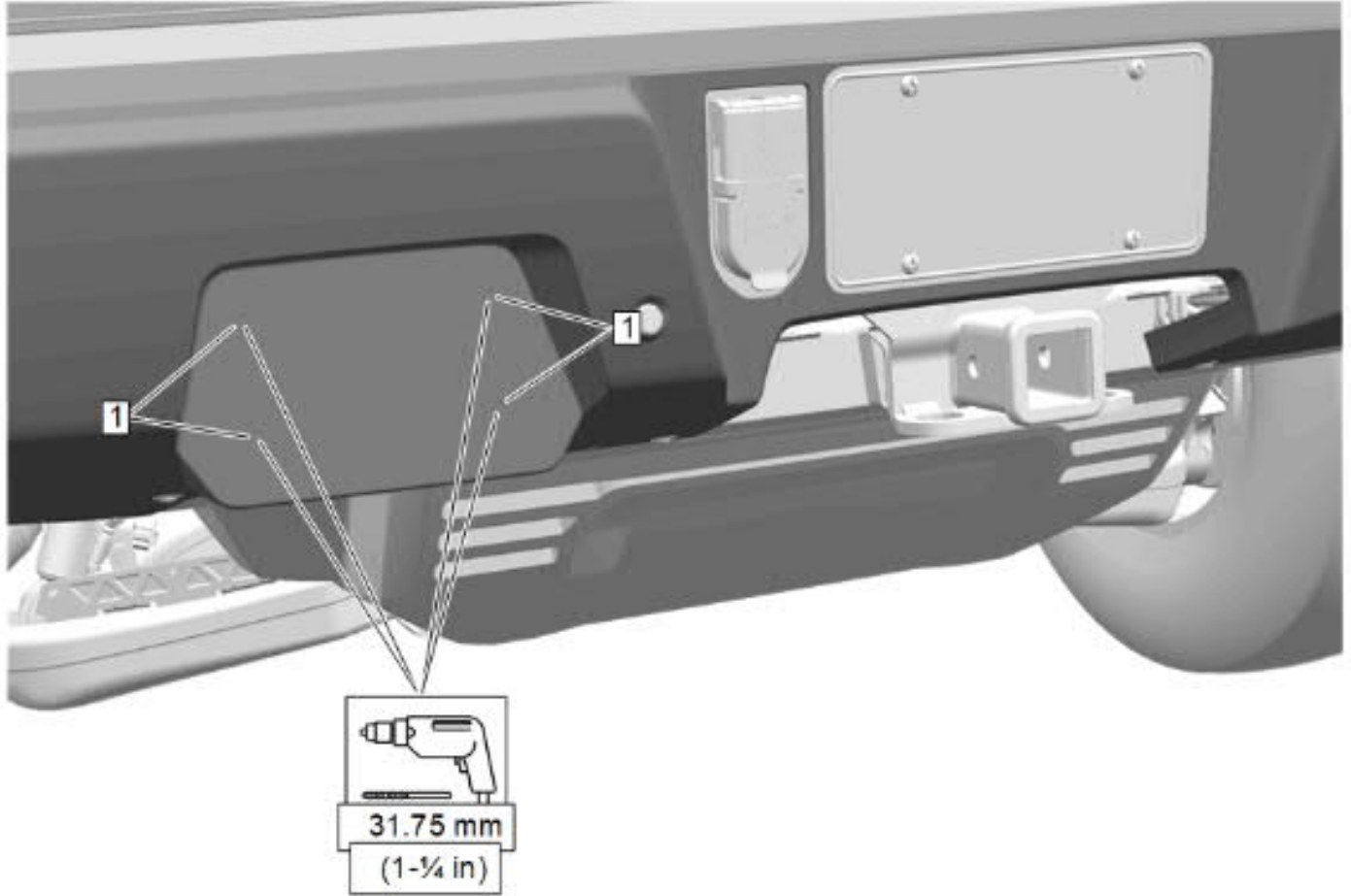

Caution: Always check size and position of all holes before drilling. Failing to do so may cause damage to the vehicle, misalignment of components or the inability to install the accessory.

Caution: Be careful not to damage components behind fascia while drilling.

2. Locate the dimples or the previously marked positions (1) in the rear fascia, using the dimple or marked positions as a guide drill a hole into each of the four dimples or marked positions of rear fascia using a 31.75 mm (1-1/4 in) forstner bit.

Note: If fascia support metal bracket is scratched or scuffed after drilling hole in fascia, apply a light coat of Lloyds Kryptonite™ Metal Treatment P/N 36500 High Temp Satin Black 455 ml (16 oz), or equivalent, to all bare areas of bracket. This coat should flash in approximately 3-5 minutes.

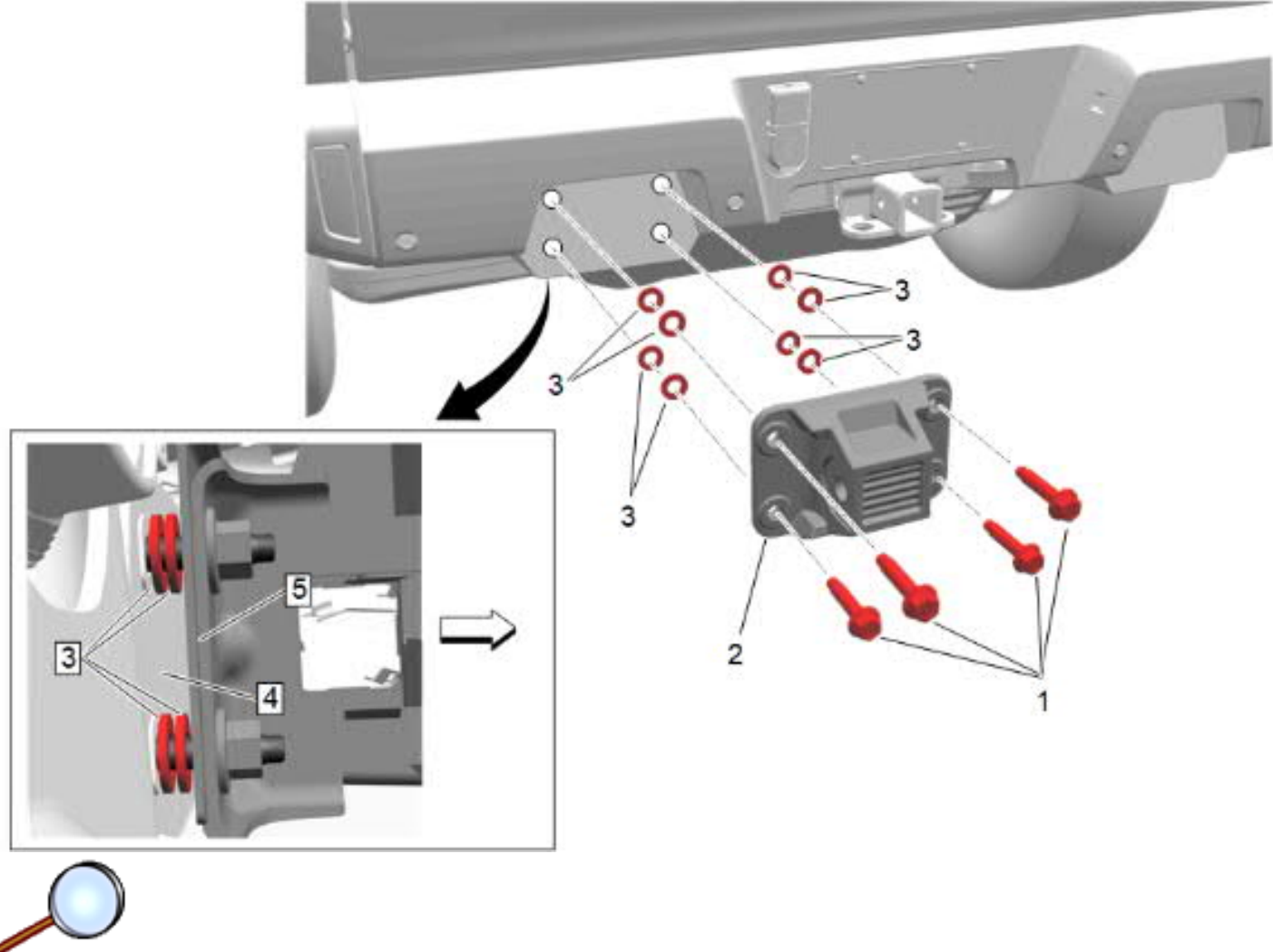

3. Position the tow hook base (2) to the previously drilled holes in rear fascia.

Caution: Use the correct fastener in the correct location. Replacement fasteners must be the correct part number for that application. Fasteners requiring replacement or fasteners requiring the use of thread locking compound or sealant are identified in the service procedure. Do not use paints, lubricants, or corrosion inhibitors on fasteners or fastener joint surfaces unless specified. These coatings affect fastener torque and joint clamping force and may damage the fastener. Use the correct tightening sequence and specifications when installing fasteners in order to avoid damage to parts and systems.

Note: Wrap the D-Ring/hook with protective tape to prevent damage during installation. Remove tape after installation.

4. Loosely install the tow hook base bolts (2) to the tow hook base (2) making sure to add two washers (3) to each bolt behind rear fascia (4) through drilled holes and between the trailer hitch (5). Do not tighten bolts at this time.

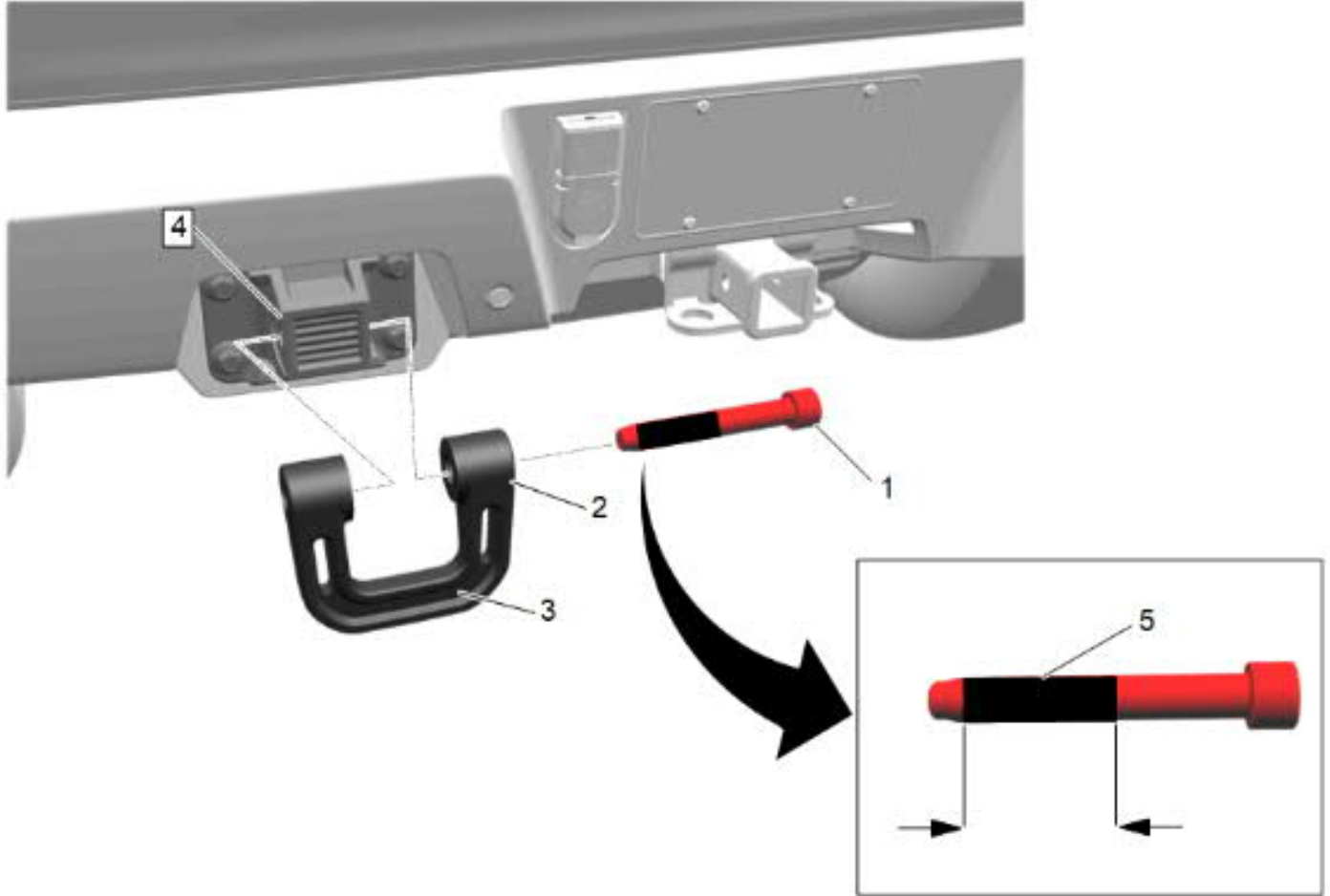

Note: Make sure to leave tow hook base bolts loose enough in order to install the D-ring and cross car bolt.

5. Install the D-ring (2) to the tow hook base (4) making sure the groove (3) in D-ring is facing toward the outside of vehicle.
6. If new threaded components are being installed, loosen the adhesive using a metal pick or similar tool before proceeding. If threaded components are being reused, prepare the threaded components using the following steps:
 - 6.1. Remove any loose cured adhesive from the external threads of the components using a lint free cloth.
 - 6.2. Thread the cleaned components into the internal mating threads and remove to loosen the trapped cured adhesive.
 - 6.3. Remove loose debris from internal and external threads using compressed air.
 - 6.4. Apply liquid thread locking adhesive (5) in a strip along half of the length of the external threads, starting at the tip, just prior to installation.
7. Ensure there are no gaps in the thread locking adhesive once applied to the cross car bolt (1).
8. Install the cross car bolt (1) to D-ring (2).

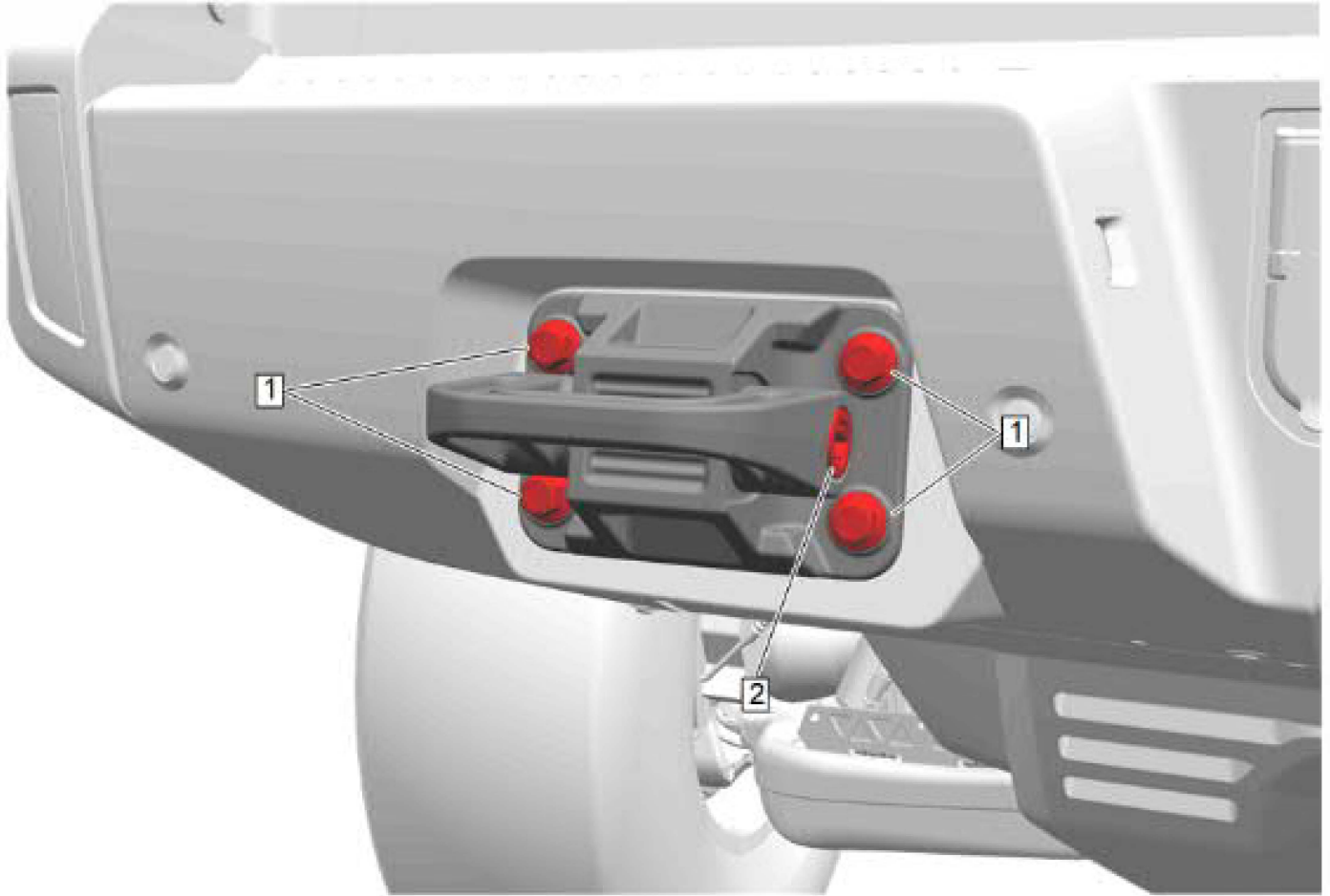

Note: If using kit P/N 84930570, proceed to step 9.1. for cross car bolt torque. If using kit P/N 86811294 or 85640805, proceed to step 9.2. for cross car bolt torque.

Note: Position the D-ring as needed to avoid scratching during the tightening sequence

9. Cross Car Bolt:

9.1. **For Kit P/N 84930570:** Using a T90 Torx bit, tighten the cross car bolt (2) initially to 80 N.m (59 lb ft), then back off the cross car bolt and tighten to 50 N.m (37 lb ft).

9.2. **For Kit P/N 86811294 or 85640805:** Using a T90 Torx bit, tighten the cross car bolt (2) to 35 ±5 N.m (26 lb ft).

Note: Be careful not to squeeze washer. Back down bolt if washer is squeezed.

10. Using an 18 mm socket, tighten the tow hook base bolts (1) in a clockwise pattern to:

10.1. First Pass: **25N•m (18 lb ft)**

10.2. Second Pass: **50N•m (37 lb ft)**

10.3. Third Pass: **75N•m (55 lb ft)**

10.4. Fourth Pass: **100 ±15 N•m (74 lb ft)**

11. Repeat steps for opposite side for additional tow hook kit, if applicable.

Note: Rubber washer should be on head side of T-90 bolt. For SUT vehicle with 2 rear Accessory Tow Hooks, opposite side hooks are in same orientation, i.e., bolt heads will be on same side.

This section applies to the Alternate Color Tow Hook (RPO: ULK, W0H) Tow Hook Package

Note: Must first purchase rear tow hook black package (RPO Code: SDA) to obtain mounting hardware.

Note: Each box/kit comes with 1 tow hook. 2 hooks are required for bumper position.

Note: SUT allows for 2 Accessory rear Tow Hooks. SUV only allows for 1 Accessory rear Tow Hook.

- One rear tow hook included in box/package
- Hummer EV requires two rear tow hooks for rear bumper position if equipped with RPO code SDA

Kit Contents – Alternate Color Tow Hook (RPO: ULK, W0H)

Qty	Description
1	D-ring
1	Installation Instructions

Tools required

- T-90 6-lobed bit (Torx® or equivalent)
- 18 mm socket
- Torque Wrench
- Loctite PN 89021297

Procedure Rear Alternate Color Tow Hook (RPO: ULK, W0H)

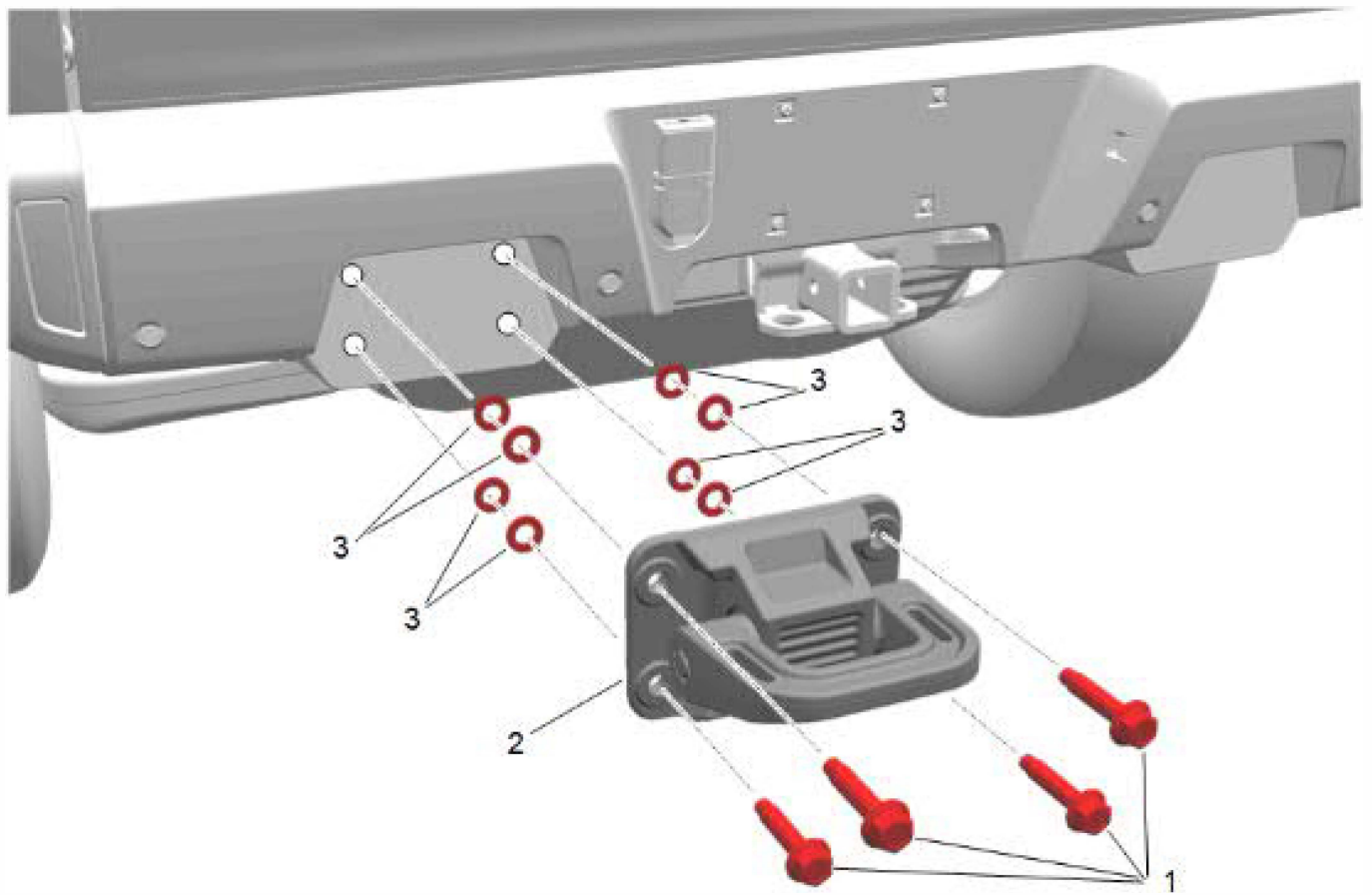

1. Remove the bolts (1) from the tow hook base (2) and carefully remove tow hook base (2) and washers (3) from vehicle. Retain bolts and washers.

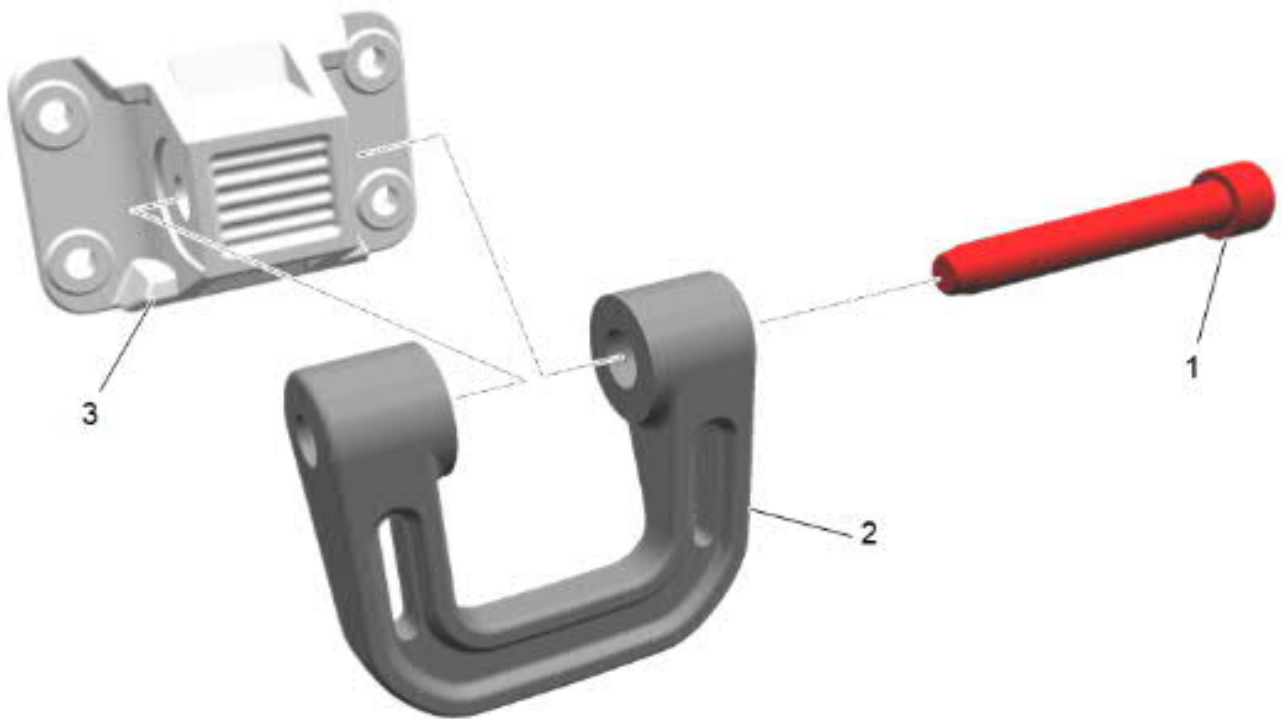

2. Remove the cross-car bolt/washer (1). Retain bolt/washer.
3. Remove D-ring (2) from tow hook base (3).

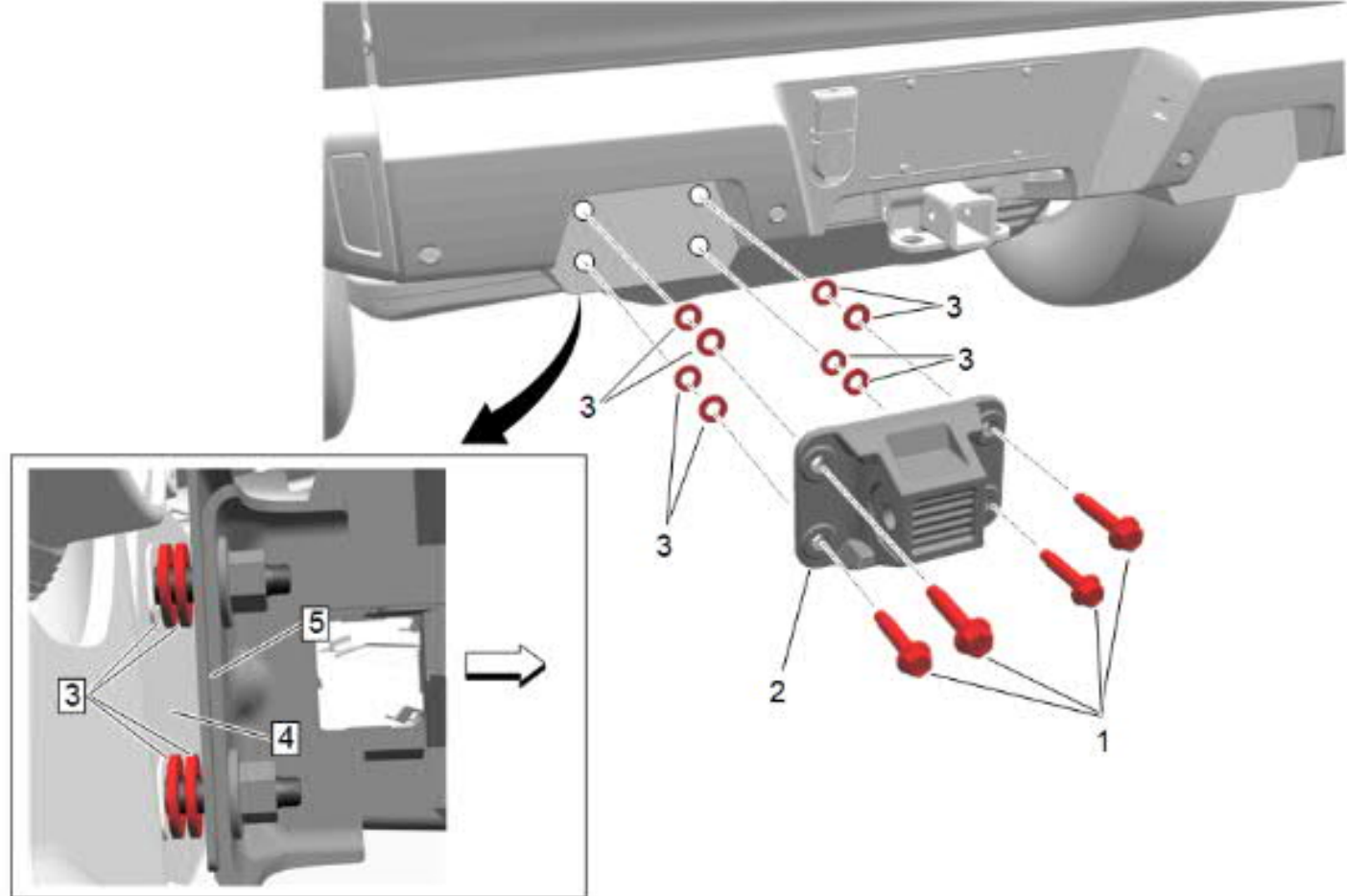

4. Position the tow hook base (2) to the holes in rear fascia.

Caution: Use the correct fastener in the correct location. Replacement fasteners must be the correct part number for that application. Fasteners requiring replacement or fasteners requiring the use of thread locking compound or sealant are identified in the service procedure. Do not use paints, lubricants, or corrosion inhibitors on fasteners or fastener joint surfaces unless specified. These coatings affect fastener torque and joint clamping force and may damage the fastener. Use the correct tightening sequence and specifications when installing fasteners in order to avoid damage to parts and systems.

Note: Wrap the D-Ring/hook with protective tape to prevent damage during installation. Remove tape after installation.

5. Loosely install the tow hook base bolts (2) to the tow hook base (2) making sure to add two washers (3) to each bolt behind rear fascia (4) through holes and between the trailer hitch (5). Do not tighten bolts at this time.

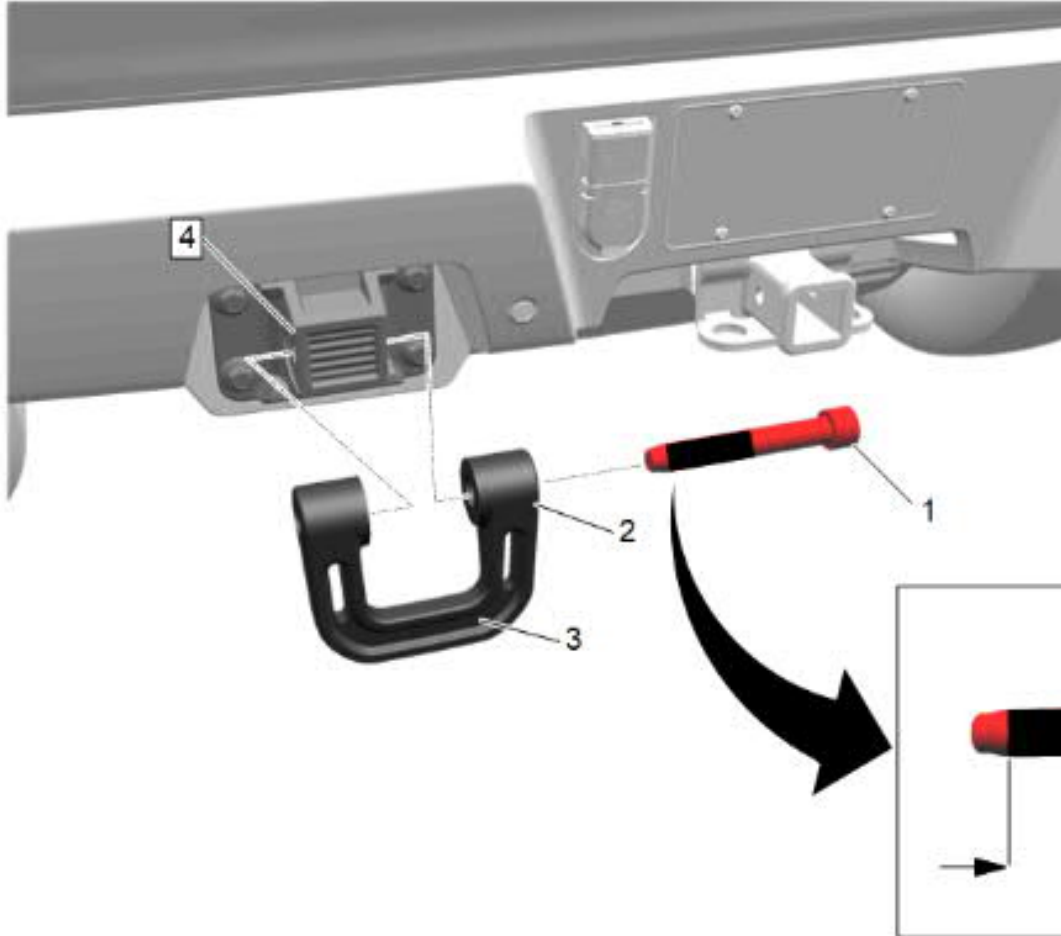

Note: Make sure to leave tow hook base bolts loose enough in order to install the D-ring and cross car bolt.

6. Install the D-ring (2) to the tow hook base (4) making sure the groove (3) in D-ring is facing toward the outside of vehicle.
7. If new threaded components are being installed, loosen the adhesive using a metal pick or similar tool before proceeding. If threaded components are being reused, prepare the threaded components using the following steps:
 - 7.1. Remove any loose cured adhesive from the external threads of the components using a lint free cloth.
 - 7.2. Thread the cleaned components into the internal mating threads and remove to loosen the trapped cured adhesive.
 - 7.3. Remove loose debris from internal and external threads using compressed air.
 - 7.4. Apply liquid thread locking adhesive (5) in a strip along half of the length of the external threads, starting at the tip, just prior to installation.
8. Install the cross car bolt (1) to D-ring (2).

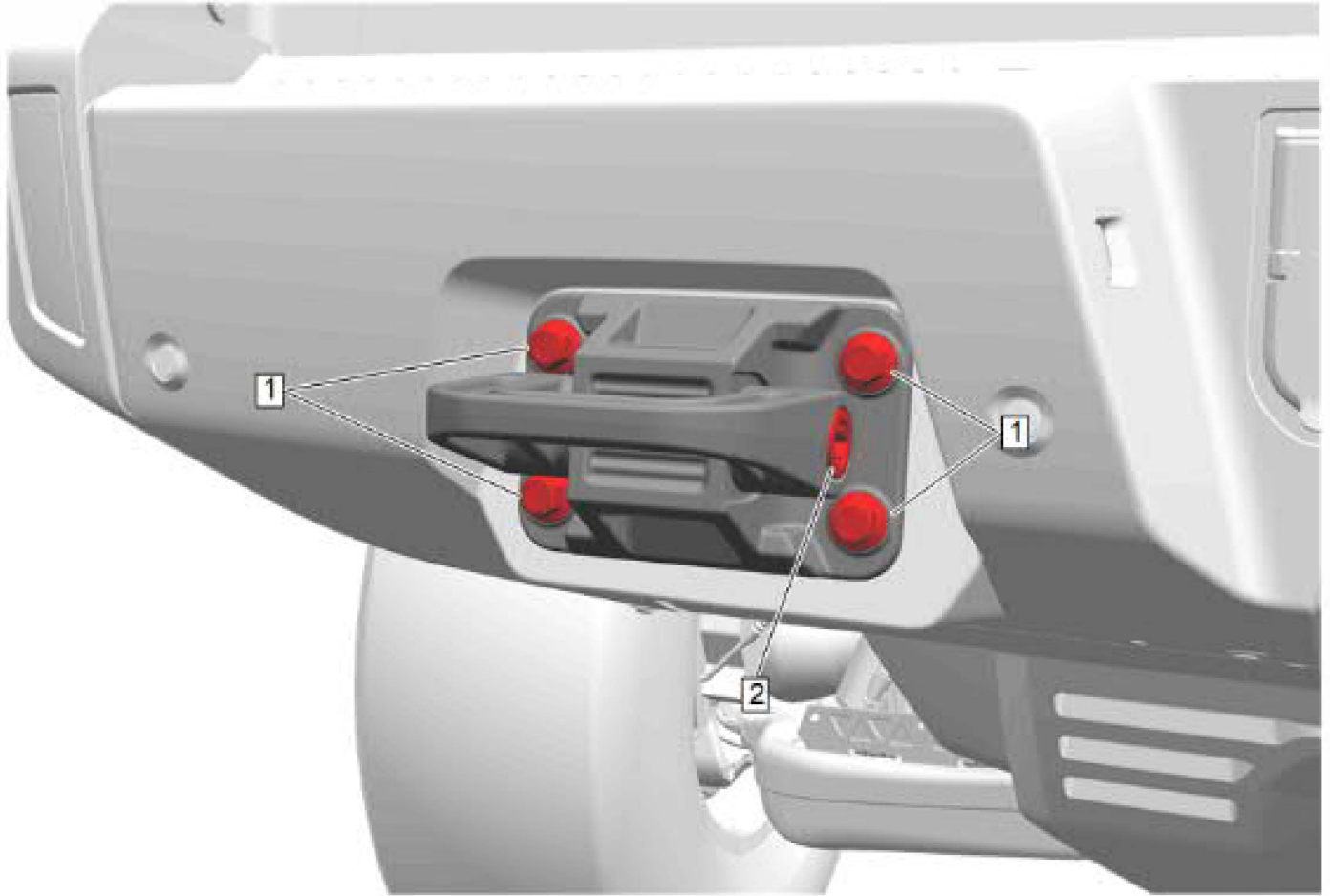

Note: If using kit P/N 84930570, proceed to step 9.1. for cross car bolt torque. If using kit P/N 86811294 or 85640805, proceed to step 9.2. for cross car bolt torque.

Note: Position the D-ring as needed to avoid scratching during the tightening sequence

9. Cross Car Bolt:

9.1. **For Kit P/N 84930570:** Using a T90 Torx bit, tighten the cross car bolt (2) initially to 80 N.m (59 lb ft), then back off the cross car bolt and tighten to 50 N.m (37 lb ft).

9.2. **For Kit P/N 86811294 or 85640805:** Using a T90 Torx bit, tighten the cross car bolt (2) to 35 ±5 N.m (26 lb ft).

Note: Be careful not to squeeze washer. Back down bolt if washer is squeezed.

10. Using an 18 mm socket, tighten the tow hook base bolts (1) in a clockwise pattern to:

10.1. First Pass: **25 N•m (18 lb ft)**

10.2. Second Pass: **50 N•m (37 lb ft)**

10.3. Third Pass: **75 N•m (55 lb ft)**

10.4. Fourth Pass: **100 ±15 N•m (74 lb ft)**

11. Repeat steps for opposite side for additional tow hook kit, if applicable.

Note: Rubber washer should be on head side of T-90 bolt. For SUT vehicle with 2 rear Accessory Tow Hooks, opposite side hooks are in same orientation, i.e., bolt heads will be on same side.

Procedure Front Alternate Color Tow Hook (RPO: ULK, W0H)

Removal Procedure

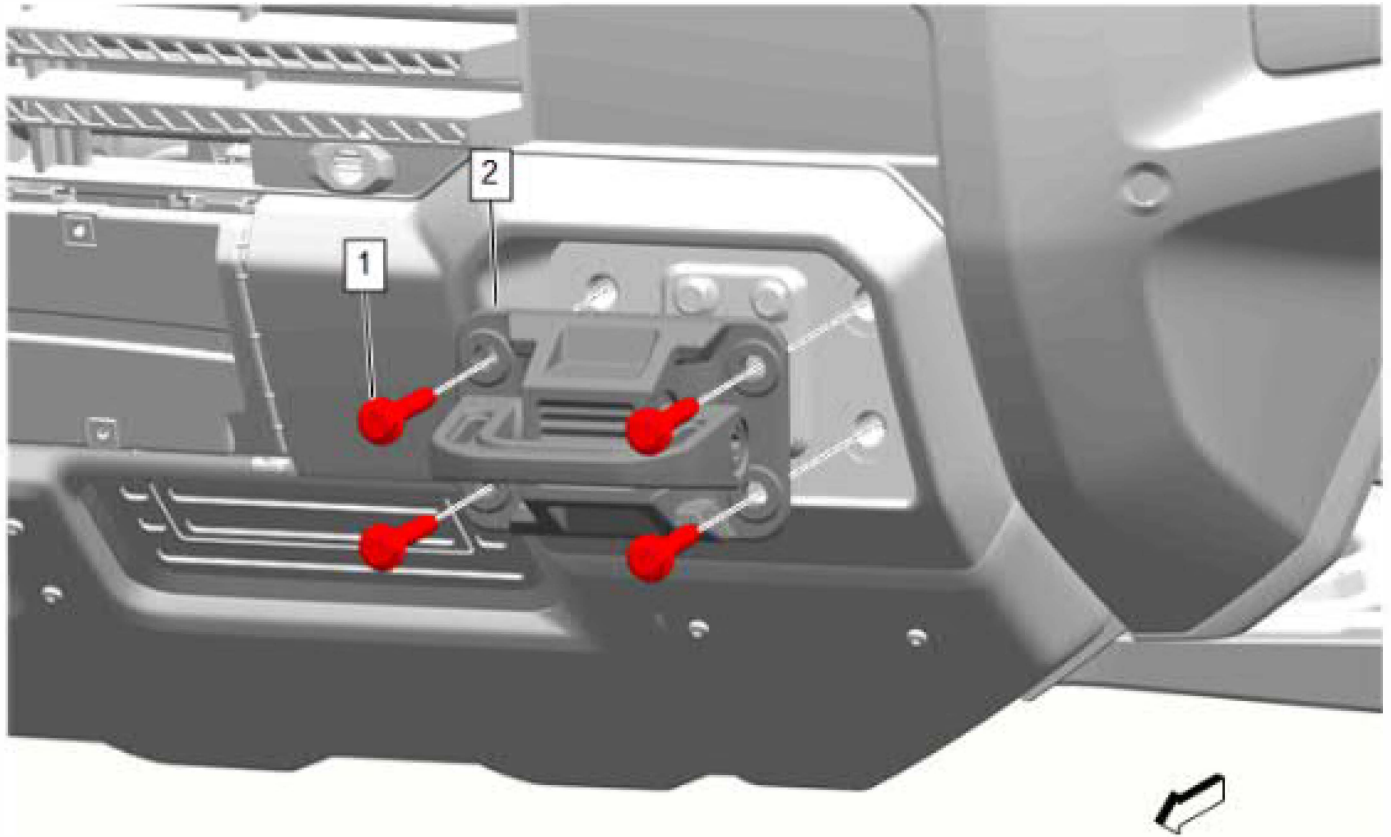

1. Remove the bolts (1) from the tow hook base (2) and carefully remove tow hook base (2) from vehicle. Retain bolts and washers.

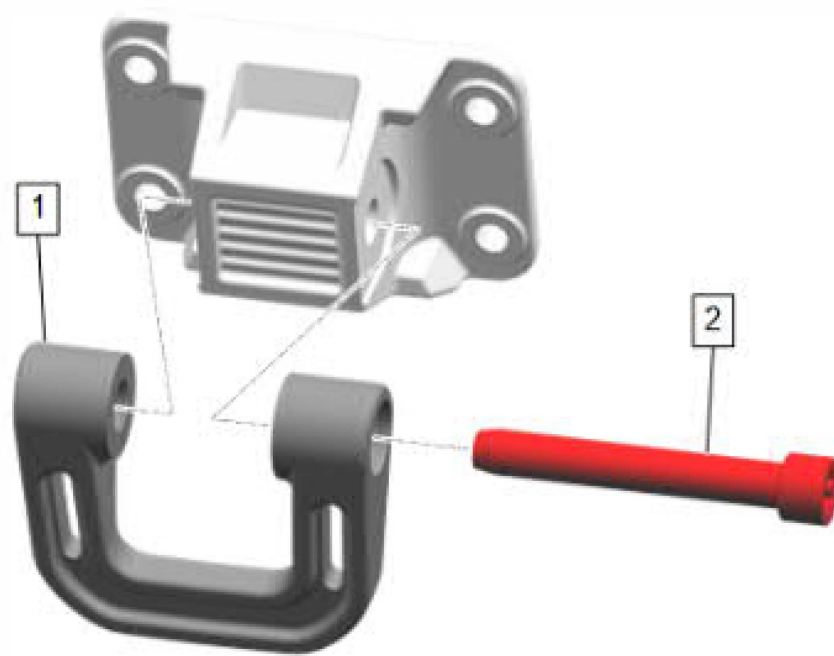

2. Remove the cross-car bolt/washer (2). Retain bolt/washer.
3. Remove D-ring (1) from tow hook base.

Installation Procedure

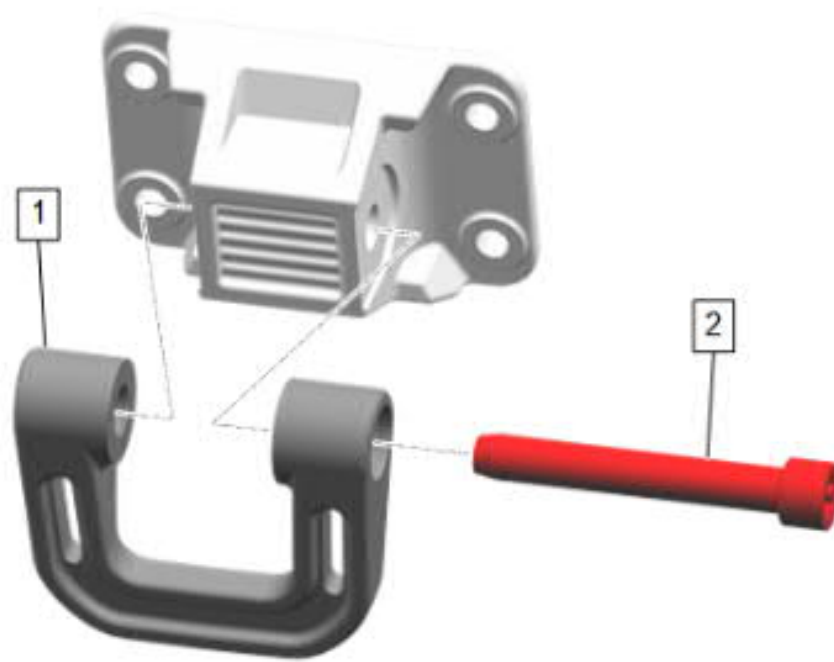

1. Install the D-ring (1) to the tow hook base making sure the groove in D-ring is facing toward the outside of the vehicle.

Caution: Use the correct fastener in the correct location. Replacement fasteners must be the correct part number for that application. Fasteners requiring replacement or fasteners requiring the use of thread locking compound or sealant are identified in the service procedure. Do not use paints, lubricants, or corrosion inhibitors on fasteners or fastener joint surfaces unless specified. These coatings affect fastener torque and joint clamping force and may damage the fastener. Use the correct tightening sequence and specifications when installing fasteners in order to avoid damage to parts and systems.

Note: Do not install thread locker on the first two threads on cross car bolt.

2. Remove any loose cured adhesive from the external threads of the cross bar bolt (2) using a lint-free cloth.
3. Thread the cleaned cross car bolt (2) into the internal mating threads of D-ring (1) and remove to loosen trapped cured adhesive.
4. Apply thread locking adhesive to the external threads of the cross car bolt (2).
5. Ensure there are no gaps in the thread locking adhesive once applied to the cross car bolt (2).
6. Install the cross car bolt (2) to D-ring (1). Tighten the cross car bolt (2) to 35 ± 5 N.m (26 lb ft).

Note: Be careful not to squeeze washer. Back down bolt if washer is squeezed.

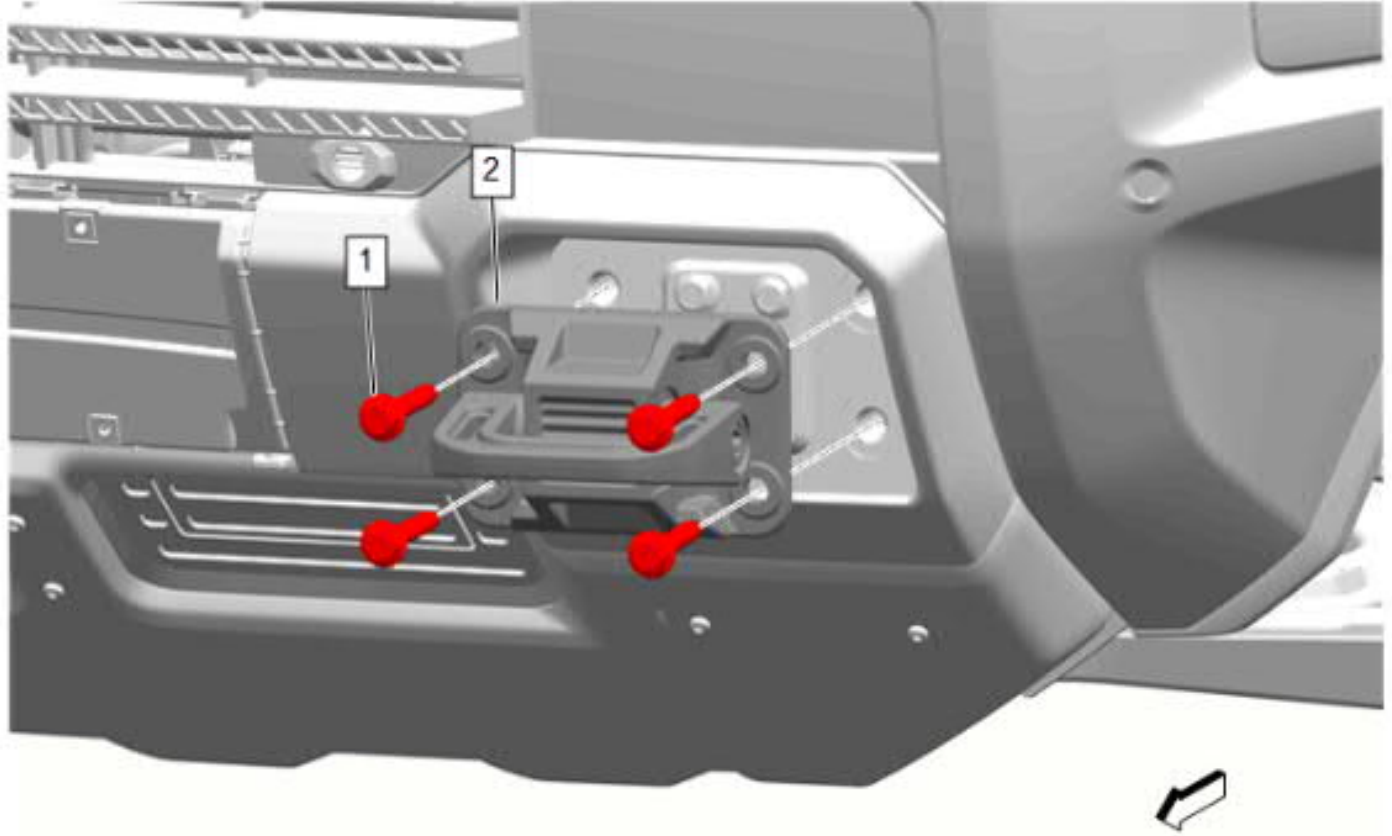

7. Position the front tow hook bracket (2) to the holes in front bumper fascia.
8. Install the bolts (1) to the front tow hook bracket (2).
9. Using an 18 mm socket, tighten the tow hook base bolts (1) in a clockwise pattern to:
 - 9.1. First Pass: **25 N•m (18 lb ft)**
 - 9.2. Second Pass: **50 N•m (37 lb ft)**
 - 9.3. Third Pass: **75 N•m (55 lb ft)**
 - 9.4. Fourth Pass: **100 ±15 N•m (74 lb ft)**
10. Repeat steps for opposite side for additional tow hook kit, if applicable.