

# Luggage Carrier Cross Rail Kit Installation

## Installation Instructions Part Number

85551190

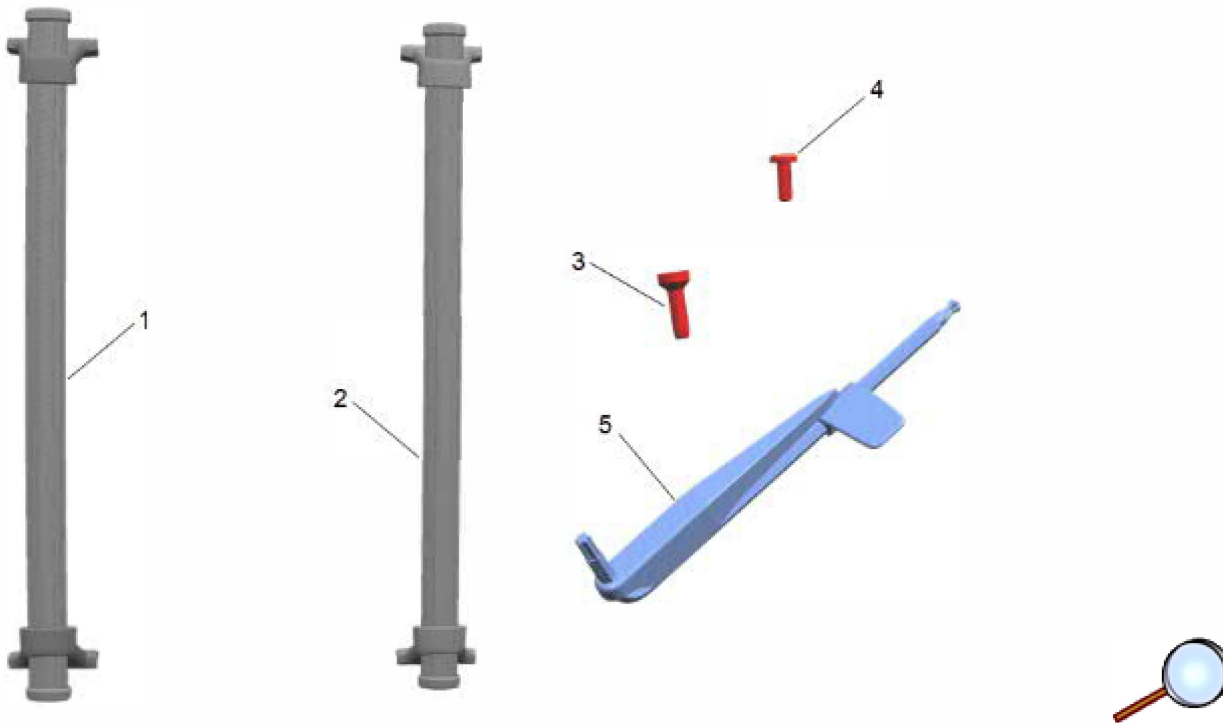

### Kit Contents

Item No.	Qty	Description
1	1	Front Cross Rail
2	1	Rear Cross Rail
-	1	Hardware Kit
3	8	M6 x 24 Bolt
4	4	M6 Set Screws
5	1	Torque Wrench
-	1	Installation Instructions

### Tools Required

Pry Tool

### Procedure

**Warning:** The load you are carrying plus the weight of the rack must not exceed the maximum weight of 220 lbs.

**Note:** This installation requires 2 people for proper installation to avoid vehicle damage.

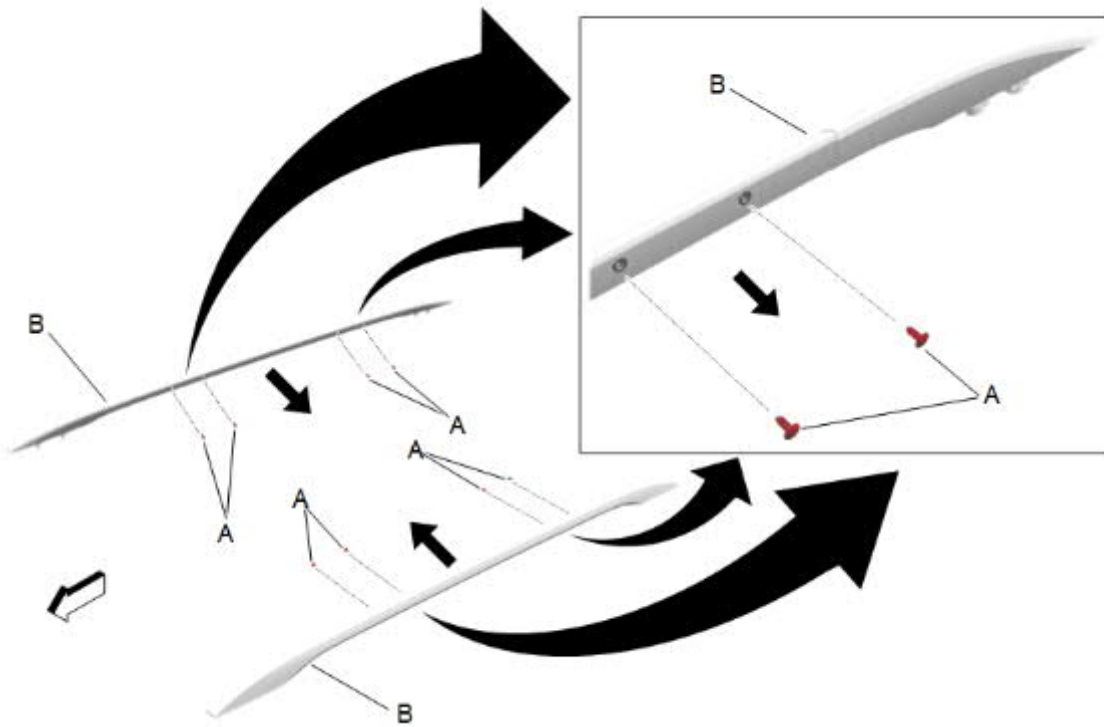

1. Remove the 8 plugs (A) from Luggage Carrier Side Rails (B) by twisting the plugs counter clockwise by hand or removing the plug by using a pry tool.

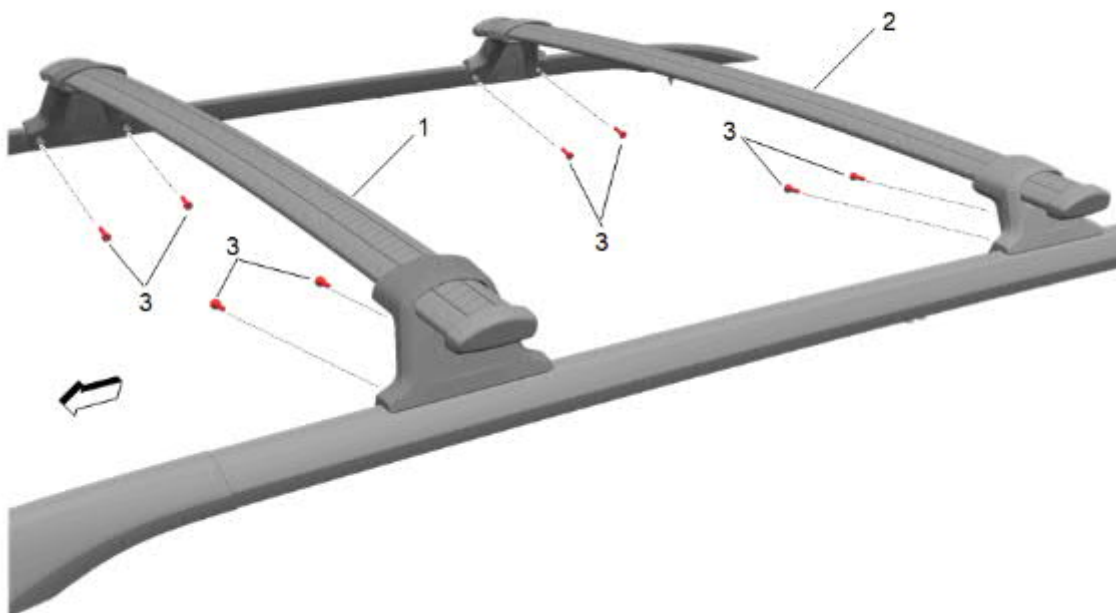

**Caution:** Use the correct fastener in the correct location. Replacement fasteners must be the correct part number for that application. Fasteners requiring replacement or fasteners requiring the use of thread locking compound or sealant are identified in the service procedure. Do not use paints, lubricants, or corrosion inhibitors on fasteners or fastener joint surfaces unless specified. These coatings affect fastener torque and joint clamping force and may damage the fastener. Use the correct tightening sequence and specifications when installing fasteners in order to avoid damage to parts and systems.

2. Line up the holes from front (1) and rear (2) Cross Rails with the holes in the Side Rails. Install the 8-M6 x 25 bolts (3) through the Cross Rails and into the Side Rails.

**Note:** The arrows on the Cross Rails face the front of the vehicle.

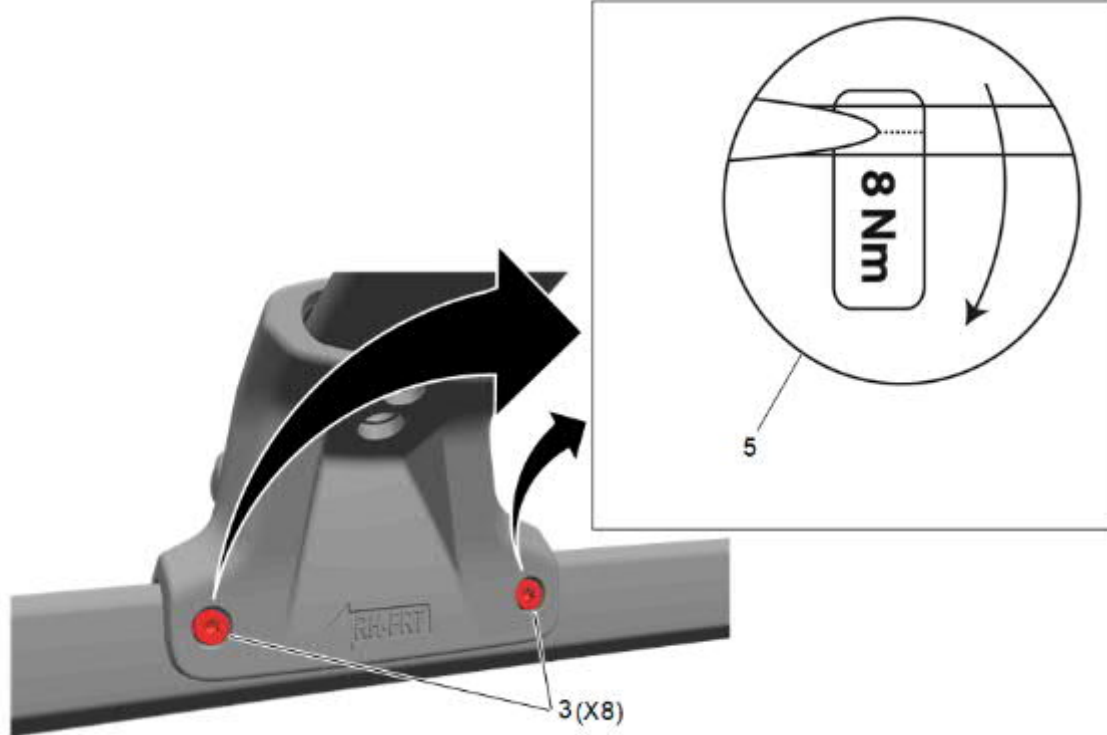

- Use item (Torque Wrench) (5) to tighten all 8 of M6 x 25 bolts (3). Torque the wrench until the needle lines up with the line to assure that proper torque is reached. (8 Nm)

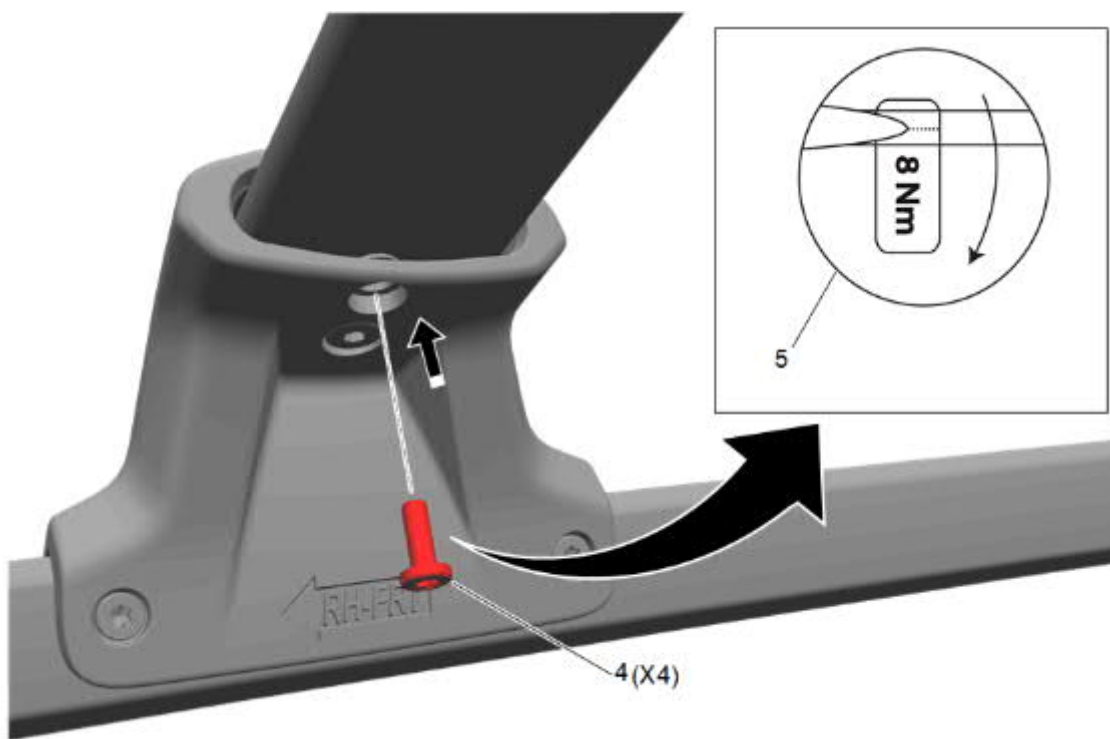

- Install the M6 set screws (4) into the underside of each cross rail stanchion (two set screws per Cross Rail) with supplied torque wrench (5). Torque the wrench until the needle lines up with indicator line to assure that proper torque is reached. (8 N.m)