

## Front Grille Insert Package Installation (Instruction ID: 84765004)

### Installation Instructions Part Number

84765004

#### Kit Contents

Qty	Description
1	Front Grille Insert – LH
1	Front Grille Insert – RH
1	Grille Emblem Adapter
1	Installation Instructions

© 2024 General Motors. All rights reserved.

### Procedure

#### Remove OEM Grille Insert

**Note:** Upon removing the front bumper fascia, complete removal of the front wheelhouse liner is not required. Remove only the front section of wheelhouse liner and pull back wheelhouse liner to access front bumper fascia retainers.

1. Remove the front bumper fascia. Refer to [Front Bumper Fascia Removal and Installation](#) in Vehicle Service Manual.
2. Disassemble the grille from the front bumper fascia. Refer to [Front Grille Replacement](#) in Vehicle Service Manual.

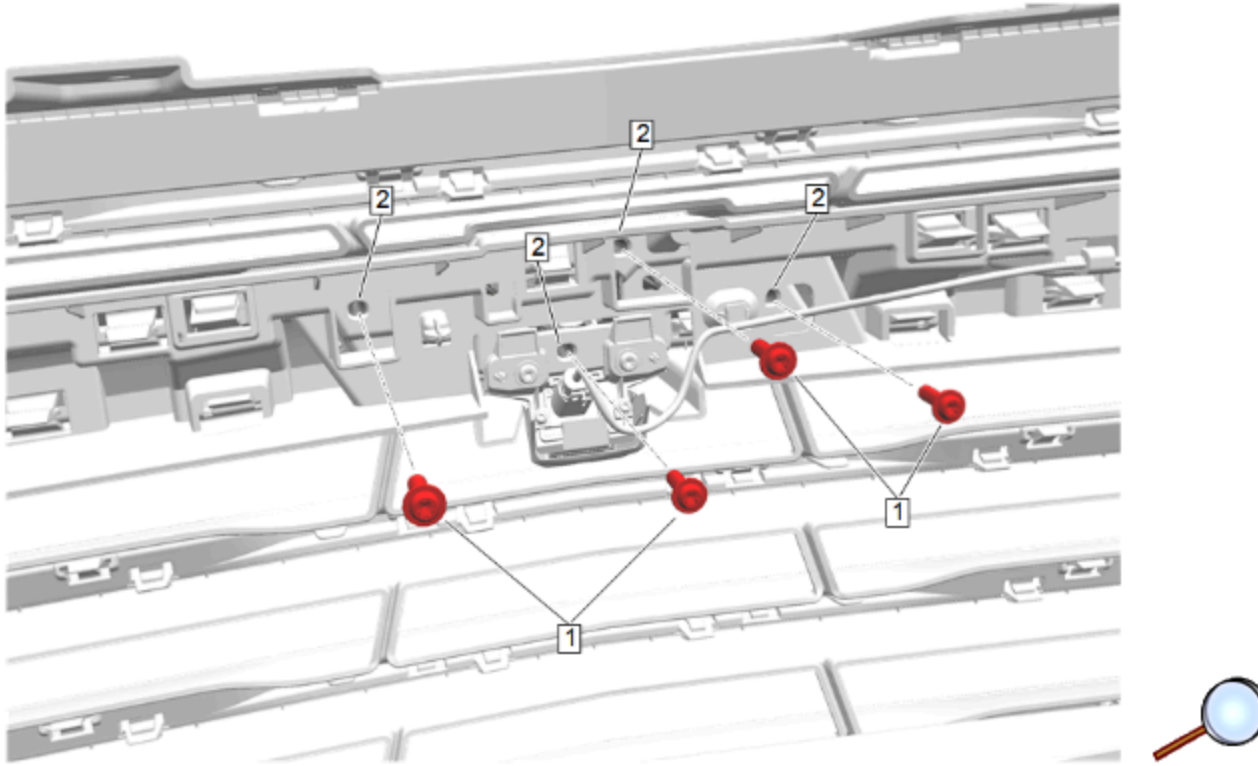

**Note:** If the customer chooses to keep the existing grille emblem, refer to steps 3 thru 5. Customer may also choose to order and install an accessory grille emblem offered as a separate accessory kit.

3. Remove the front grille emblem adapter bolts (1) Qty: 4 from the front grille emblem adapter (2).

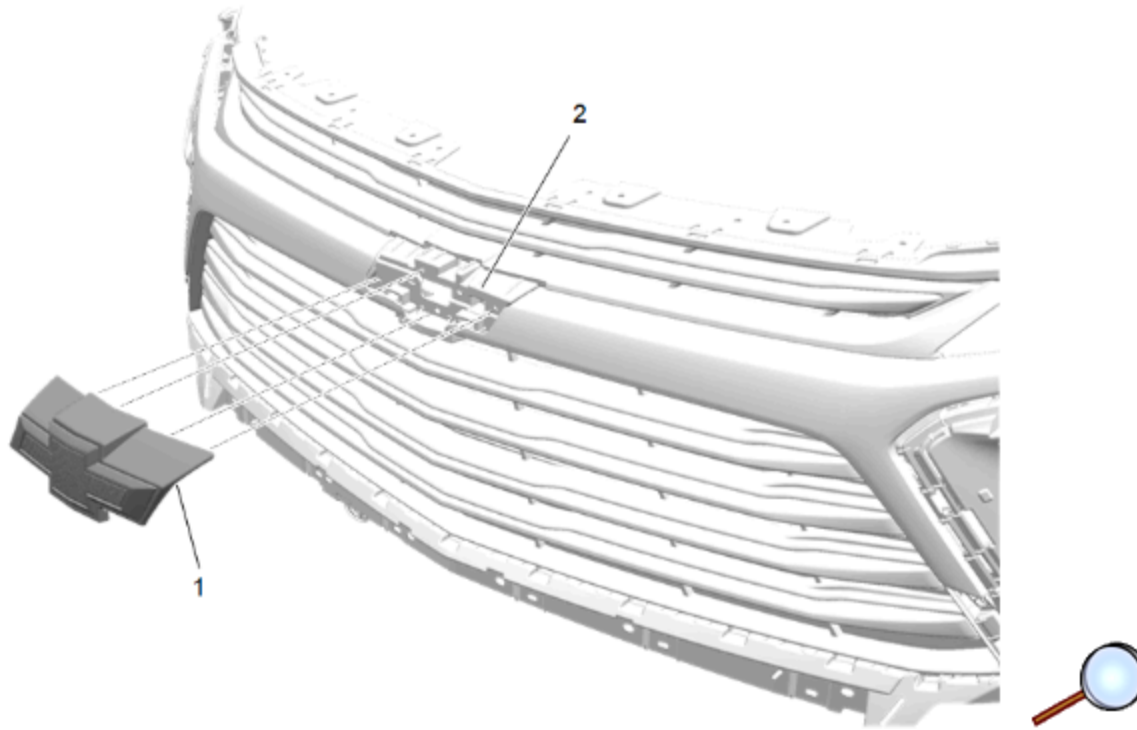

© 2024 General Motors. All rights reserved.

4. Remove the front grille emblem and adapter (1) from front grille (2).

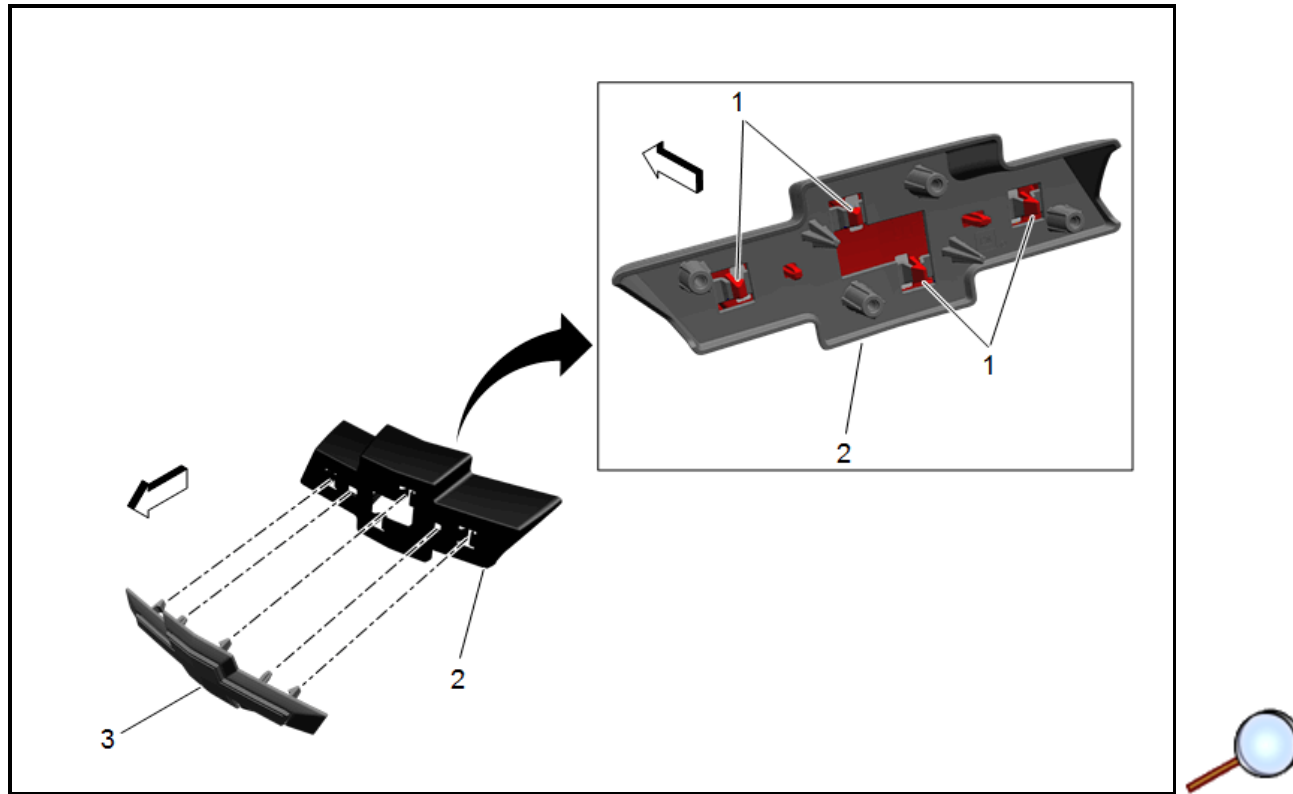

5. Disengage the retaining tabs (1) and remove the production bowtie emblem (3) from the emblem adaptor (2).

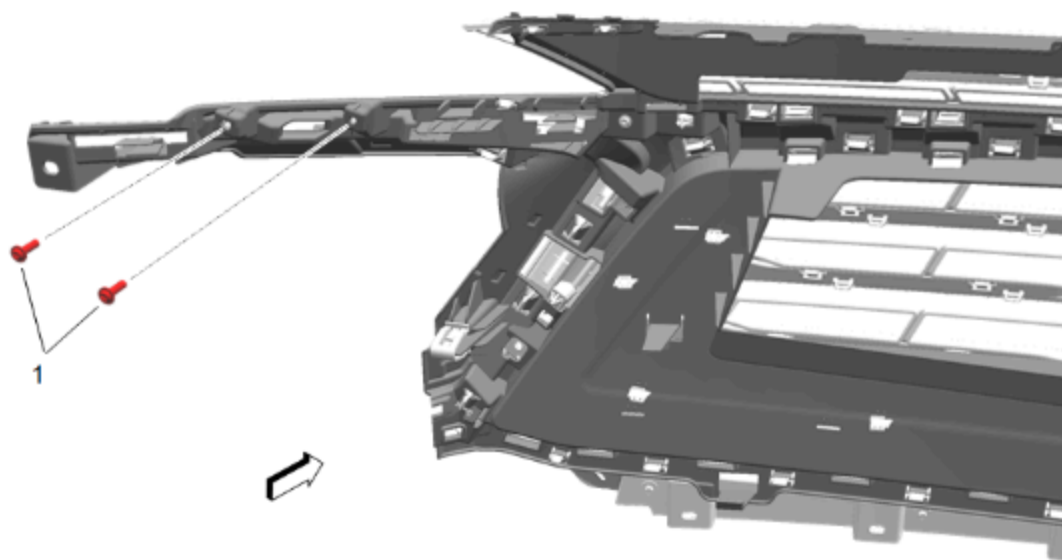

© 2024 General Motors. All rights reserved.

6. Remove and retain the upper (1) front fascia grille insert bolts.

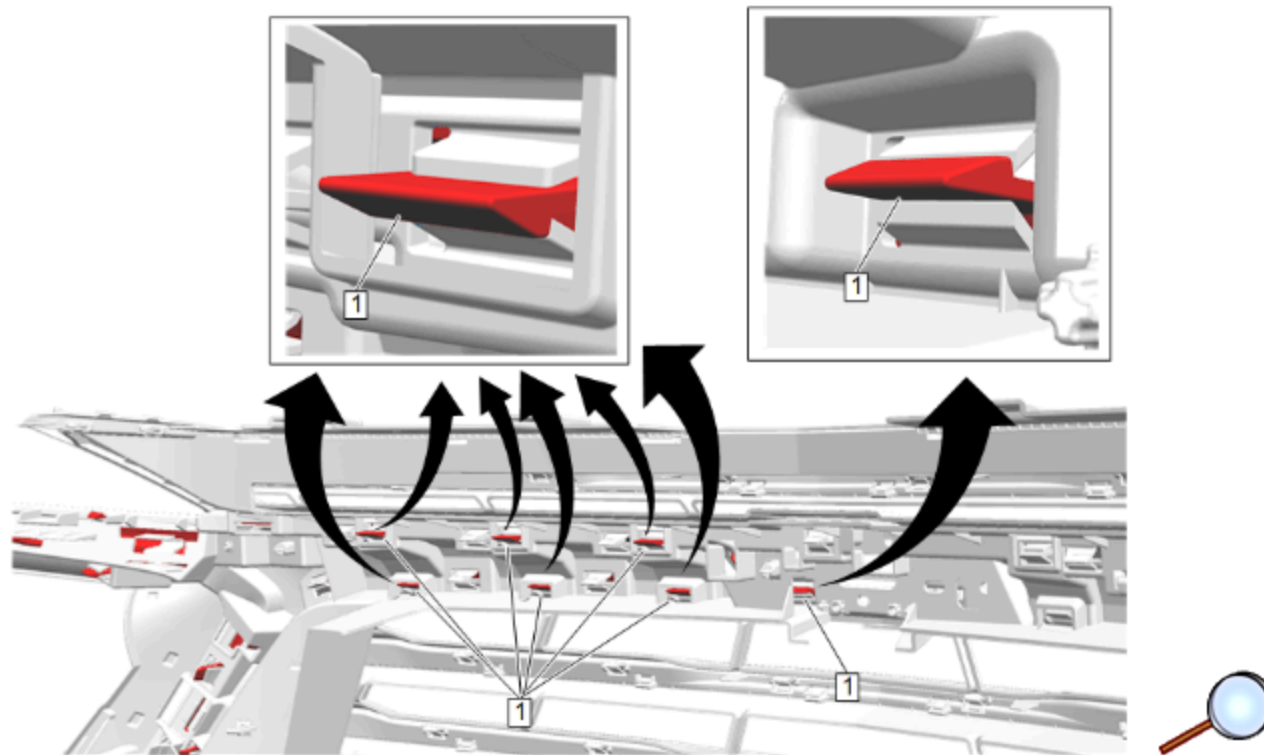

© 2024 General Motors. All rights reserved.

7. Carefully release the seven locking tabs (1).

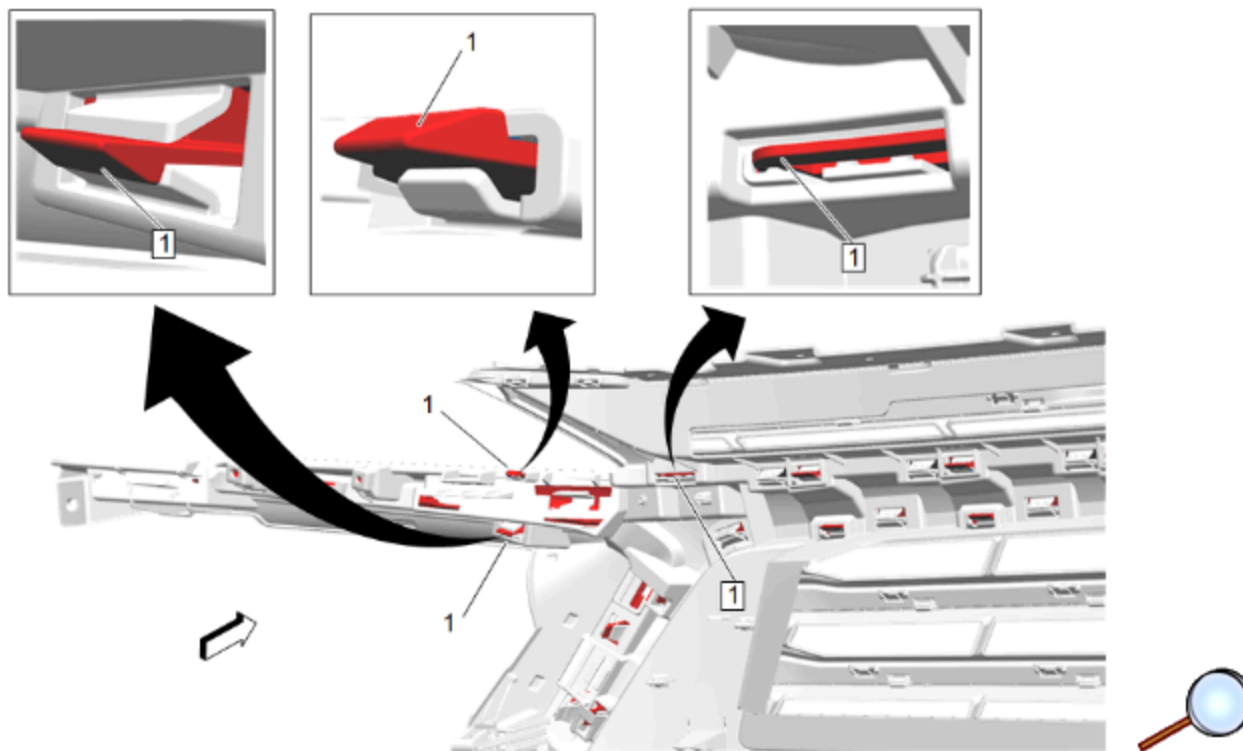

© 2024 General Motors. All rights reserved.

8. Carefully release the three locking tabs (1).

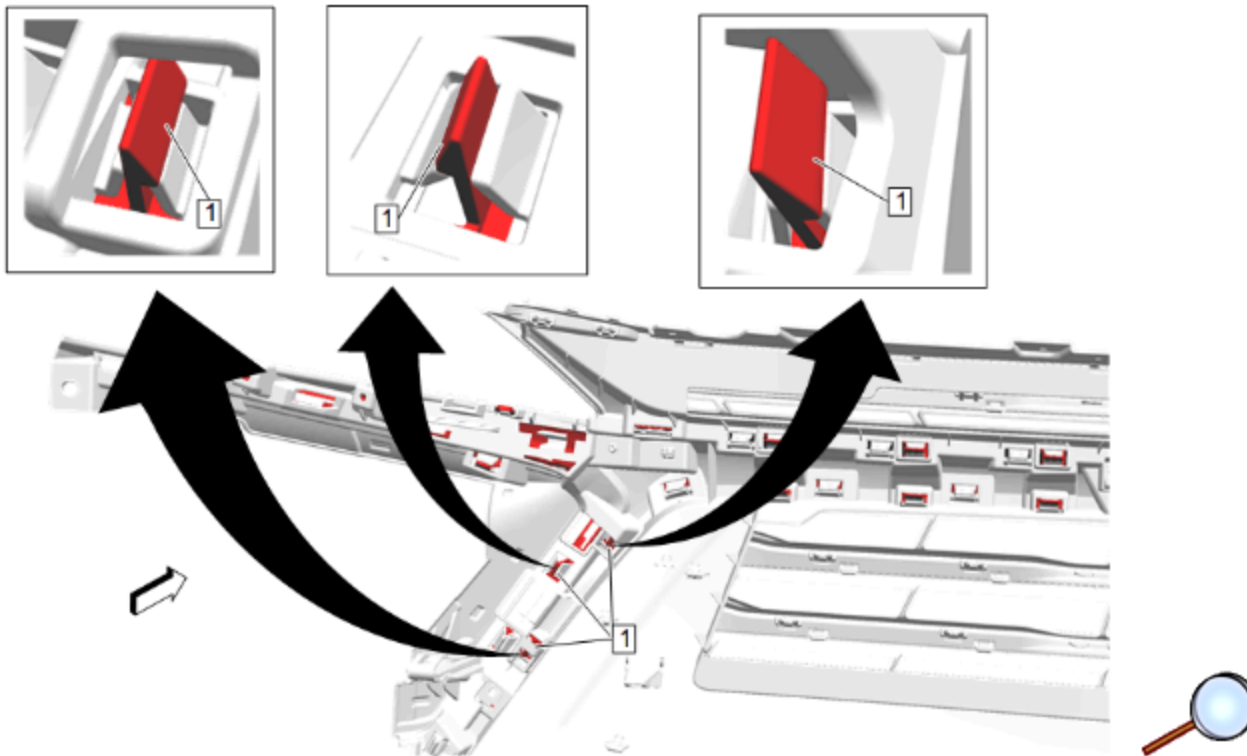

© 2024 General Motors. All rights reserved.

9. Carefully release the three locking tabs (1).

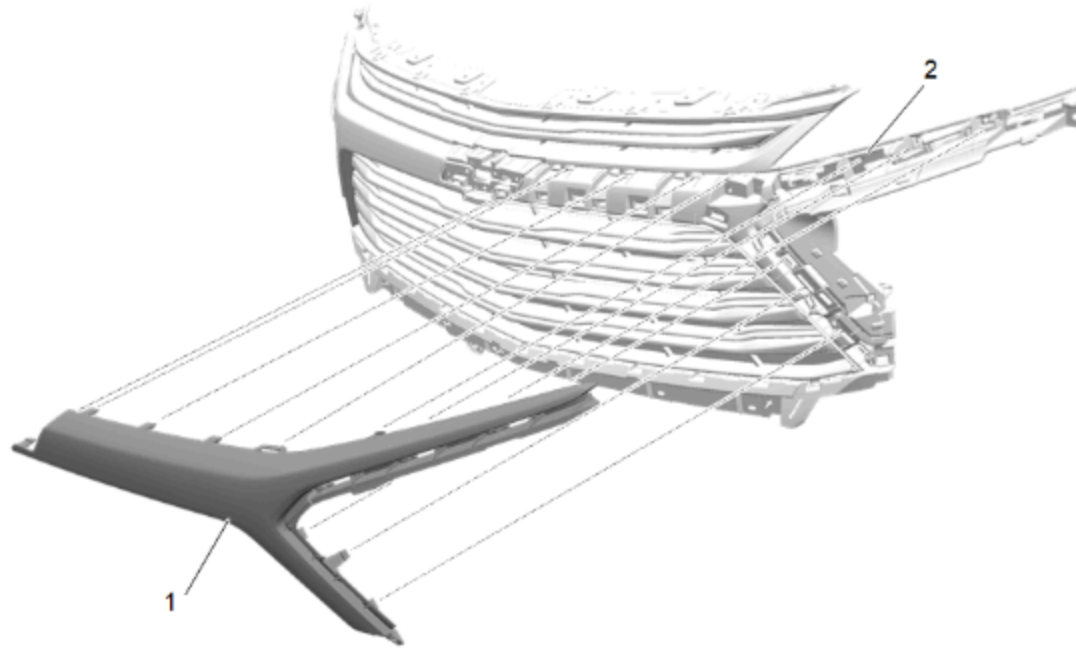

10. Carefully remove the grille insert (1) from the front grille (2).

11. Repeat steps 6 thru 10 for opposite side grille insert.

### **Install New Grille**

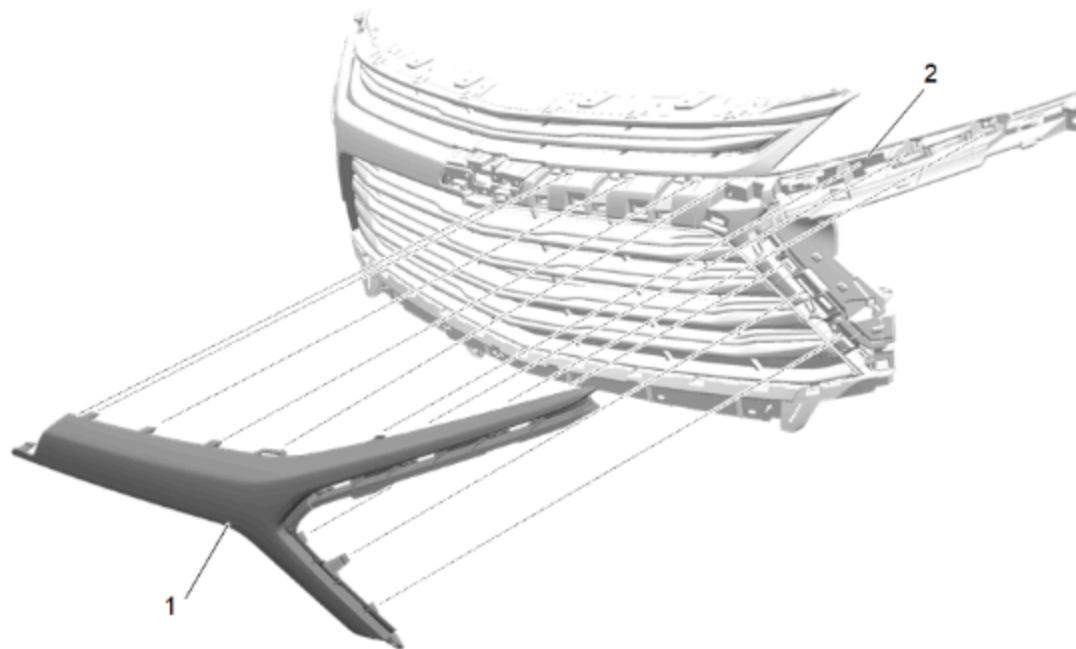

1. Carefully reposition and install the grille insert (1) to the grille (2) lining up the locking tabs.

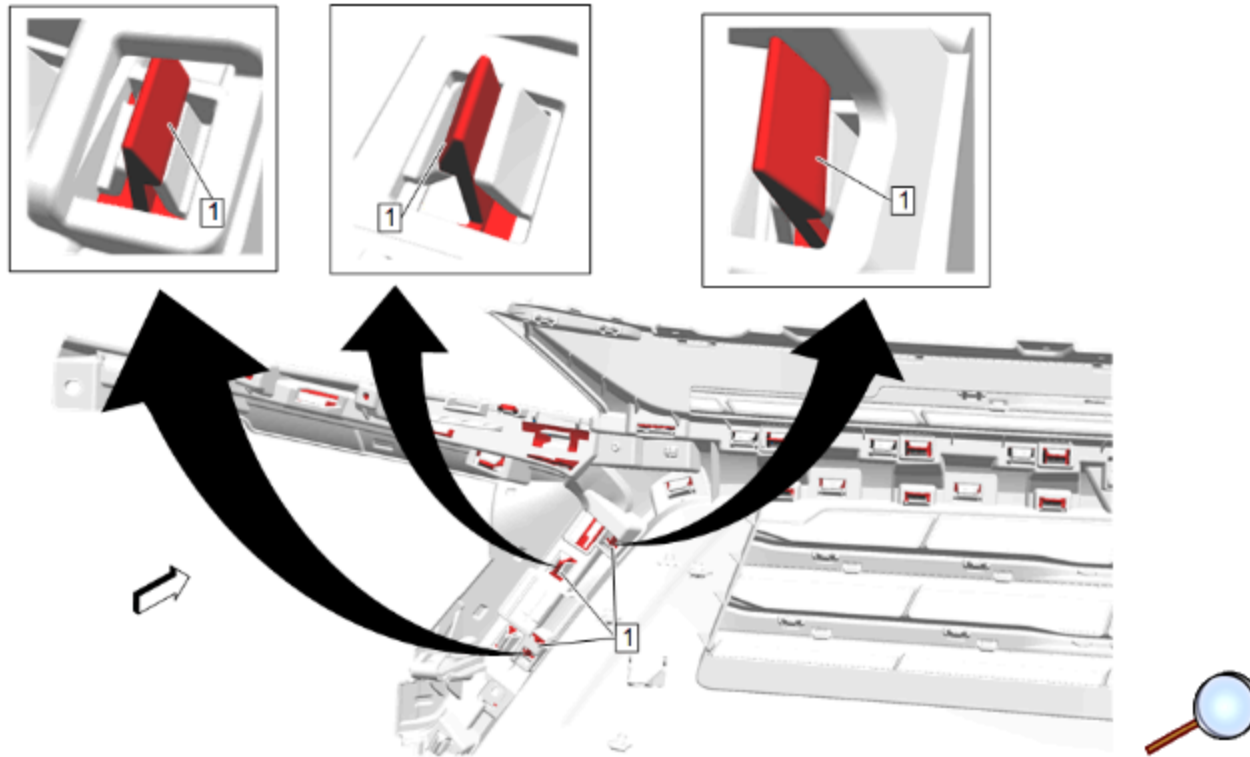

2. Carefully engage the three locking tabs (1).

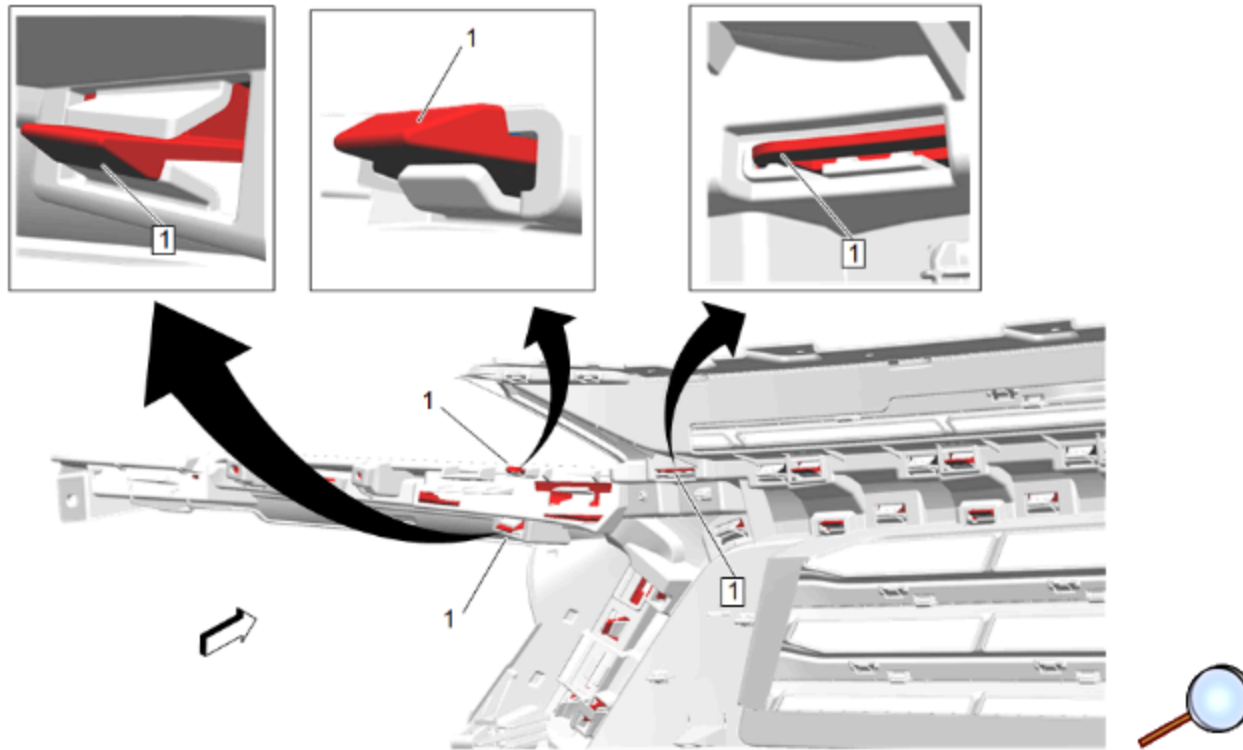

© 2024 General Motors. All rights reserved.

3. Carefully engage the three locking tabs (1).

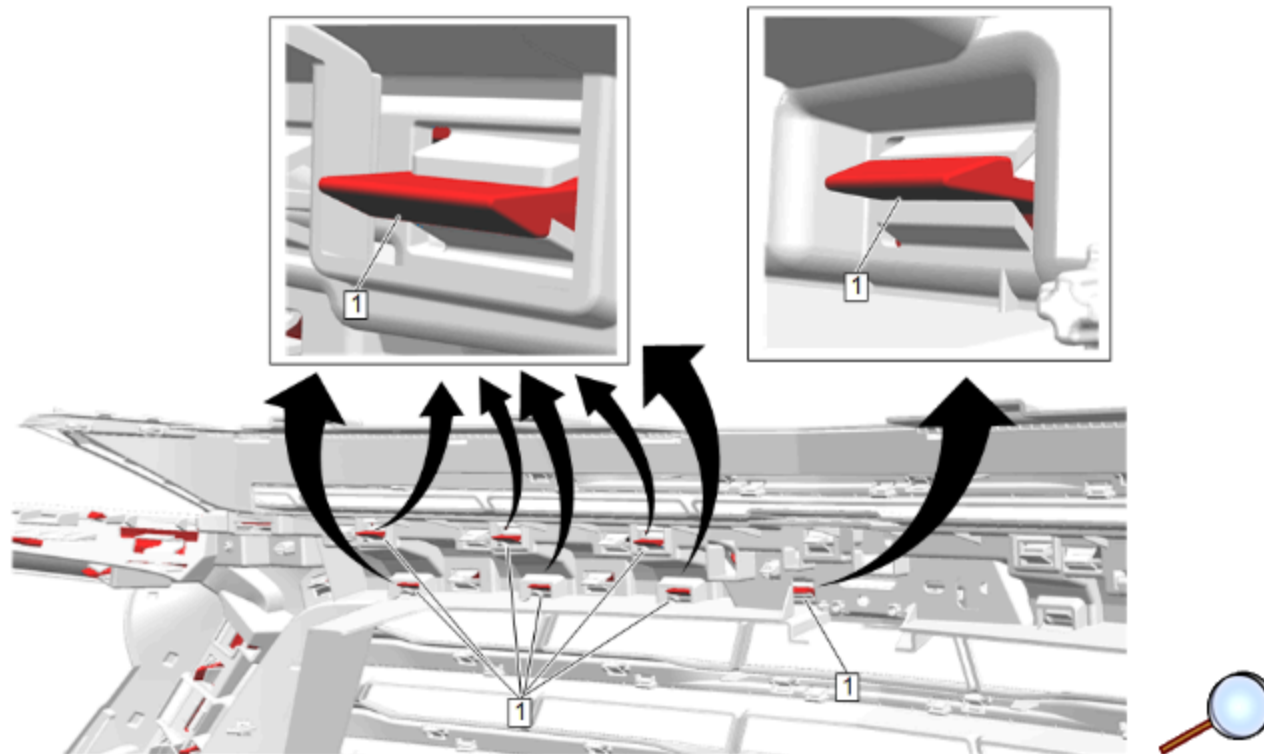

© 2024 General Motors. All rights reserved.

4. Carefully engage the seven locking tabs (1).

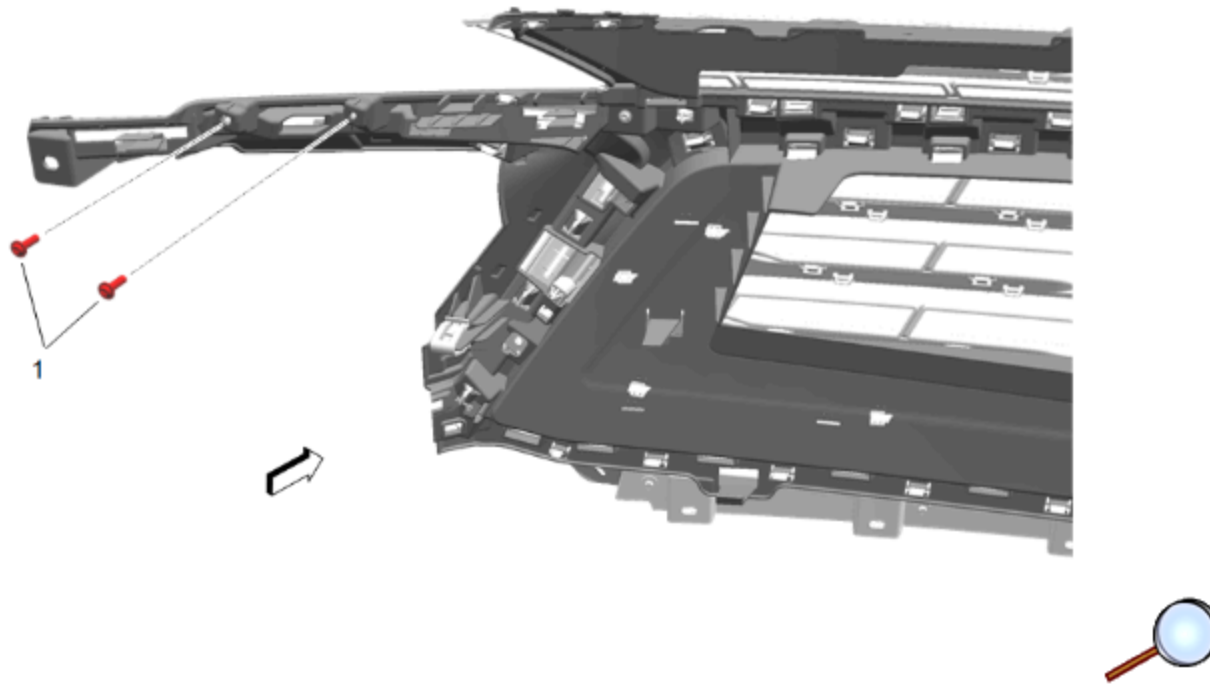

© 2024 General Motors. All rights reserved.

**Caution:** Use the correct fastener in the correct location. Replacement fasteners must be the correct part number for that application. Fasteners requiring replacement or fasteners requiring the use of thread locking compound or sealant are identified in the service procedure. Do not use paints, lubricants, or corrosion inhibitors on fasteners or fastener joint surfaces unless specified. These coatings affect fastener torque and joint clamping force and may damage the fastener. Use the correct tightening sequence and specifications when installing fasteners in order to avoid damage to parts and systems.

5. Install the upper (1) grille insert bolts. Tighten bolts to 2.5 N.m (22 lb in).
6. Repeat steps 1 thru 5 for opposite side.

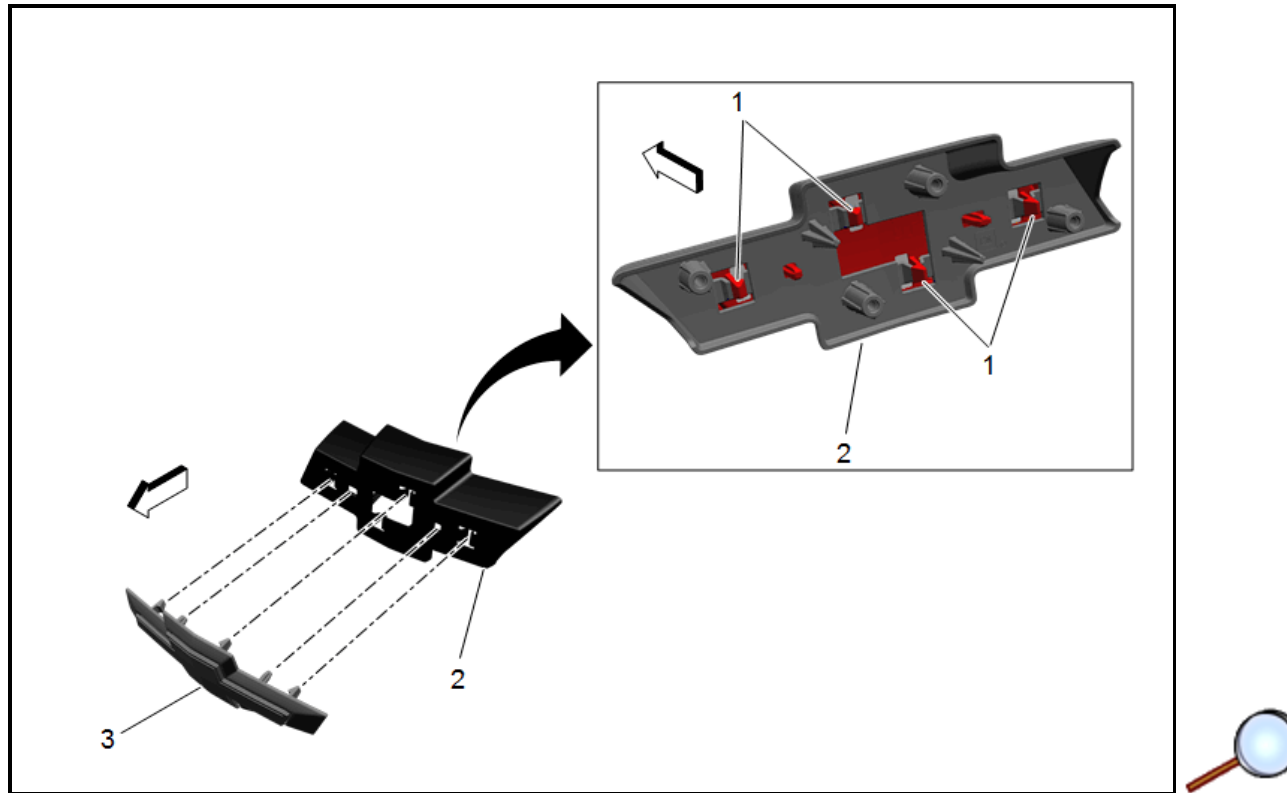

7. Install the bowtie emblem (3) to the grille insert emblem adaptor (2) engaging the retaining tabs (1).

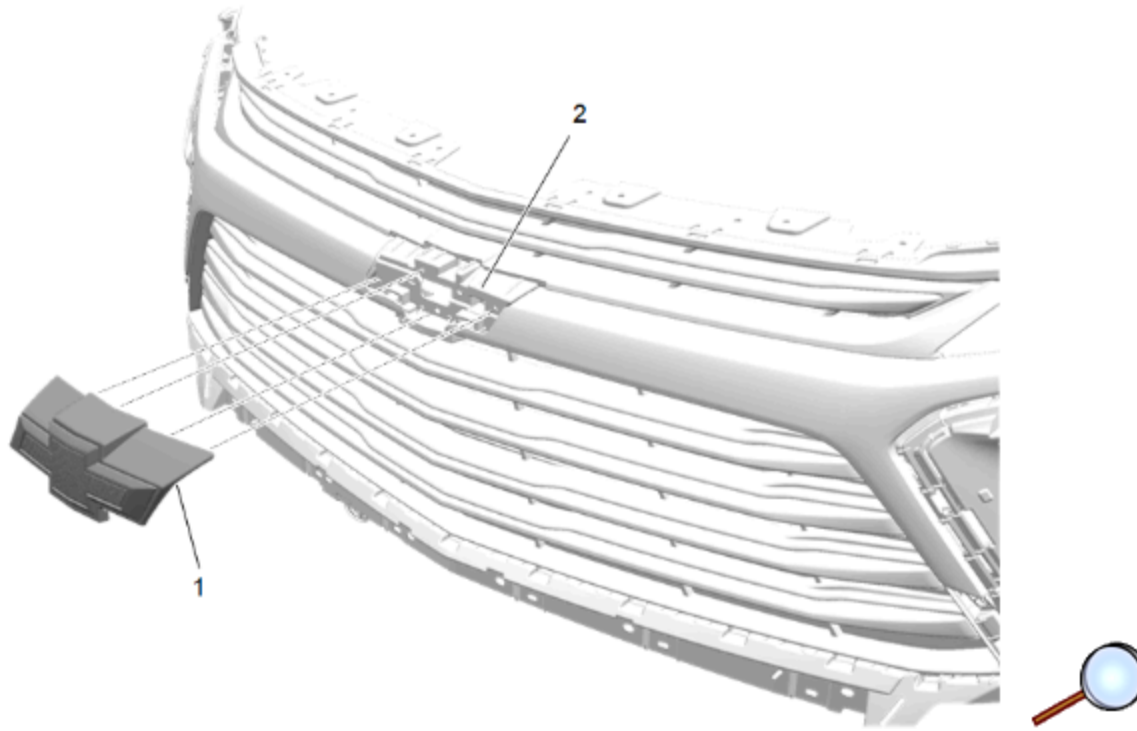

© 2024 General Motors. All rights reserved.

8. Install the front grille emblem and adapter (1) from front grille (2).

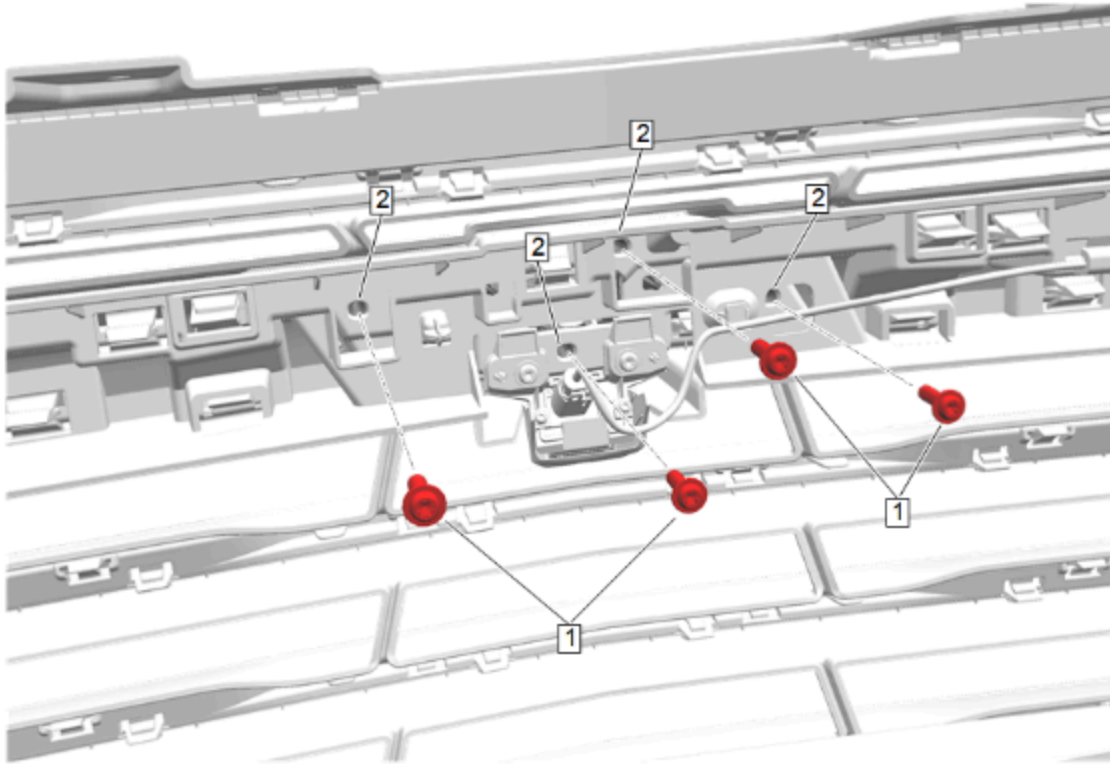

© 2024 General Motors. All rights reserved.

9. Install the front grille emblem adapter bolts (1) Qty: 4 to the front grille emblem adapter (2). Tighten the bolts to 2.5 N.m (22 lb in).
10. Assemble the grille from the front bumper fascia. Refer to [Front Grille Replacement](#) in Vehicle Service Manual.
11. Reinstall the front bumper fascia. Refer to [Front Bumper Fascia Removal and Installation](#) in Vehicle Service Manual.
12. Check and confirm operation of headlamps and fog lamps.